

Kit 1570

NISSAN Cube, 5-dr MPV, 08-

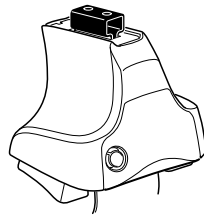

480R
754

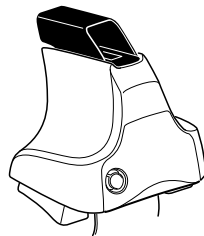
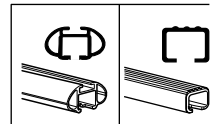

480

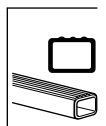

1

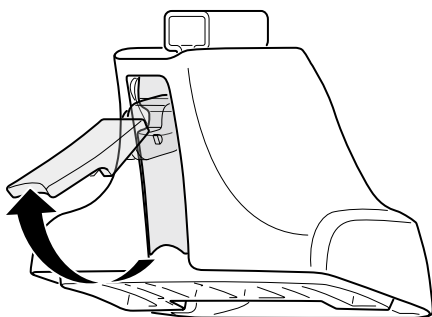
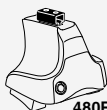

2

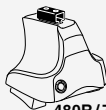

+

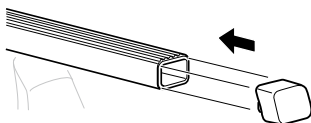
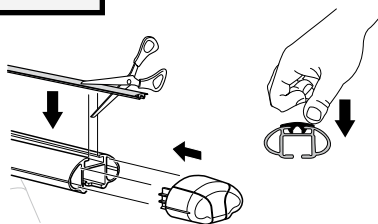
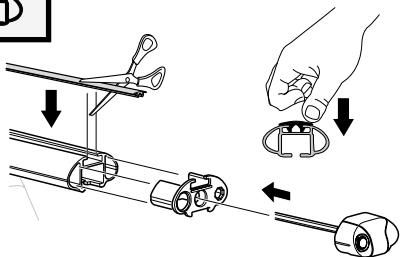
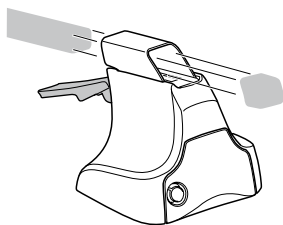
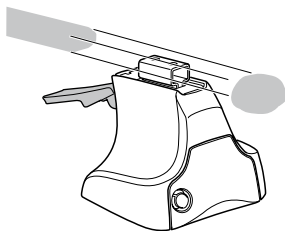

3

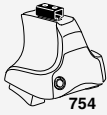

1

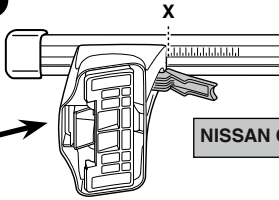
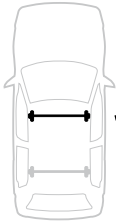

2

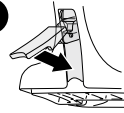

NISSAN Cube, 5-dr MPV, 08-

X

58

1

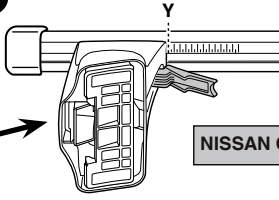

2

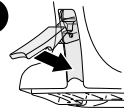

NISSAN Cube, 5-dr MPV, 08-

Y

53

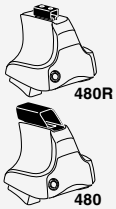

1

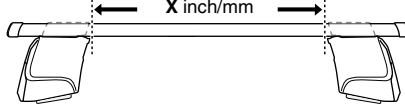
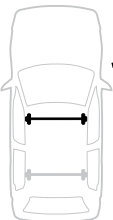

2

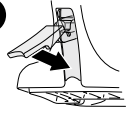

X inch

X mm

NISSAN Cube, 5-dr MPV, 08-

48 1/2"

1231 mm



1

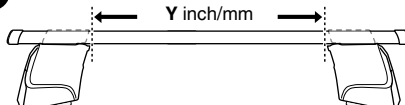

2

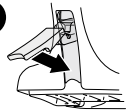

Y inch

Y mm

NISSAN Cube, 5-dr MPV, 08-

46 1/2"

1181 mm

4



480R/754



480

NISSAN Cube, 5-dr MPV, 08-

172



1079



FL



172



1079



FR



172



1080



RL



172



1080



RR

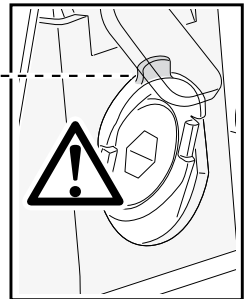
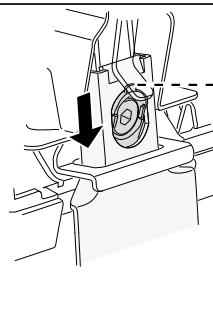
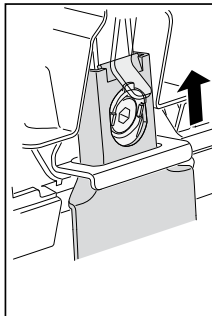
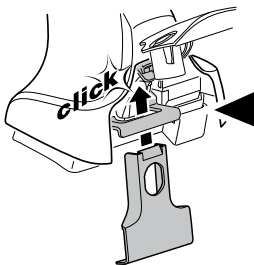
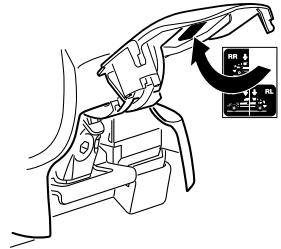
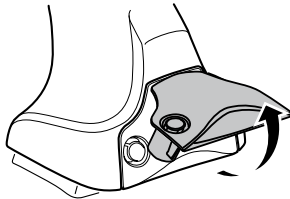
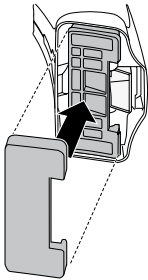

5

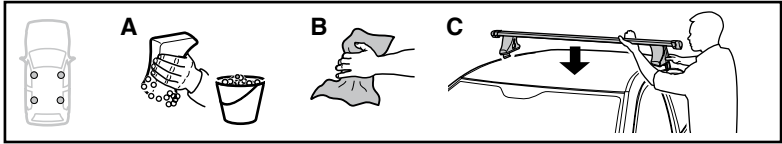

	X mm	Y mm	X inch	Y inch
NISSAN Cube, 5-dr MPV, 08-	720 mm	750 mm	28 ³ / ₈ "	29 ¹ / ₂ "

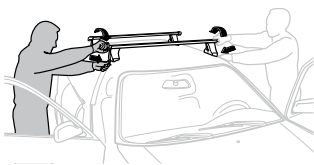
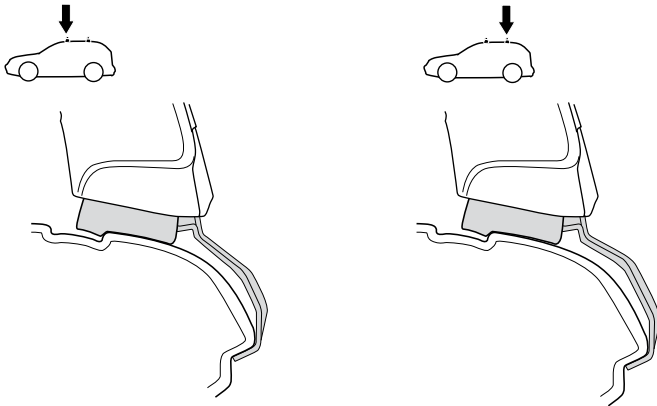
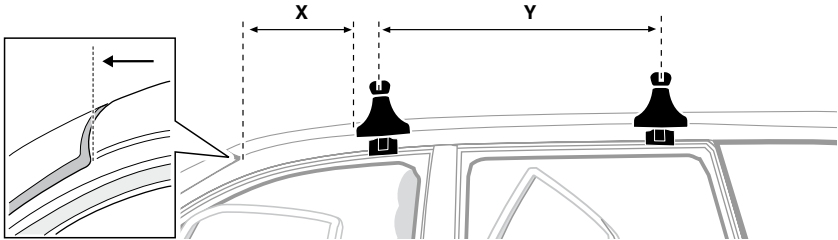

- | | | | |
|--------------|---|------------|---|
| GB/US | Tighten alternately | CZ | Pokřetla bagážníka dokřečaj dokřečaj napřezemennie. |
| D | Die Schrauben abwechselnd anziehen | SK | Dotahujte striedavo |
| F | Serrer alternativement chaque côté | SLO | Privijajte izmenično. |
| NL | Afwisselend aan de linker- en de rechterkant aandraaien | HR | Naizmjenično zategnite |
| I | Alternare il serraggio delle viti | HU | Egymástól függetlenül szorítandó |
| E | Apretar alternativamente | GR | Σφιγγετε εναλλάξ |
| PT | Apertar alternadamente | TR | Dönüşümlü sıkın |
| S | Dra åt växelvis | 中文 | 交替拧紧 |
| FIN | Kierrä vuorotellen | 한국어 | 번갈아 가며 조이십시오. |
| EST | Pinguldage vaheldumisi | 日本語 | 交互に締め付けてください。 |
| LAT | Pievelciēt pamišus | ไทย | ขันในแบบสลับ |
| LIT | Užsukinėkite pakaitomis | | |
| PL | Śruby dokręcaj naprzemiennie | | |
| RU | Затягивайте попеременно | | |

6

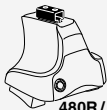

480R/754



480

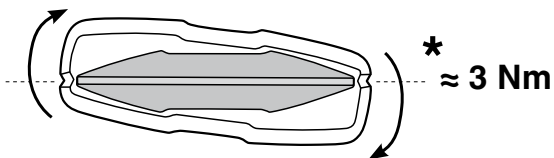
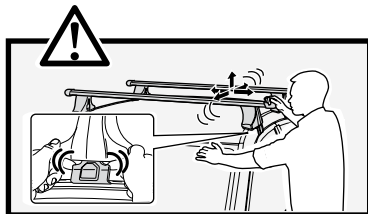
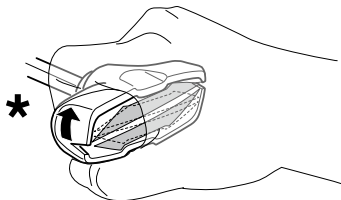
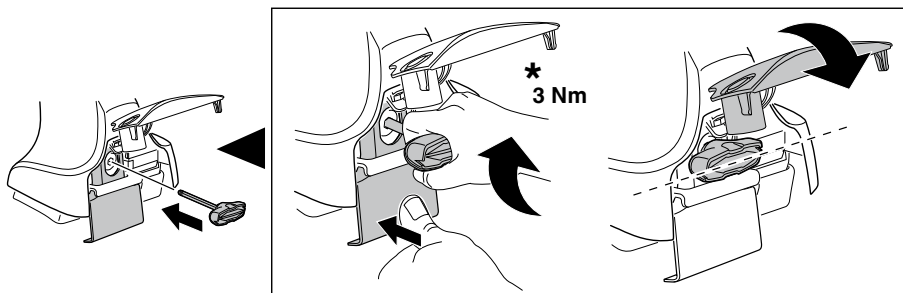

7

