

Kit 1586

PEUGEOT 206, 3-dr Hatchback, 98-08

PEUGEOT 206, 5-dr Hatchback, 98-08

PEUGEOT 206+, 3-dr Hatchback, 09-

PEUGEOT 206+, 5-dr Hatchback, 09-

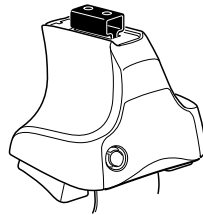

480R
754

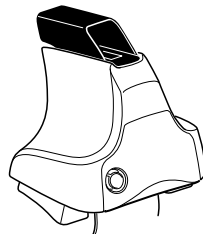
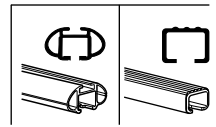

480

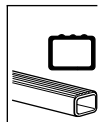

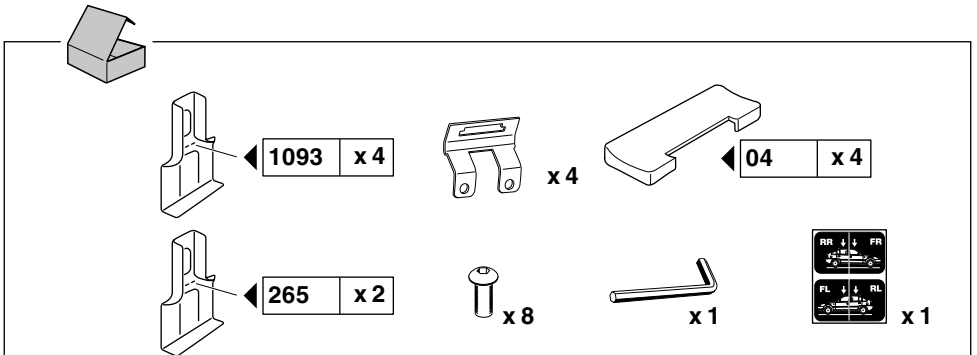
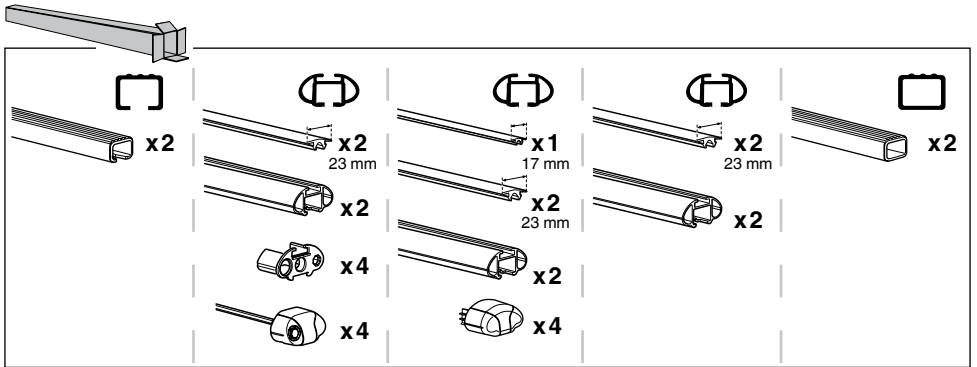
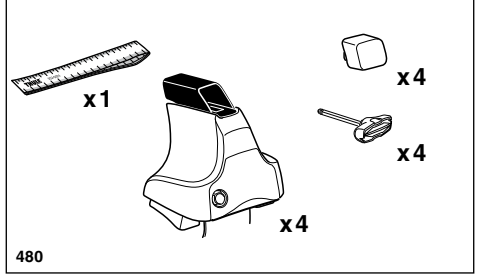
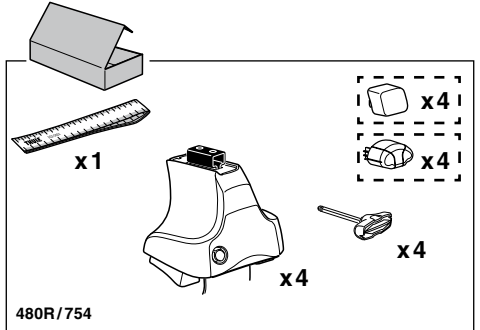
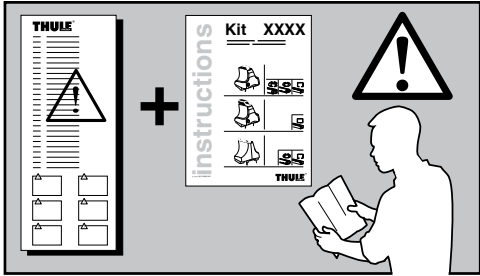
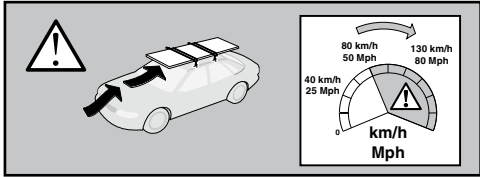
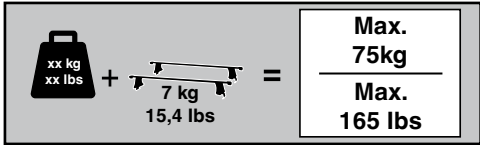

Kit

1

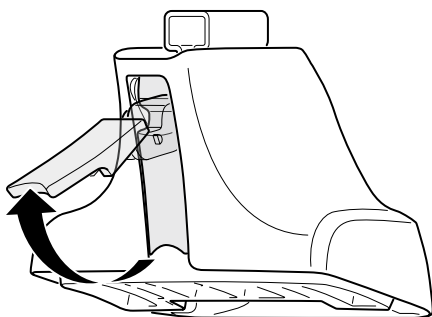
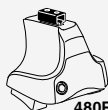

2

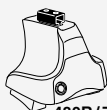

+

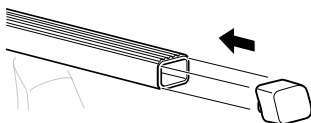
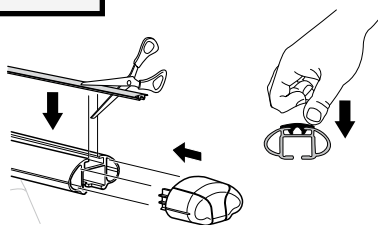
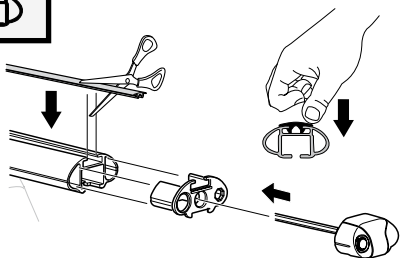
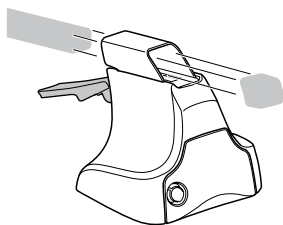
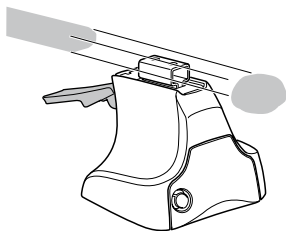

3

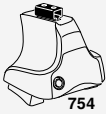

754

1

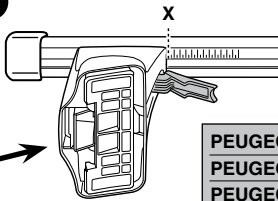
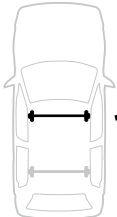

2

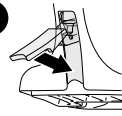

X

PEUGEOT 206, 3-dr Hatchback, 98-08	26
PEUGEOT 206, 5-dr Hatchback, 98-08	26
PEUGEOT 206+, 3-dr Hatchback, 09–	26
PEUGEOT 206+, 5-dr Hatchback, 09–	26

1

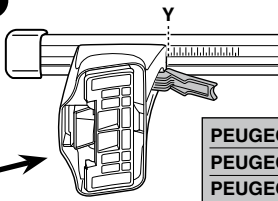
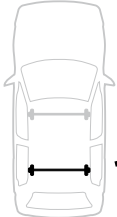

2

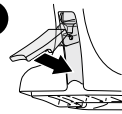

Y

PEUGEOT 206, 3-dr Hatchback, 98-08	26
PEUGEOT 206, 5-dr Hatchback, 98-08	24,5
PEUGEOT 206+, 3-dr Hatchback, 09–	26
PEUGEOT 206+, 5-dr Hatchback, 09–	24,5

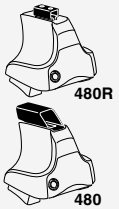

480R

480

1

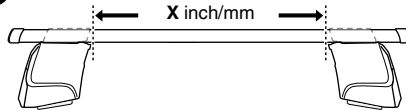

2

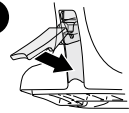

X inch X mm

PEUGEOT 206, 3-dr Hatchback, 98-08	35 $\frac{7}{8}$ "	911 mm
PEUGEOT 206, 5-dr Hatchback, 98-08	35 $\frac{7}{8}$ "	911 mm
PEUGEOT 206+, 3-dr Hatchback, 09–	35 $\frac{7}{8}$ "	911 mm
PEUGEOT 206+, 5-dr Hatchback, 09–	35 $\frac{7}{8}$ "	911 mm

1

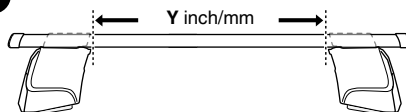

2

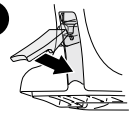

Y inch Y mm

PEUGEOT 206, 3-dr Hatchback, 98-08	35 $\frac{7}{8}$ "	911 mm
PEUGEOT 206, 5-dr Hatchback, 98-08	35 $\frac{1}{4}$ "	896 mm
PEUGEOT 206+, 3-dr Hatchback, 09–	35 $\frac{7}{8}$ "	911 mm
PEUGEOT 206+, 5-dr Hatchback, 09–	35 $\frac{1}{4}$ "	896 mm

4



480R/754



480

PEUGEOT 206, 3-dr Hatchback, 98-08
PEUGEOT 206+, 3-dr Hatchback, 09-



04



1093



FL ↓

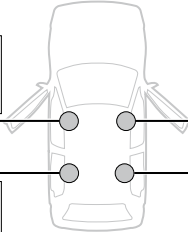

04



1093



FR ↓



04



265



RL ↓



04



265



RR ↓

PEUGEOT 206, 5-dr Hatchback, 98-08
PEUGEOT 206+, 5-dr Hatchback, 09-



04



1093



FL ↓

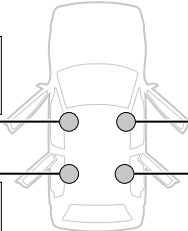

04



1093



FR ↓



04



1093



RL ↓



04



1093



RR ↓

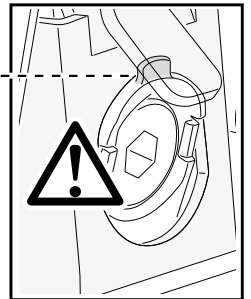
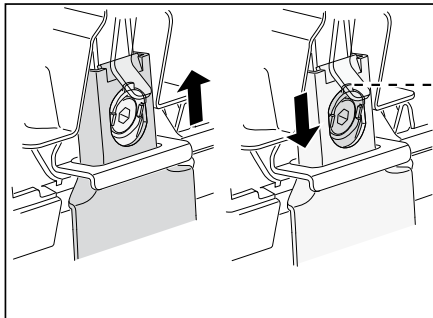
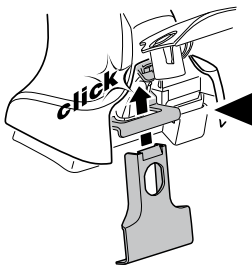
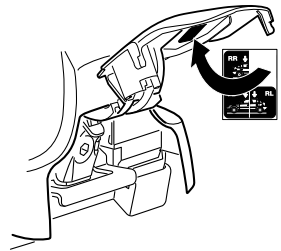
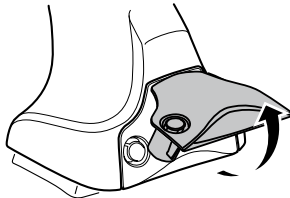
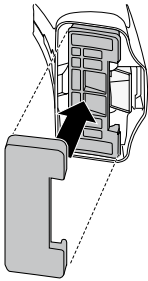

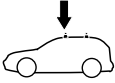
5

PEUGEOT 206, 3-dr Hatchback, 98-08
PEUGEOT 206+, 3-dr Hatchback, 09-

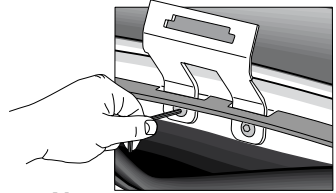
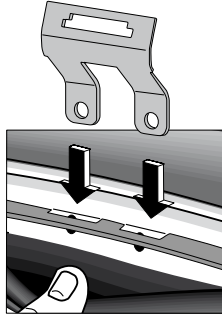
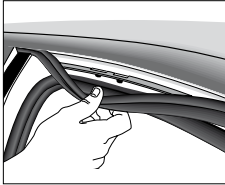
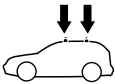
**x 2****x 4****x 1****6 Nm**

PEUGEOT 206, 5-dr Hatchback, 98-08
PEUGEOT 206+, 5-dr Hatchback, 09-

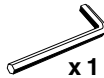
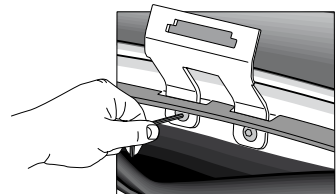
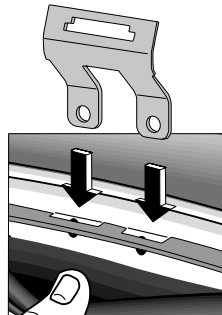
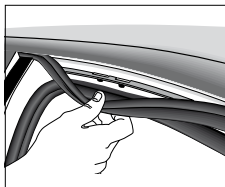
**x 4****x 8****x 1****6 Nm**

6

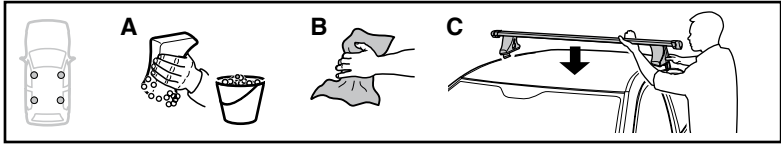

	X mm	Y mm	X inch	Y inch
PEUGEOT 206, 3-dr Hatchback, 98-08	250 mm	700 mm	9 7/8"	27 1/2"
PEUGEOT 206+, 3-dr Hatchback, 09-	250 mm	700 mm	9 7/8"	27 1/2"

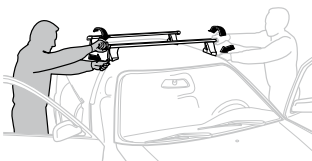
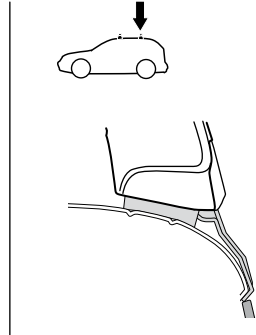
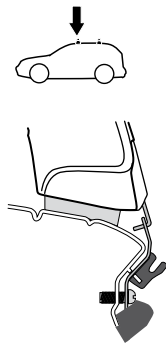
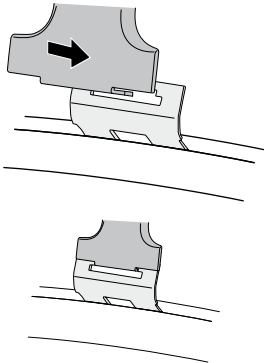
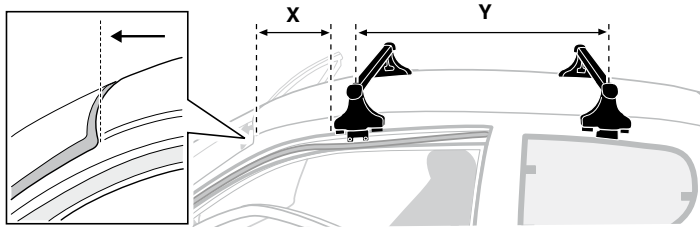

GB/US Tighten alternately
D Die Schrauben abwechselnd anziehen
F Serrer alternativement chaque côté
NL Afwisselend aan de linker- en de rechterkant aandraaien
I Alternare il serraggio delle viti
E Apretar alternativamente
PT Aperte alternadamente
S Dra åt växelvis
FIN Kierrä vuorotellen
EST Pinguldage vaheldumisi
LAT Pievelciēt pamāšus
LIT Užsukinkite pakaitomis
PL Śruby dokręcaj naprzemiennie
RU Затягивайте попеременно

CZ Pokręťta багаžníka dokręcaj dokręcaj naprzemiennie.
SK Doťahujte striedavo
SLO Privijajte izmenično.
HR Naizmjenično zategnite
HU Egymástól függetlenül szorítandó
GR Σφιγγετε εναλλάξ
TR Dönüşümlü sıkın

中文 交替拧紧

한국어 번갈아 가며 조이십시오.

日本語 交互に締め付けてください。

ไทย ชั้んในแบบสลับ

6

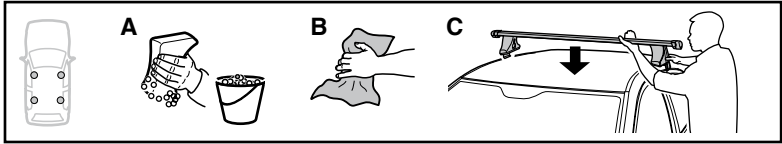

PEUGEOT 206, 5-dr Hatchback, 98-08
PEUGEOT 206+, 5-dr Hatchback, 09-

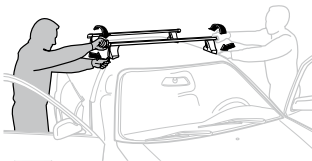
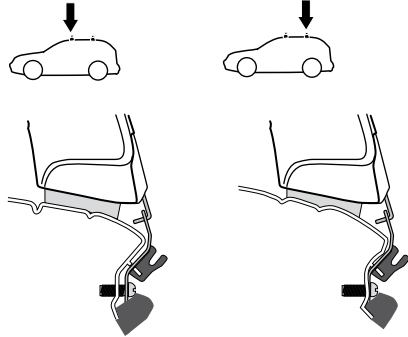
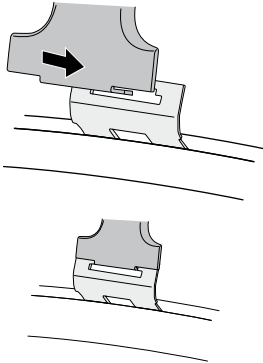
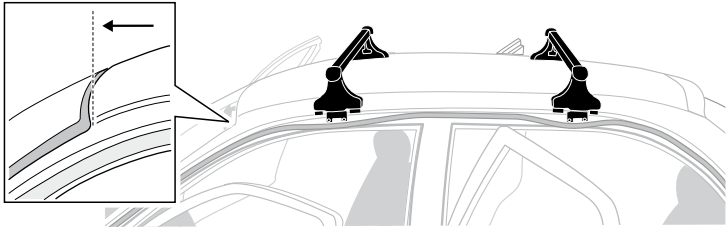

- | | | | |
|--------------|---------------------------------------------------------|------------|-----------------------------------------------------|
| GB/US | Tighten alternately | CZ | Pokřeřta багаჟnika dokřeřaj dokřeřaj napřezmiennie. |
| D | Die Schrauben abwechselnd anziehen | SK | Dofařujte striedavo |
| F | Serrer alternativement chaque côté | SLO | Privijařte izmenično. |
| NL | Afwisselend aan de linker- en de rechterkant aandraaien | HR | Naizmjenično zategnite |
| I | Alternare il serraggio delle viti | HU | Egymástól függetlenül szorítandó |
| E | Apretar alternativamente | GR | Σφιγείτε εναλλάξ |
| PT | Aperte alternadamente | TR | Dönüşümlü sıkın |
| S | Dra åt växelvis | 中文 | 交替拧紧 |
| FIN | Kierrä vuorotellen | 한국어 | 번갈아 가며 조이십시오. |
| EST | Pinguldage vaheldumisi | 日本語 | 交互に締め付けてください。 |
| LAT | Pievelciēt pamīšus | ไทย | ขันในแบบสลับ |
| LIT | Užsukinėkite pakaitomis | | |
| PL | Śruby dokręcaj naprzemiennie | | |
| RU | Затягивайте попеременно | | |

7

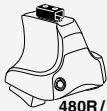

480R/754



480

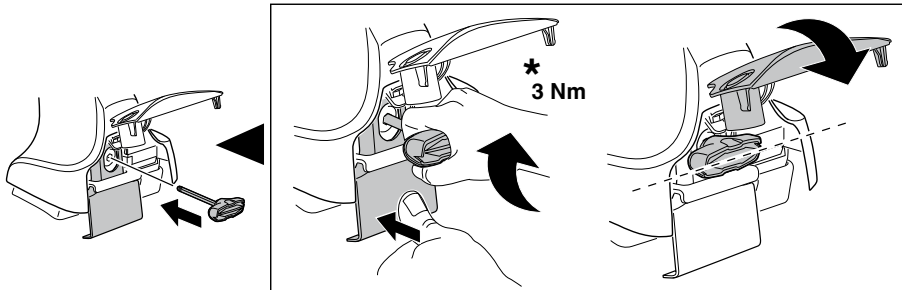

* 3 Nm

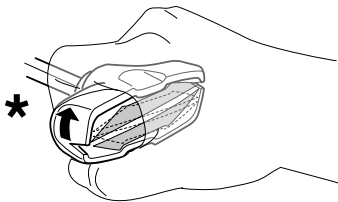

*

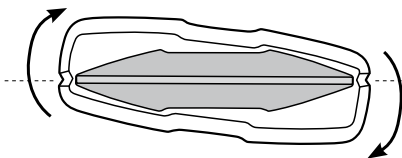
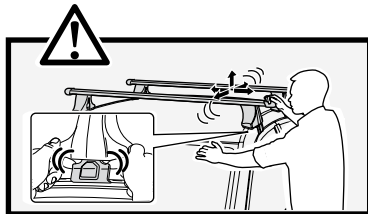

* ≈ 3 Nm

8

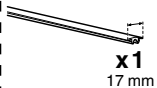

x1
17 mm

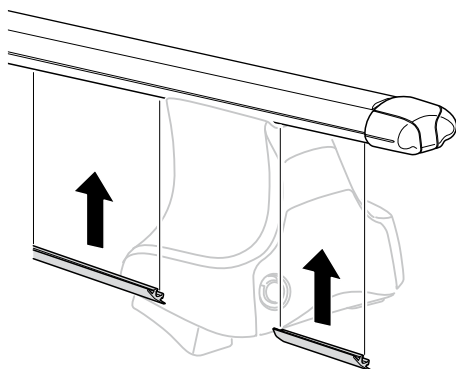

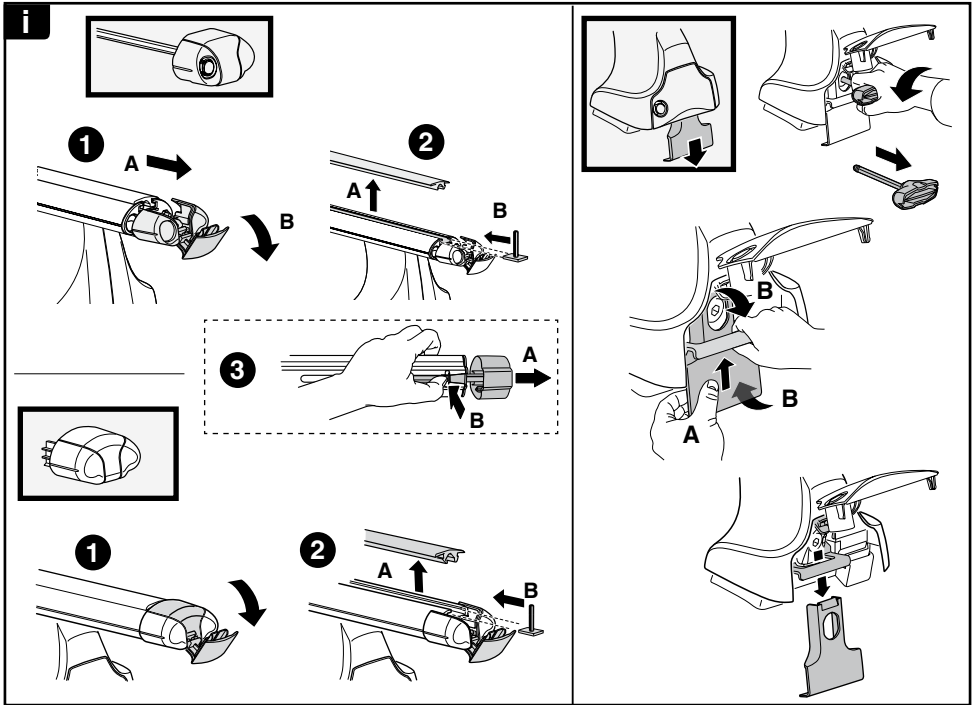
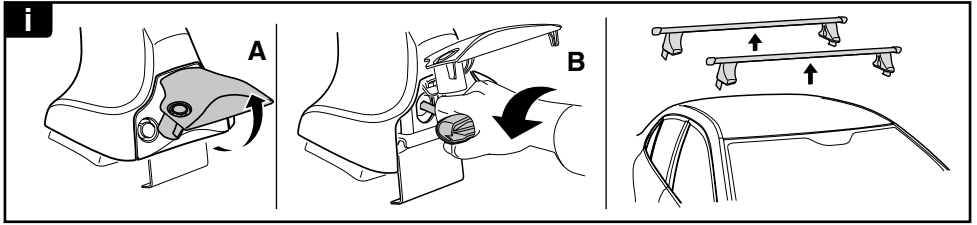

THULE
SWEDEN
**ONE
KEY
SYSTEM**

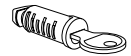
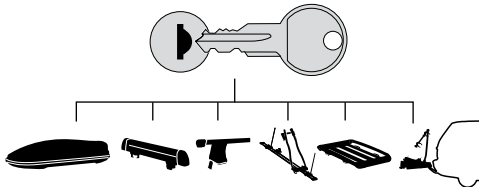

544 (x4)

596 (x6)

588 (x8)

NA **510** (x10)

EUR **452** (x12)

ASIA **452** (x12)

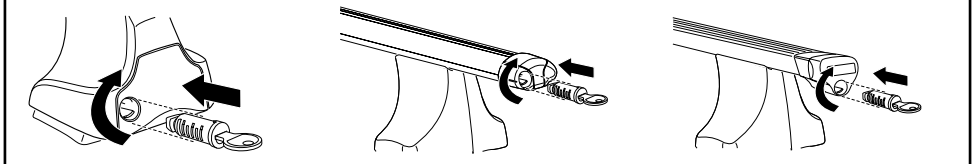

WW ▶ Thule Sweden AB, Box 69, 330 33 Hillerstorp, SWEDEN
NA ▶ Thule Inc., 42 Silvermine Road, Seymour, Connecticut 06483, USA

info@thule.com
customer.service@thule.com

www.thule.com

503-1586