

Kit 1107

DAEWOO Lanos, 4-dr Sedan, 97-03

DAEWOO Lanos, 5-dr Hatchback, 97-03

DAEWOO Lanos, 3-dr Hatchback, 98-03

DAEWOO Leganza, 4-dr Sedan, 97-02

DAEWOO Nubira, 4-dr Sedan, 97-99

DAEWOO Nubira II, 4-dr Sedan, 00-02

480R
754

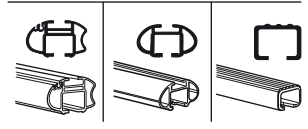
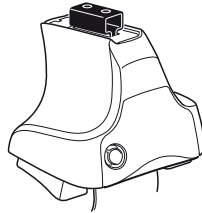

480

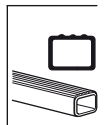
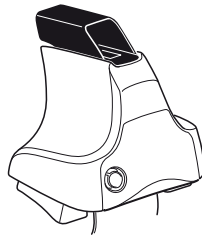

750

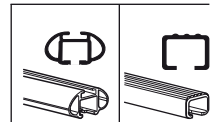
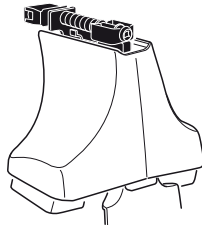

xx kg
 xx lbs + 7 kg / 15,4 lbs = **Max. 75kg**
 3 kg / 6,6 lbs = **Max. 165 lbs**

80 km/h 50 Mph
 130 km/h 80 Mph
 40 km/h 25 Mph
km/h Mph

THULE + **Kit XXXX**

x1 x4 x4 x4 x4
480R/754

x1 x4 x4 x4
480

x1 x4 x4
750

x2	x2	x2	x2	x2
x2	x2	x2	x2	x2
x2	x2	x4	x4	x2
x4		x4		

115 x4
204 x2
03 x4
x1

Kit



3

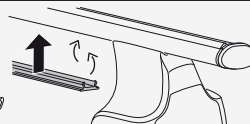
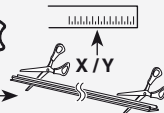
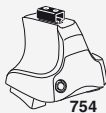

1

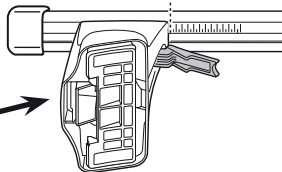
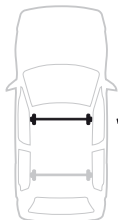

2

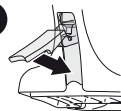

	X
DAEWOO Lanos, 4-dr Sedan, 97-03	22,5
DAEWOO Lanos, 5-dr Hatchback, 97-03	22,5
DAEWOO Lanos, 3-dr Hatchback, 98-03	23
DAEWOO Leganza, 4-dr Sedan, 97-02	32
DAEWOO Nubira, 4-dr Sedan, 97-99	27,5
DAEWOO Nubira II, 4-dr Sedan, 00-02	27,5

1

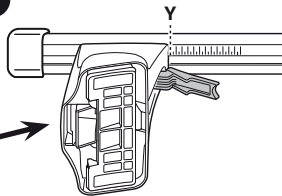

2

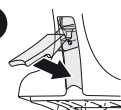

	Y
DAEWOO Lanos, 4-dr Sedan, 97-03	22
DAEWOO Lanos, 5-dr Hatchback, 97-03	22
DAEWOO Lanos, 3-dr Hatchback, 98-03	21,5
DAEWOO Leganza, 4-dr Sedan, 97-02	29
DAEWOO Nubira, 4-dr Sedan, 97-99	26,5
DAEWOO Nubira II, 4-dr Sedan, 00-02	26,5

3



480R



480

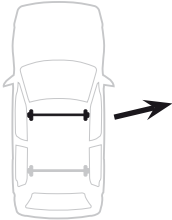
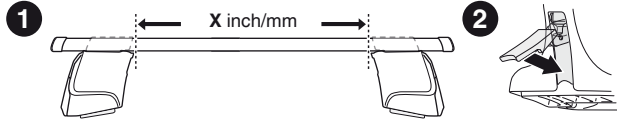

	X inch	X mm
DAEWOO Lanos, 4-dr Sedan, 97-03	34 1/2"	876 mm
DAEWOO Lanos, 5-dr Hatchback, 97-03	34 1/2"	876 mm
DAEWOO Lanos, 3-dr Hatchback, 98-03	34 5/8"	881 mm
DAEWOO Leganza, 4-dr Sedan, 97-02	38 1/4"	971 mm
DAEWOO Nubira, 4-dr Sedan, 97-99	36 1/2"	926 mm
DAEWOO Nubira II, 4-dr Sedan, 00-02	36 1/2"	926 mm

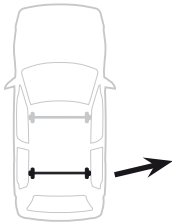
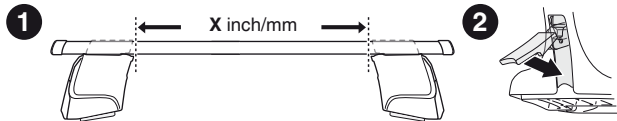

	Y inch	Y mm
DAEWOO Lanos, 4-dr Sedan, 97-03	34 1/4"	871 mm
DAEWOO Lanos, 5-dr Hatchback, 97-03	34 1/4"	871 mm
DAEWOO Lanos, 3-dr Hatchback, 98-03	34 1/8"	866 mm
DAEWOO Leganza, 4-dr Sedan, 97-02	37"	941 mm
DAEWOO Nubira, 4-dr Sedan, 97-99	36 1/8"	916 mm
DAEWOO Nubira II, 4-dr Sedan, 00-02	36 1/8"	916 mm

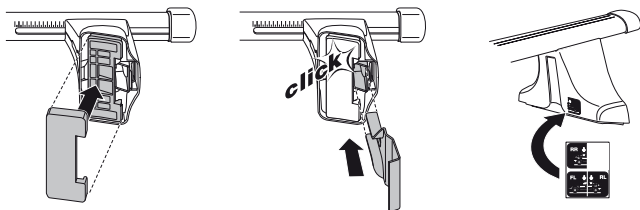
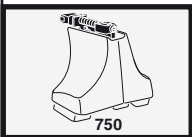
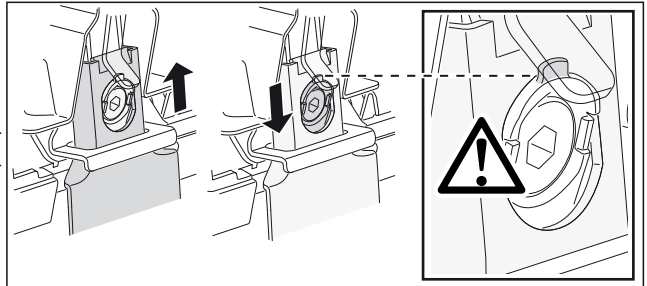
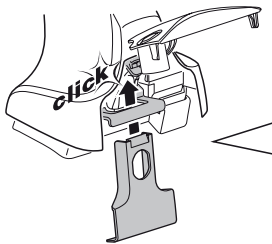
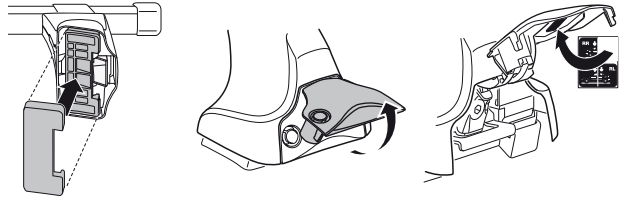
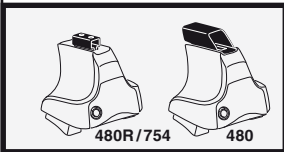
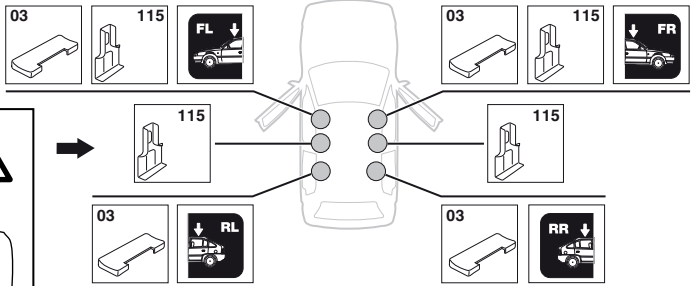
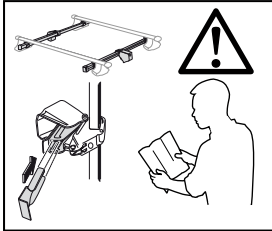
4**DAEWOO Lanos, 3-dr Hatchback, 98-03****SRA**

4

DAEWOO Lanos, 4-dr Sedan, 97-03
DAEWOO Lanos, 5-dr Hatchback, 97-03
DAEWOO Nubira, 4-dr Sedan, 97-99
DAEWOO Nubira II, 4-dr Sedan, 00-02

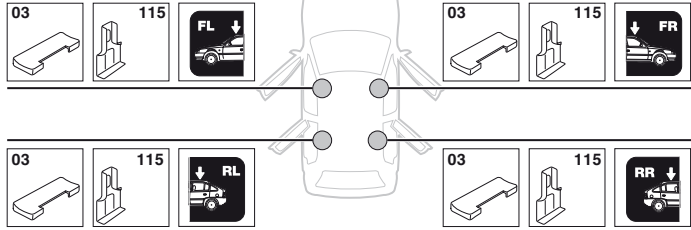

DAEWOO Leganza, 4-dr Sedan, 97-02

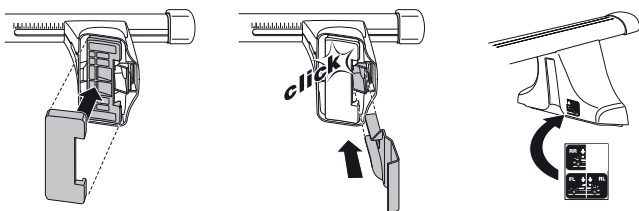
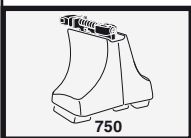
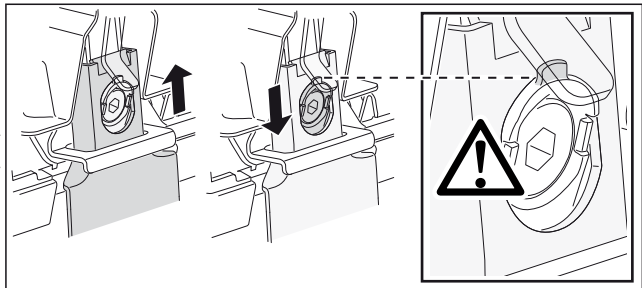
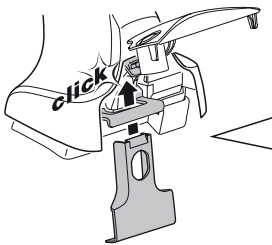
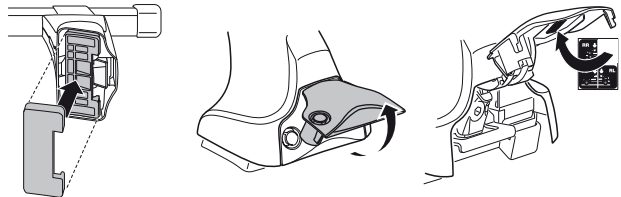
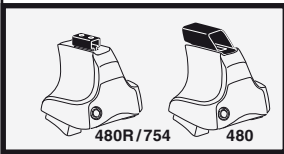
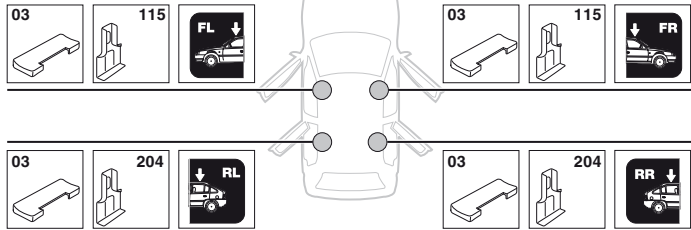

5

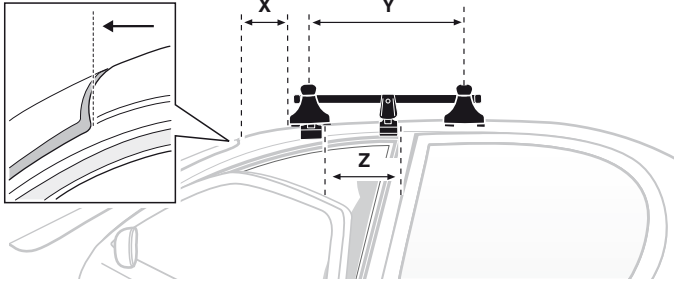
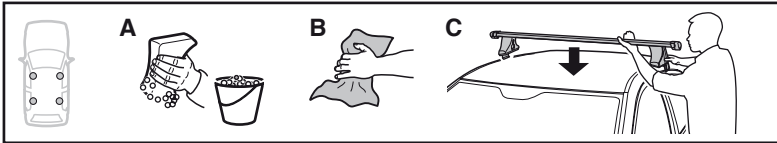

	X mm	Y mm	Z mm	X inch	Y inch	X inch
DAEWOO Lanos, 3-dr Hatchback, 98-03	190 mm	700 mm	360 mm	7 1/2"	27 1/2"	14 1/8"

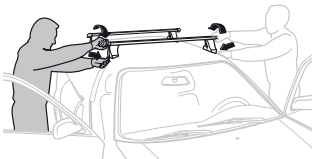
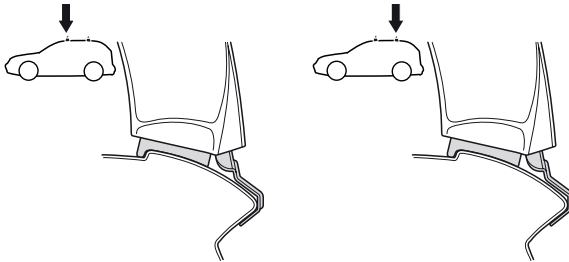

GB/US Tighten alternately
D Die Schrauben abwechselnd anziehen
F Serrer alternativement chaque côté
NL Afwisselend aan de linker- en de rechterkant aandraaien
I Alternare il serraggio delle viti
E Apretar alternativamente
PT Aperte alternadamente
S Dra åt växelvis
FIN Kierrä vuorotellen
EST Pinguldage vaheldumisi
LAT Pielvelciēt pamišus
LIT Užsukinėkite pakaitomis
PL Śruby dokręcaj naprzemiennie
RU Затягивайте попеременно

CZ Pokręťta bagażnika dokręcaj dokręcaj naprzemiennie.
SK Dotahujte striedavo
SLO Privijajte izmenično.
HR Naizmjenično zategnite
HU Egymástól függetlenül szorítandó
GR Σφιγγετε εναλλάξ
TR Dönüşümlü sıkın

中文 交替拧紧

한국어 번갈아 가며 조이십시오.

日本語 交互に締め付けてください。

ไทย ชับในแบบสลับ

5

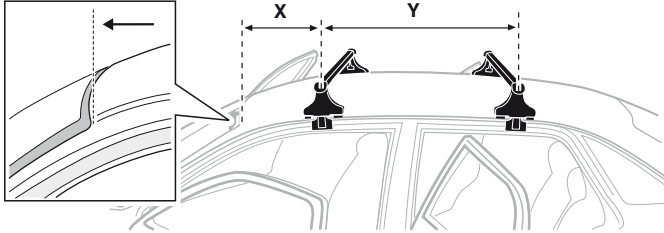
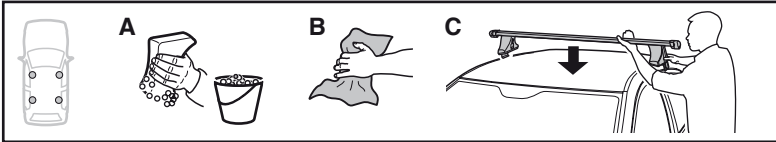

	X mm	Y mm	X inch	Y inch
DAEWOO Lanos, 4-dr Sedan, 97-03	200 mm	600 mm	7 7/8"	23 5/8"
DAEWOO Lanos, 5-dr Hatchback, 97-03	200 mm	550 mm	7 7/8"	21 5/8"
DAEWOO Leganza, 4-dr Sedan, 97-02	200 mm	650 mm	7 7/8"	25 5/8"
DAEWOO Nubira, 4-dr Sedan, 97-99	180 mm	650 mm	7 1/8"	25 5/8"
DAEWOO Nubira II, 4-dr Sedan, 00-02	180 mm	650 mm	7 1/8"	25 5/8"

DAEWOO Lanos, 4-dr Sedan, 97-03
DAEWOO Lanos, 5-dr Hatchback, 97-03
DAEWOO Nubira, 4-dr Sedan, 97-99
DAEWOO Nubira II, 4-dr Sedan, 00-02

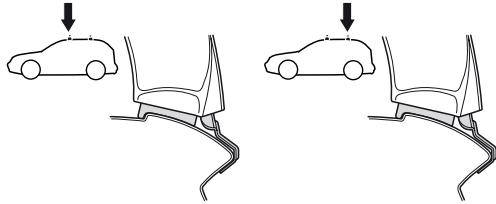

DAEWOO Leganza, 4-dr Sedan, 97-02

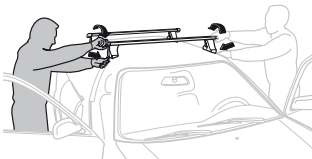
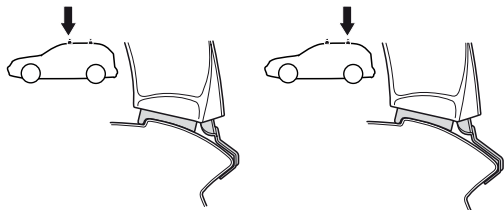

GB/US Tighten alternately
D Die Schrauben abwechselnd anziehen
F Serrer alternativement chaque côté
NL Afwisselend aan de linker- en de rechterkant aandraaien
I Alternare il serraggio delle viti
E Apretar alternativamente
PT Aperte alternadamente
S Dra åt växelvis
FIN Kierrä vuorotellen
EST Pinguldage vaheldumisi
LAT Pievelciēt pamišus
LIT Užsukinėkite pakaitomis
PL Śruby dokręcaj naprzemiennie
RU Затягивайте попеременно

CZ Pokręťta bagazníka dokręcaj dokręcaj naprzemiennie.
SK Dofahujte striedavo
SLO Privijajte izmenično.
HR Naizmjerno zategnite
HU Egyarástól fűggetlenül szorítandó
GR Σφιγίγτε εναλλάξ
TR Dönüşümlü sıkın

中文 交替拧紧
한국어 번갈아 가며 조이십시오.
日本語 交互に締め付けてください。
ไทย ขึ้นในแบบสลับ

6



480R/754



480

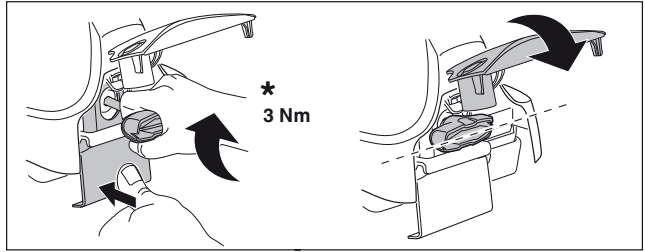
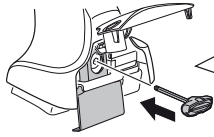

*
3 Nm

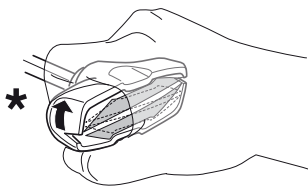

*

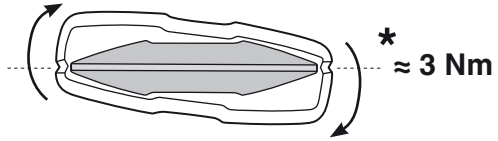

*
≈ 3 Nm

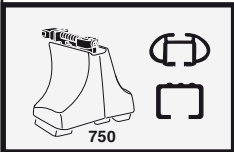
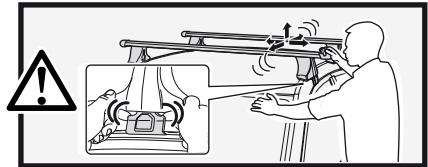

750

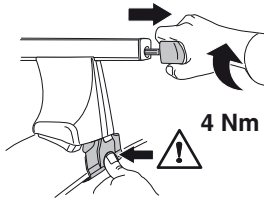

4 Nm

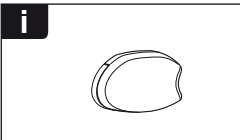
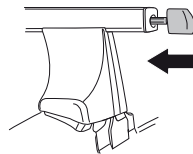

i

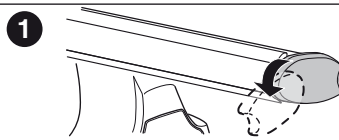

1

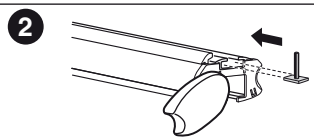

2

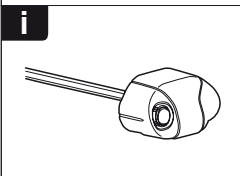

i

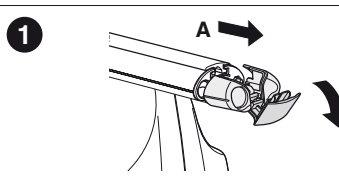

1

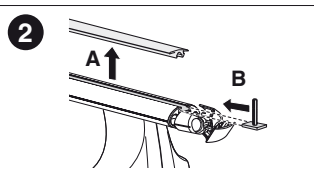

2

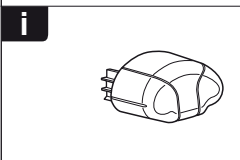

i

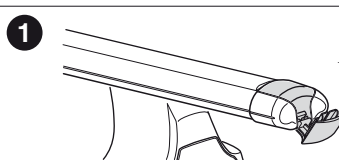

1

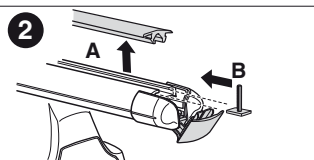

2

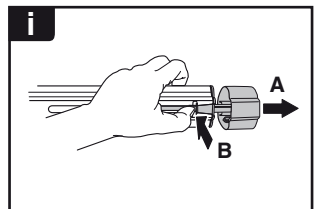
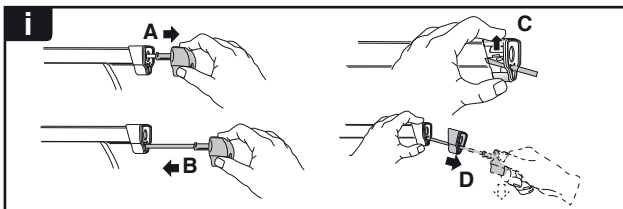
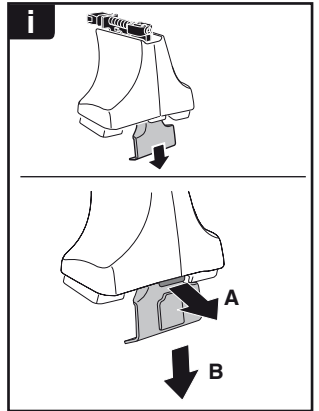
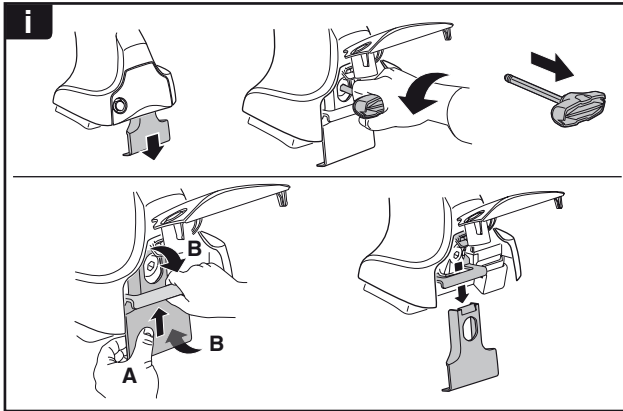
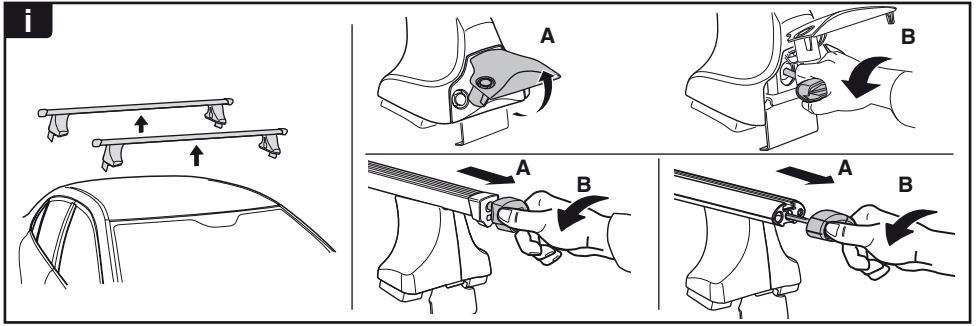

THULE
SWEDEN
**ONE
KEY
SYSTEM**

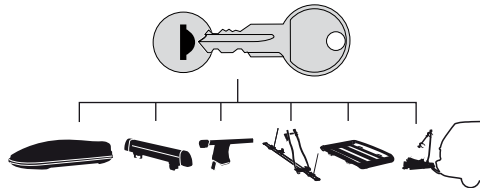

- 544 (x4)
- 596 (x6)
- 588 (x8)
- NA 510 (x10)
- EUR 452 (x12)
- ASIA

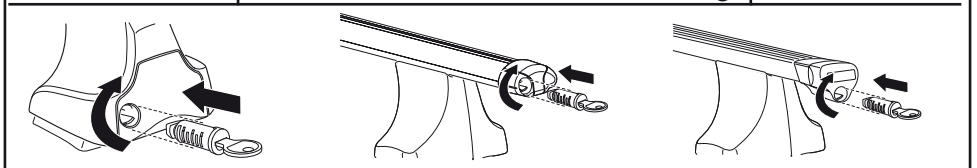

WW ▶ Thule Sweden AB, Box 69, 330 33 Hillerstorp, SWEDEN
NA ▶ Thule Inc., 42 Silvermine Road, Seymour, Connecticut 06483, USA

info@thule.com
customer.service@thule.com

www.thule.com