

Kit 1619

NISSAN Juke, 5-dr SUV, 10-

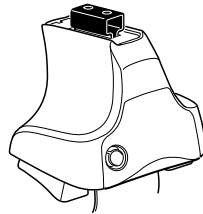

754 Rapid System
480R Rapid Traverse (North America)

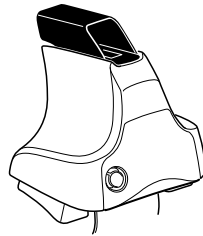
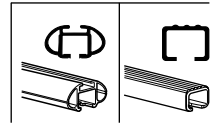

480 Traverse (North America)

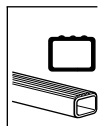

754 Rapid System
 480R Rapid Traverse (North America)

754 Rapid System
 480R Rapid Traverse (North America)

480 Traverse (North America)

(North America)

1126 x2
 1127 x2
 180 x2
 350 x2
 x1

1

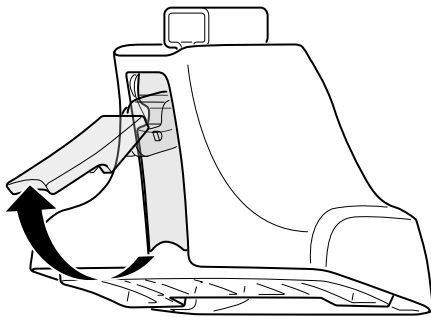

2



754 Rapid System
480R Rapid Traverse
(North America)

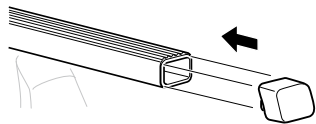
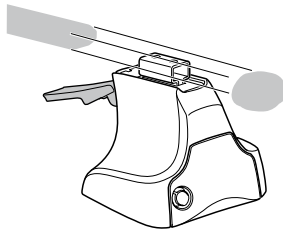

x4

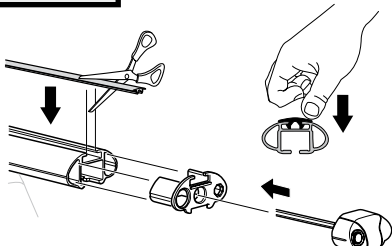
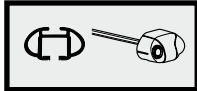

x4

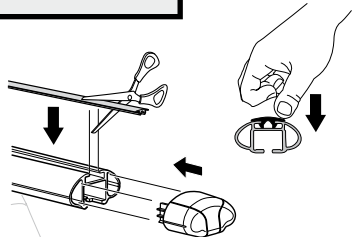
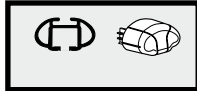

x4

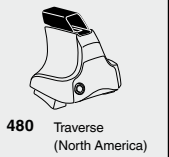

480 Traverse
(North America)

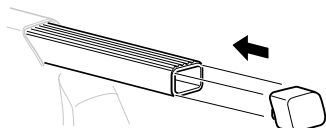
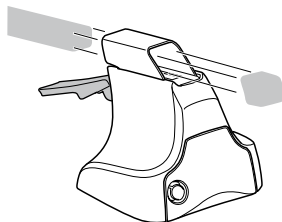

x4

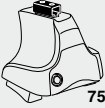
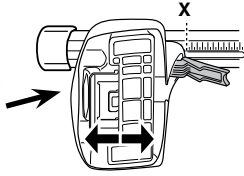
3**754** Rapid System

	X
NISSAN Juke, 5-dr SUV, 10-	33

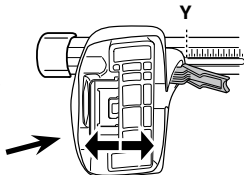

	Y
NISSAN Juke, 5-dr SUV, 10-	31

3**480R** Rapid Traverse**480** Traverse**(North America)**

	X inch	X mm
NISSAN Juke, 5-dr SUV, 10-	38 ⁵/₈"	980 mm

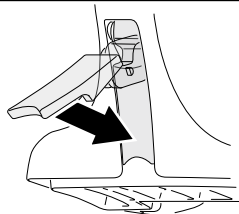

	Y inch	Y mm
NISSAN Juke, 5-dr SUV, 10-	37 ⁷/₈"	960 mm

4

5

NISSAN Juke, 5-dr SUV, 10-

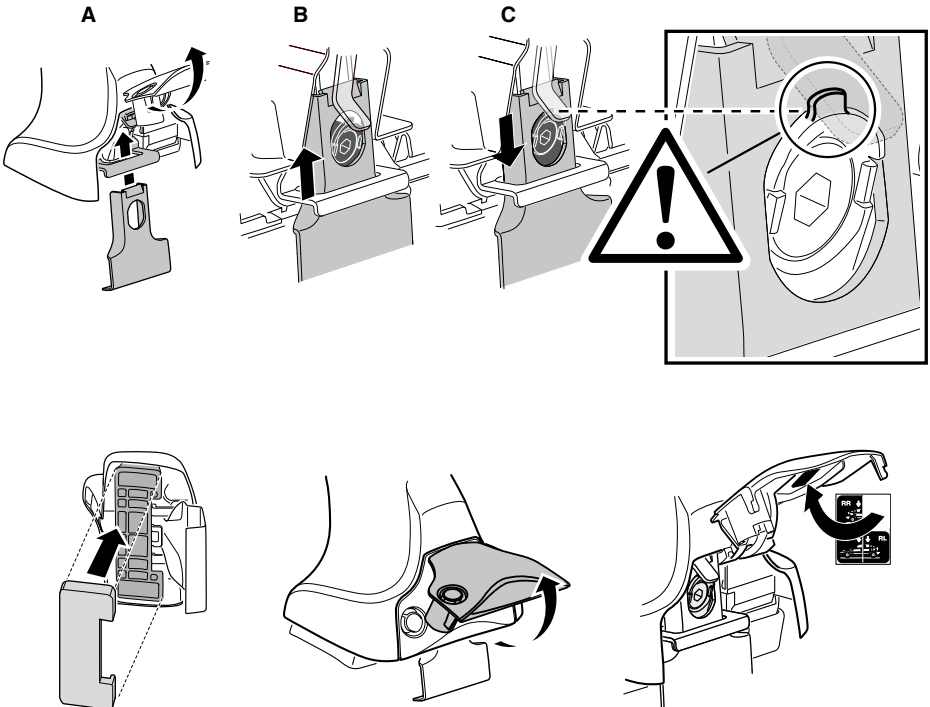
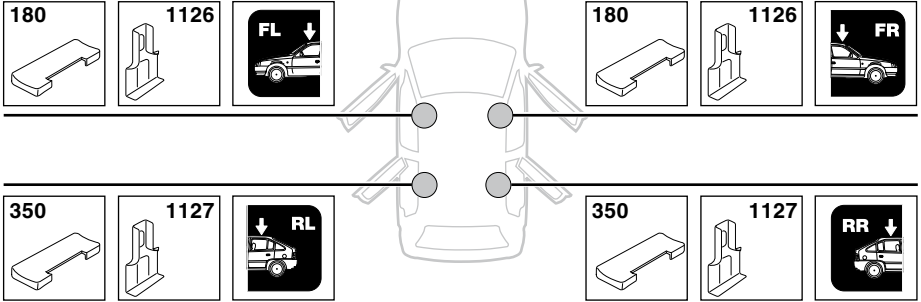

6

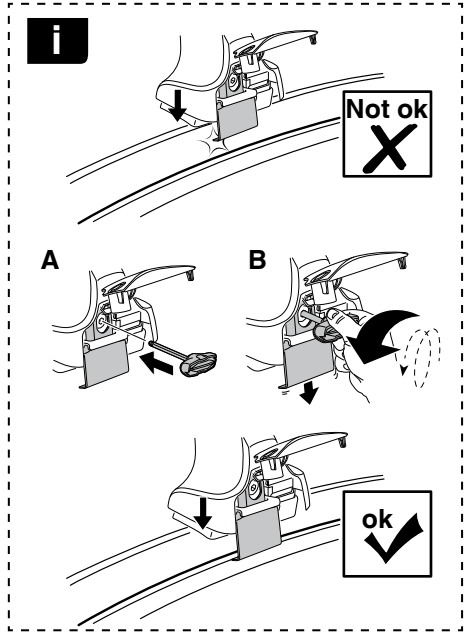
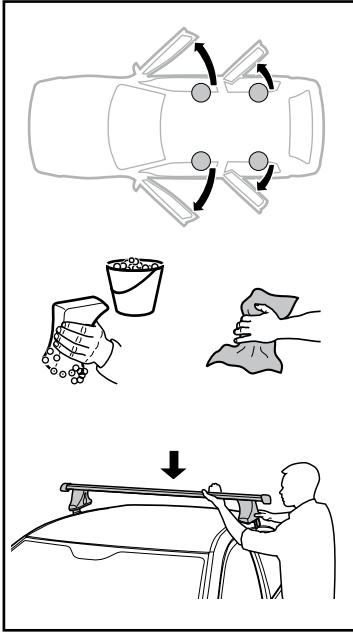

NISSAN Juke, 5-dr SUV, 10-

X mm	Y mm	X inch	Y inch
330 mm	650 mm	13"	25 5/8"

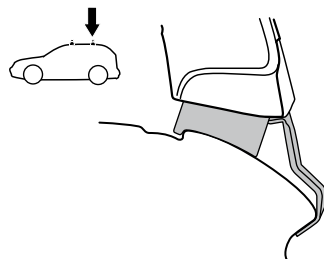
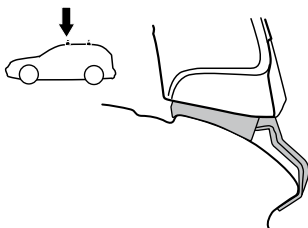
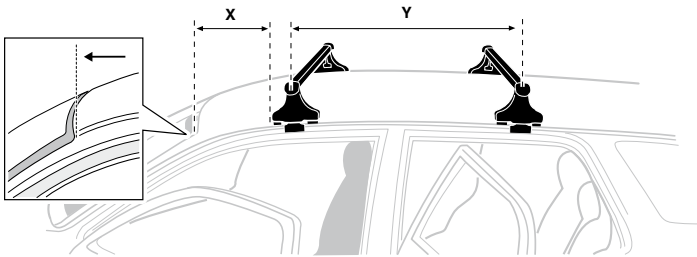

7

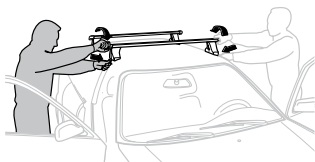

GB/US	Tighten alternately
D	Die Schrauben abwechselnd anziehen
F	Serrer alternativement chaque côté
NL	Afwisselend aan de linker- en de rechterkant aandraaien
I	Alternare il serraggio delle viti
E	Apertar alternativamente
PT	Aperte alternadamente
S	Dra åt växelvis
FIN	Kierrä vuorotellen
EST	Pinguldage vaheldumisi
LAT	Pielveiciet pamišus
LIT	Užsukinėkite pakaitomis
PL	Śruby dokręcaj naprzemiennie
RU	Загряивайте попеременно

CZ	Pokręřta багаžnika dokręcaj naprzemiennie.
SK	Dofahajte striedavo
SLO	Privijajte izmenično.
HR	Naizmjenočno zategnite
HU	Egymástól függetlenül szorítandó
GR	Σφιγγετε εναλλάξ
TR	Dönüşümlü sıkın

中文 交替拧紧

한국어 번갈아 가며 조이십시오.

日本語 交互に締め付けてください。

ไทย ชันในแบบสลับ

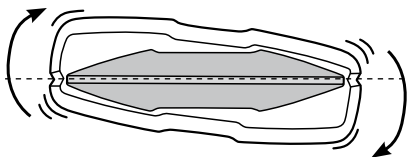
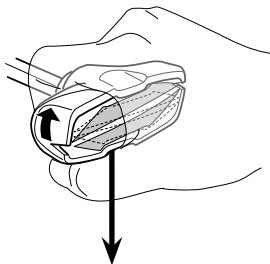
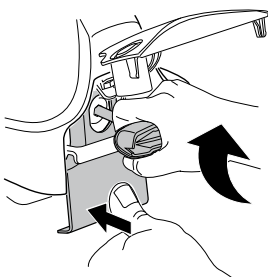
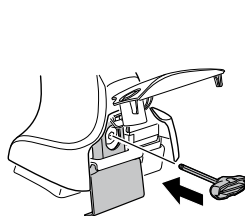

≈ 3 Nm

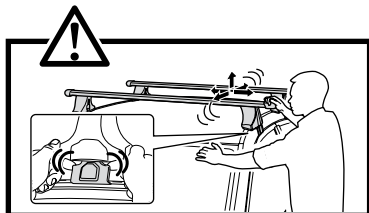
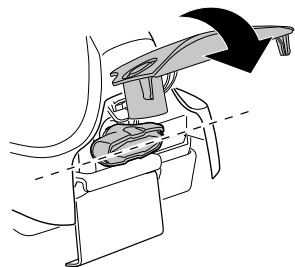

8





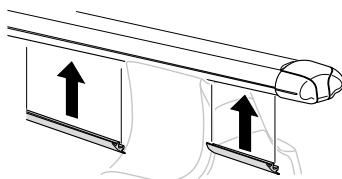

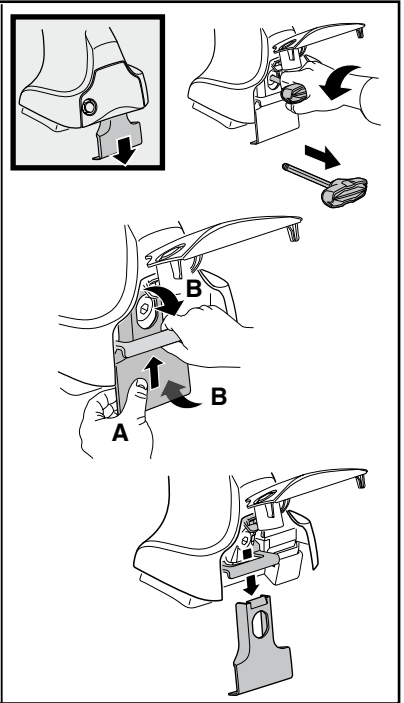
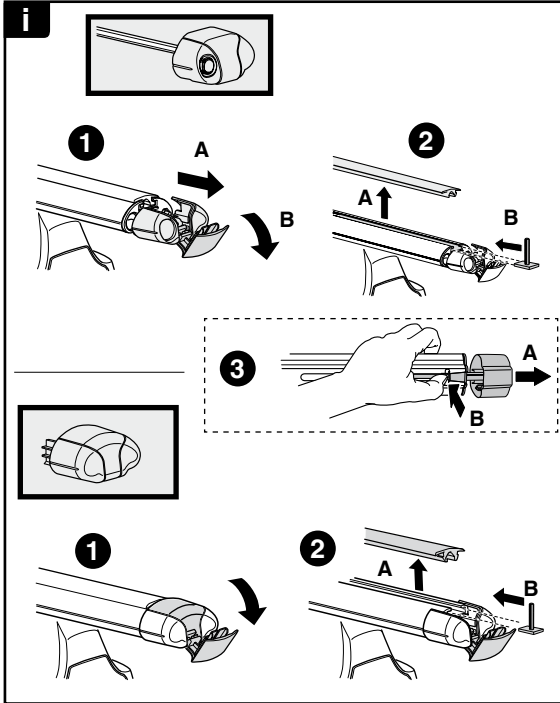
x1
17 mm



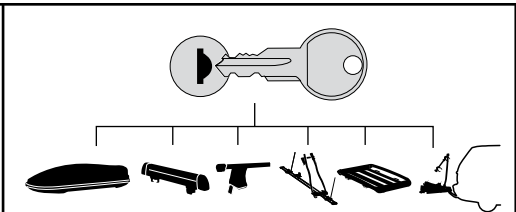

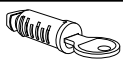
THULE
SWEDEN
**ONE
KEY
SYSTEM**



-  **544** (x4)
 -  **596** (x6)
 -  **588** (x8)
 -  **510** (x10)
 -  **452** (x12)
- NA
EUR
ASIA

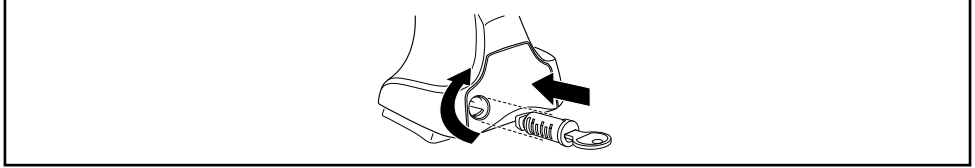

WW ▶ Thule Sweden AB, Box 69, 330 33 Hillerstorp, SWEDEN
NA ▶ Thule Inc., 42 Silvermine Road, Seymour, Connecticut 06483, USA

info@thule.com
customer.service@thule.com

 www.thule.com