

Kit 1618

VOLKSWAGEN Jetta VI, 4-dr Sedan, 10-
VOLKSWAGEN Jetta VI, 4-dr Sedan, *11-

*North America

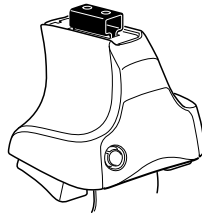

754 Rapid System
480R Rapid Traverse (North America)

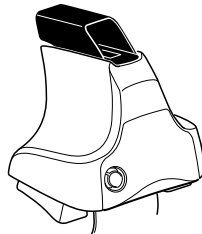

480 Traverse (North America)

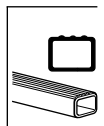

754 Rapid System
480R Rapid Traverse (North America)

754 Rapid System
480R Rapid Traverse (North America)

480 Traverse (North America)

x2	x2	x1	x2	x2	x2
	23 mm	17 mm	23 mm		
	x2	x2	x2	x2	
x4	x4	x4	x4		

(North America)

1135	1137	1149	204	206
x1	x1	x2	x1	x1
			340	341
			x1	x1
			x2	x2
			50993	
			x4	
			x1	

1

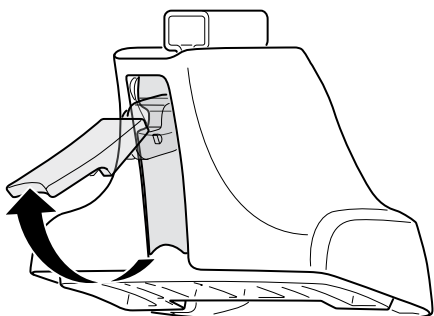

2



754 Rapid System
480R Rapid Traverse
(North America)

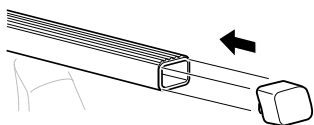
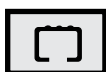
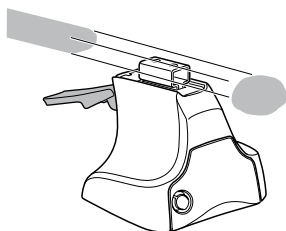

x4

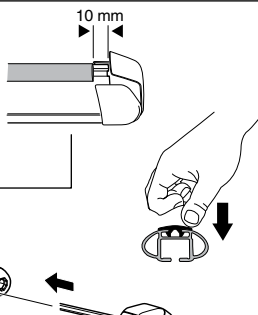
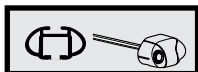

x4

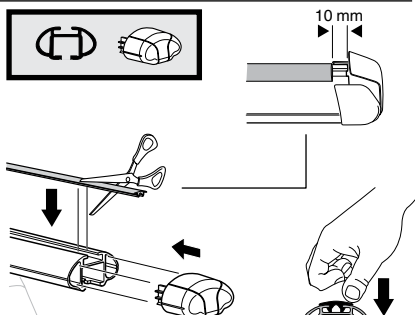
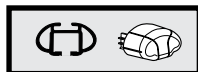

x4



480 Traverse
(North America)

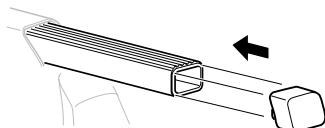
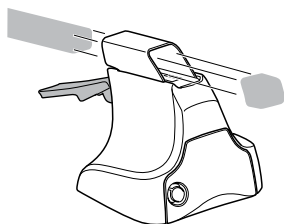

x4

3

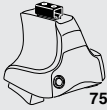

754 Rapid System

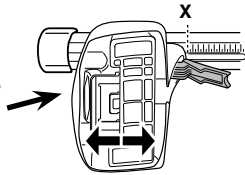

X

VOLKSWAGEN Jetta VI, 4-dr Sedan, 10-	35
VOLKSWAGEN Jetta VI, 4-dr Sedan, *11-	35

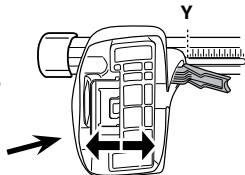

Y

VOLKSWAGEN Jetta VI, 4-dr Sedan, 10-	31,5
VOLKSWAGEN Jetta VI, 4-dr Sedan, *11-	30,5

3

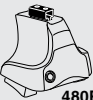

480R Rapid Traverse



480 Traverse

(North America)

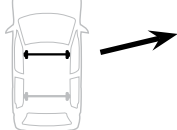

X inch **X mm**

VOLKSWAGEN Jetta VI, 4-dr Sedan, 10-	39 ³/₈ "	1001 mm
VOLKSWAGEN Jetta VI, 4-dr Sedan, *11-	39 ³/₈ "	1001 mm

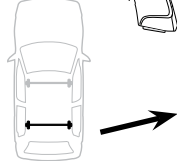

Y inch **Y mm**

VOLKSWAGEN Jetta VI, 4-dr Sedan, 10-	38 "	966 mm
VOLKSWAGEN Jetta VI, 4-dr Sedan, *11-	37 ⁵/₈ "	956 mm

4

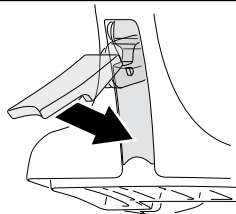

5

VOLKSWAGEN Jetta VI, 4-dr Sedan, 10-
VOLKSWAGEN Jetta VI, 4-dr Sedan, *11-

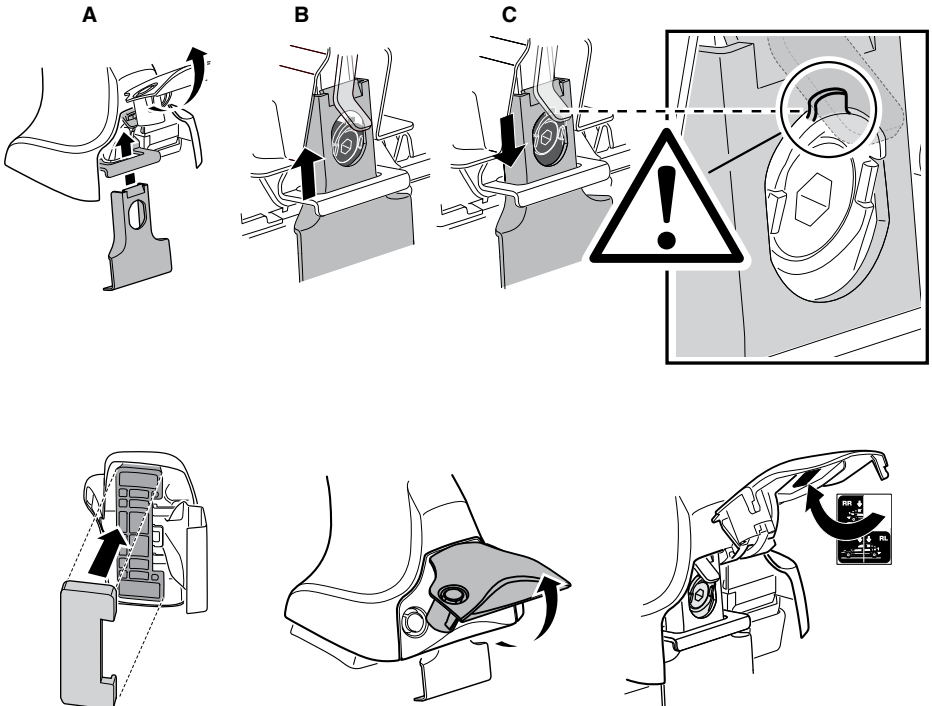
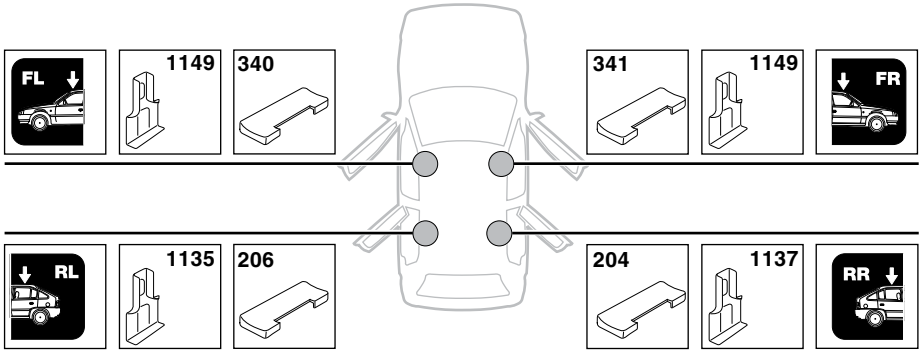

6

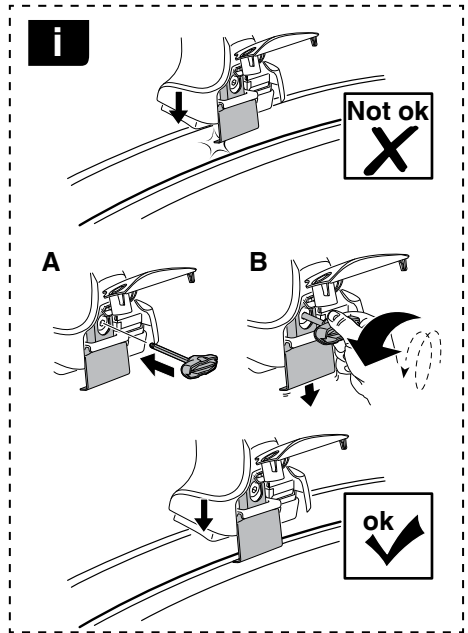
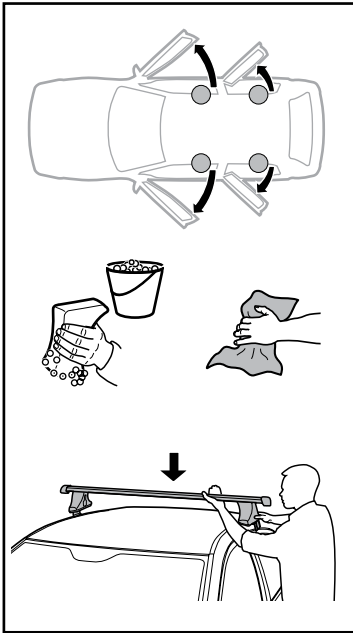

	X mm	Y mm	X inch	Y inch
VOLKSWAGEN Jetta VI, 4-dr Sedan, 10-	254 mm	790 mm	10"	31 1/8"
VOLKSWAGEN Jetta VI, 4-dr Sedan, *11-	254 mm	790 mm	10"	31 1/8"

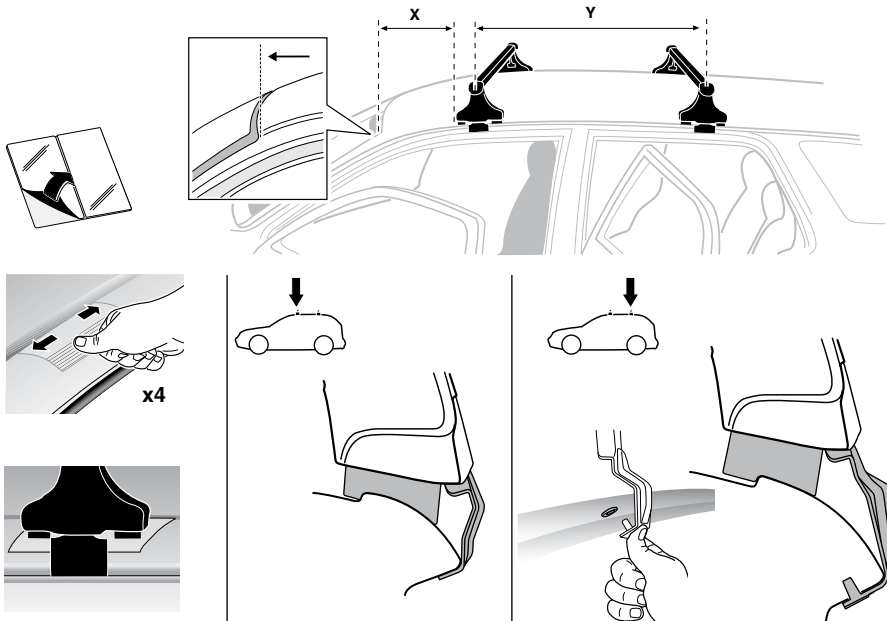

7

 x 4

VOLKSWAGEN Jetta VI, 4-dr Sedan, 10-/*11-

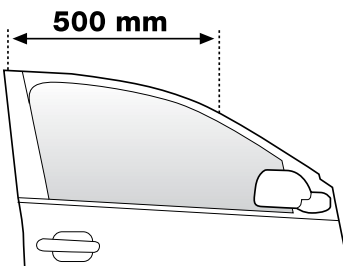
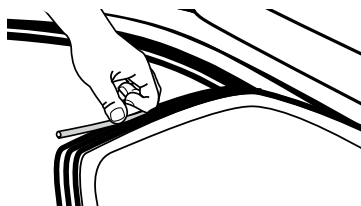
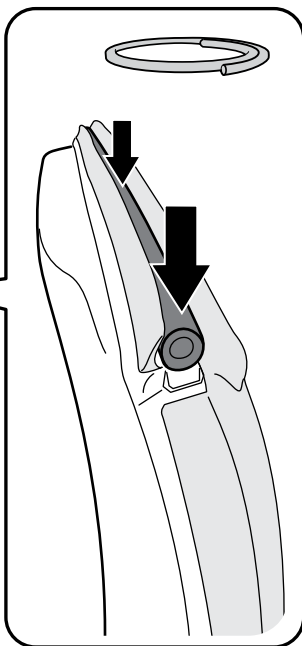
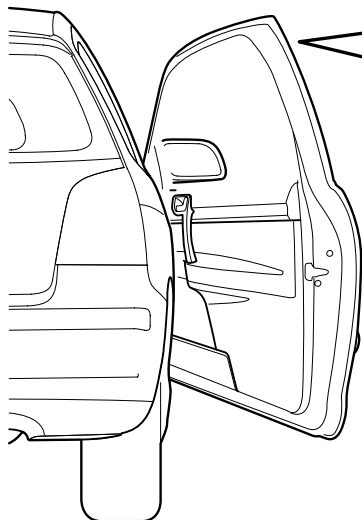
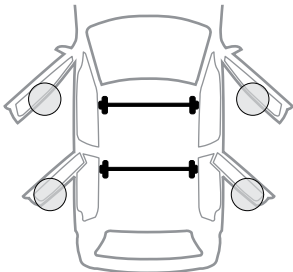

8

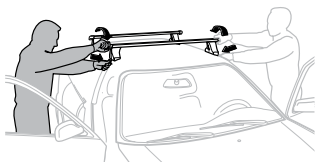

GB/US Tighten alternately
 D Die Schrauben abwechselnd anziehen
 F Serrer alternativement chaque côté
 NL Afwisselend aan de linker- en de rechterkant aandraaien
 I Alternare il serraggio delle viti
 E Apertar alternativamente
 PT Aperte alternadamente
 S Dra åt växelvis
 FIN Kierrä vuorotellen
 EST Pinguldage vaheldumisi
 LAT Pieļieciet pamišus
 LIT Užsukinėkite pakaitomis
 PL Śruby dokręcaj naprzemiennie
 RU Затягивайте попеременно

CZ Pokręťta bagażnika dokręcaj dokręcaj naprzemiennie.
 SK Dofahajte striedavo
 SLO Privijajte izmenično.
 HR Naizmjerno zategnite
 HU Egymástól függetlenül szorítandó
 GR Σφιγίγτες εναλλάξ
 TR Dönüşümlü sıkın

中文 交替拧紧

한국어 번갈아 가며 조이십시오.

日本語 交互に締め付けてください。

ไทย ชันในแบบสลับ

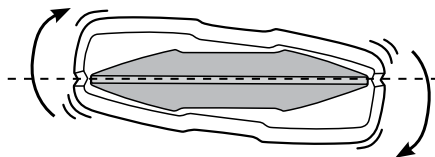
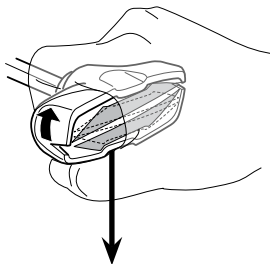
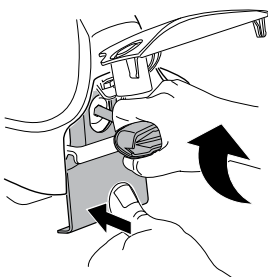
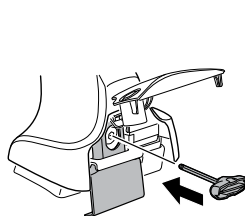

≈ 3 Nm

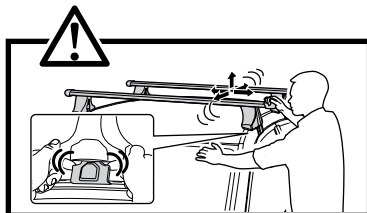
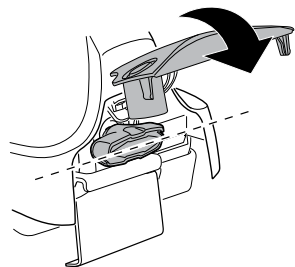

9



x1
17 mm

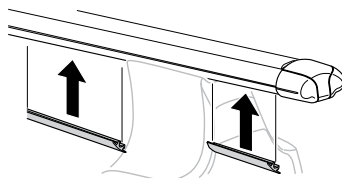
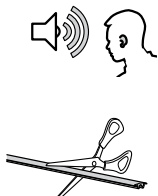

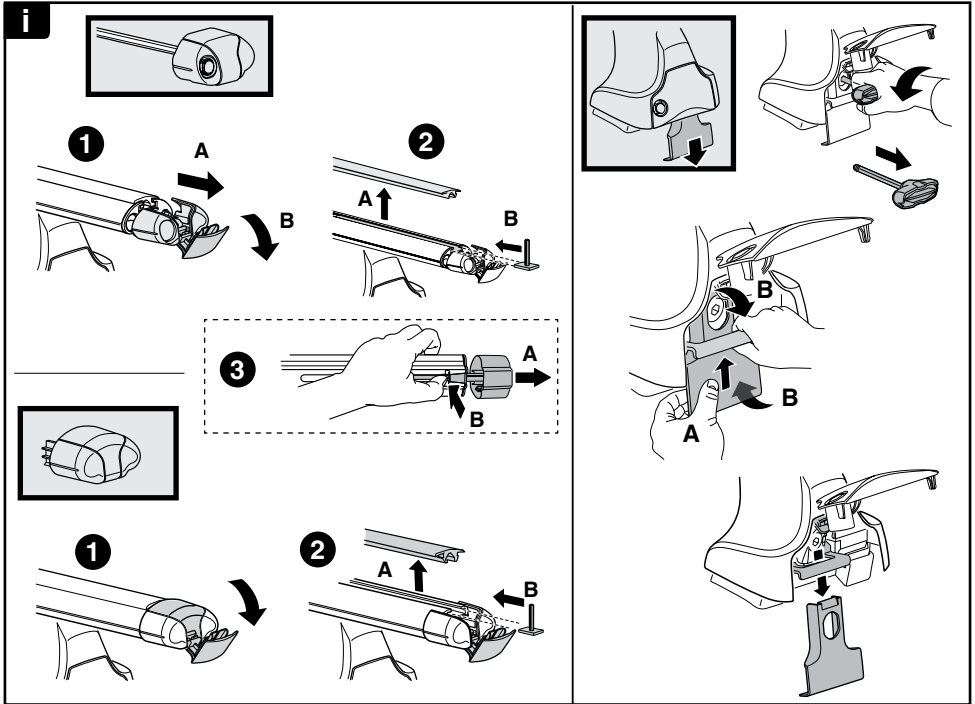
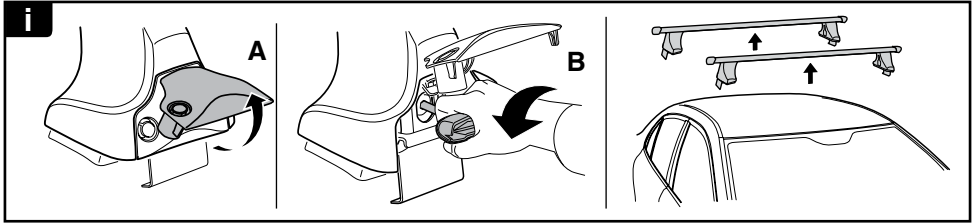

THULE
SWEDEN
**ONE
KEY
SYSTEM**

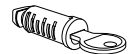
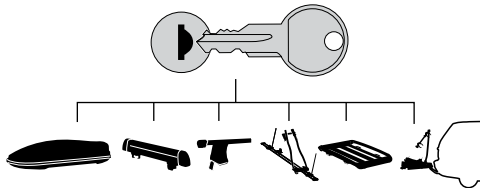

544 (x4)

596 (x6)

588 (x8)

NA **510** (x10)

EUR **452** (x12)

ASIA

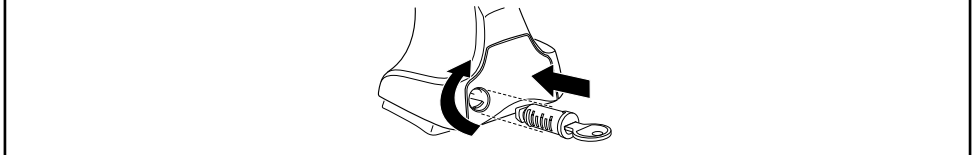

WW ▶ Thule Sweden AB, Box 69, 330 33 Hillerstorp, SWEDEN
NA ▶ Thule Inc., 42 Silvermine Road, Seymour, Connecticut 06483, USA

info@thule.com
customer.service@thule.com

www.thule.com

503-1618-02