

# Kit 1519

ACURA TL, 4-dr Sedan, \*09–

\*North America

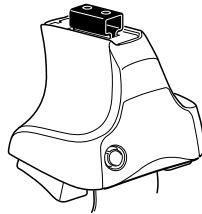

**754** Rapid System  
**480R** Rapid Traverse (North America)

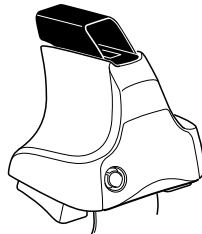
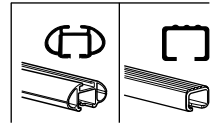

**480** Traverse (North America)

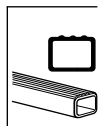

**754 Rapid System**  
**480R Rapid Traverse (North America)**

**754 Rapid System**  
**480R Rapid Traverse (North America)**

**480 Traverse (North America)**

**(North America)**

**419 x 2**  
**653 x 2**  
**109 x 2**  
**112 x 2**  
**RR ↓ ↓ FR**  
**FL ↓ ↓ RL** x 1

1

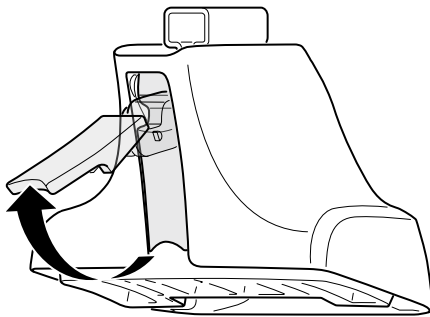

2



754 Rapid System  
480R Rapid Traverse  
(North America)

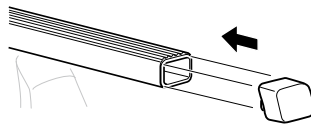
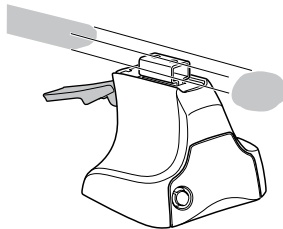

x4

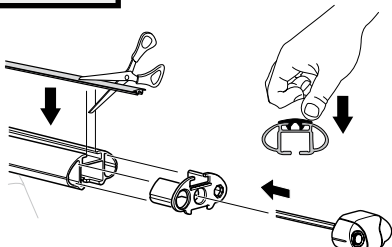
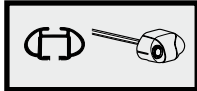

x4

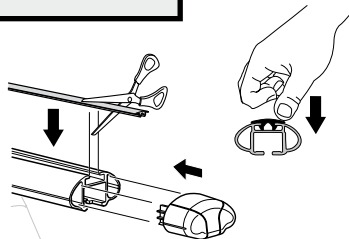
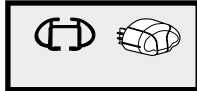

x4

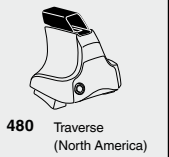

480 Traverse  
(North America)

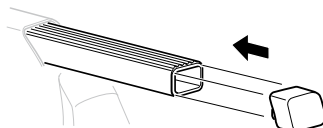
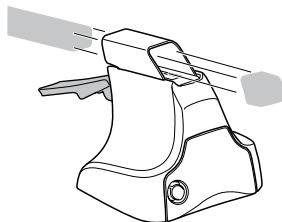

x4

**3**

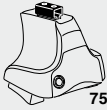

**754** Rapid System

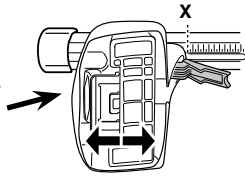

|                                   | <b>X</b>  |
|-----------------------------------|-----------|
| <b>ACURA TL, 4-dr Sedan, *09-</b> | <b>43</b> |

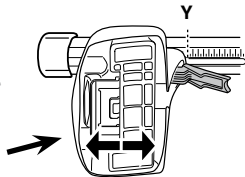

|                                   | <b>Y</b>  |
|-----------------------------------|-----------|
| <b>ACURA TL, 4-dr Sedan, *09-</b> | <b>42</b> |

**3**



**480R** Rapid Traverse



**480** Traverse



**(North America)**

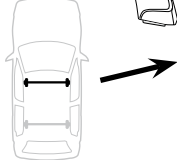

|                                   | <b>X inch</b>  | <b>X mm</b>    |
|-----------------------------------|----------------|----------------|
| <b>ACURA TL, 4-dr Sedan, *09-</b> | <b>42 1/2"</b> | <b>1080 mm</b> |

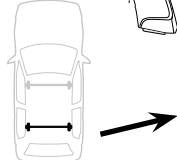

|                                   | <b>Y inch</b> | <b>Y mm</b>    |
|-----------------------------------|---------------|----------------|
| <b>ACURA TL, 4-dr Sedan, *09-</b> | <b>42"</b>    | <b>1070 mm</b> |

**4**

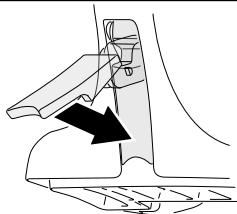

# 5

ACURA TL, 4-dr Sedan, \*09-

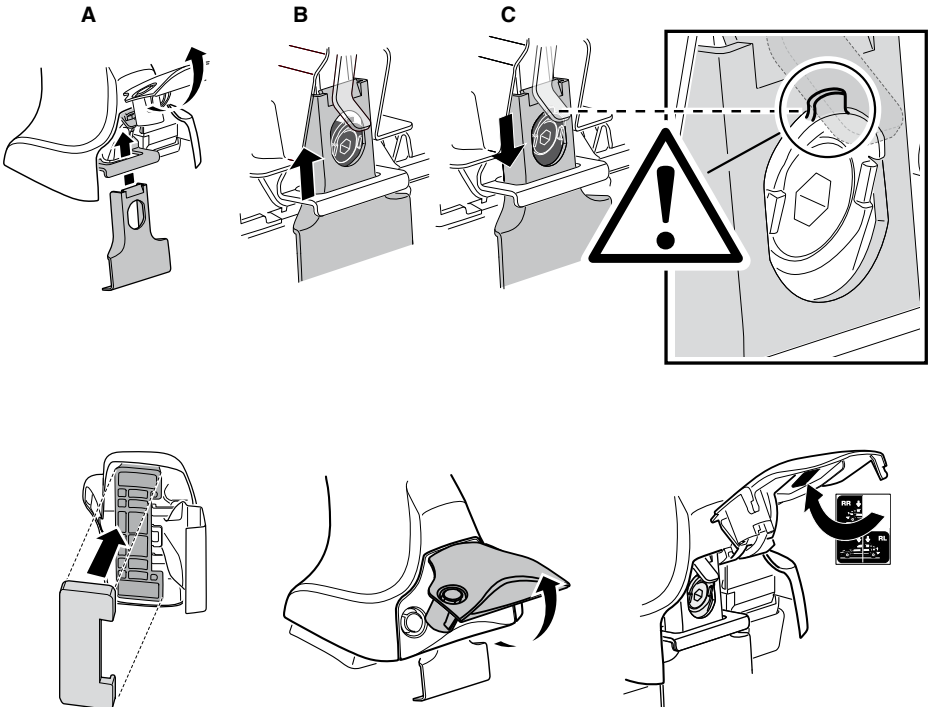
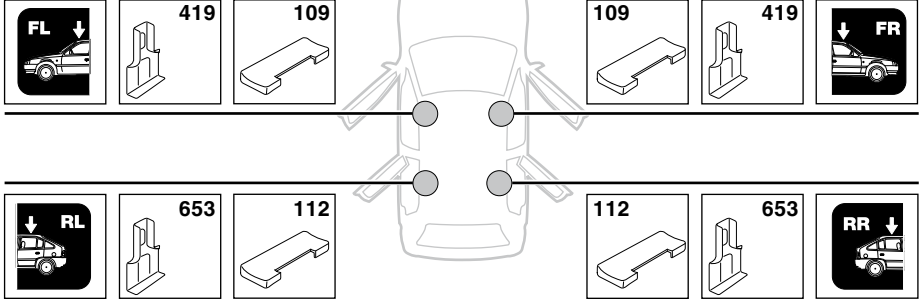

6

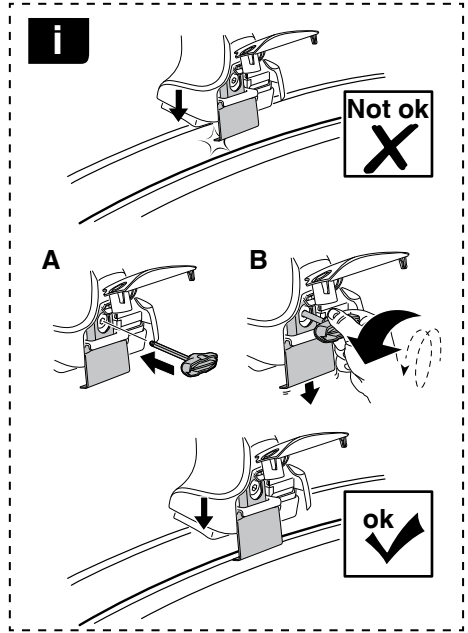
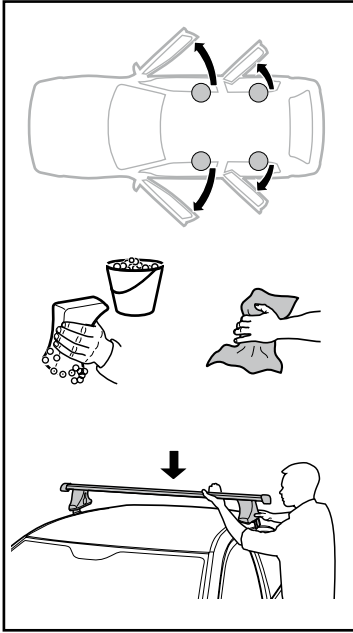

ACURA TL, 4-dr Sedan, \*09-

X mm      Y mm      X inch      Y inch

255 mm    700 mm    10 "      27 1/2 "

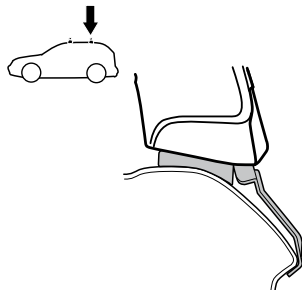
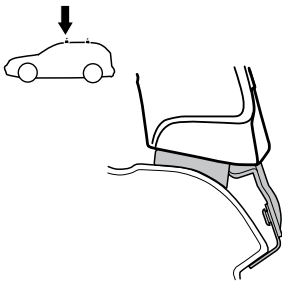
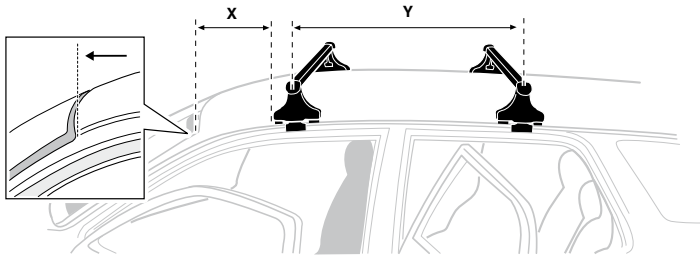

7

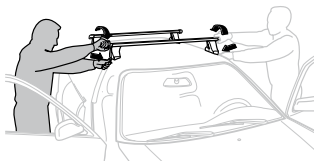

|              |   |
|--------------|---|
| <b>GB/US</b> | Tighten alternately                                     |
| <b>D</b>     | Die Schrauben abwechselnd anziehen                      |
| <b>F</b>     | Serrer alternativement chaque côté                      |
| <b>NL</b>    | Afwisselend aan de linker- en de rechterkant aandraaien |
| <b>I</b>     | Alternare il serraggio delle viti                       |
| <b>E</b>     | Apretar alternativamente                                |
| <b>PT</b>    | Aperte alternadamente                                   |
| <b>S</b>     | Dra åt växelvis   |
| <b>FIN</b>   | Kierrä vuorotellen                                      |
| <b>EST</b>   | Pinguldage vaheldumisi                                  |
| <b>LAT</b>   | Pielveiciet pamišus                                     |
| <b>LIT</b>   | Užsukinėkite pakaitomis                                 |
| <b>PL</b>    | Śruby dokręcaj naprzemiennie                            |
| <b>RU</b>    | Загряивайте попеременно                                 |

|            |  |
|------------|--|
| <b>CZ</b>  | Pokręřta багаžnika dokręcaj naprzemiennie. |
| <b>SK</b>  | Dofahajte striedavo                        |
| <b>SLO</b> | Privijajte izmenično.                      |
| <b>HR</b>  | Naizmjenočno zategnite                     |
| <b>HU</b>  | Egymástól függetlenül szorítandó           |
| <b>GR</b>  | Σφιγίγες εναλλάξ                           |
| <b>TR</b>  | Dönüşümlü sıkın                            |

**中文** 交替拧紧

**한국어** 번갈아 가며 조이십시오.

**日本語** 交互に締め付けてください。

**ไทย** ชันในแบบสลับ

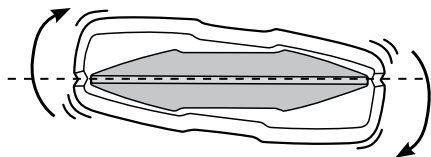
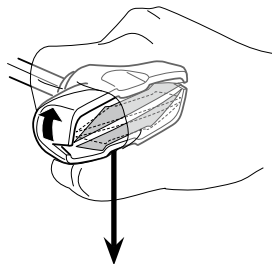
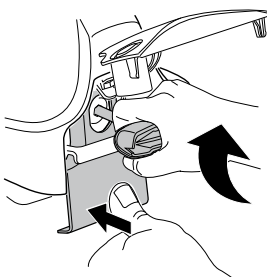
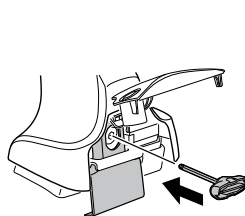

≈ 3 Nm

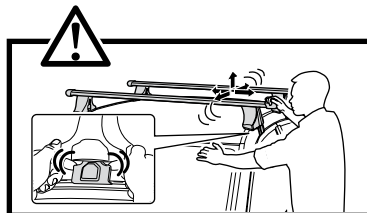
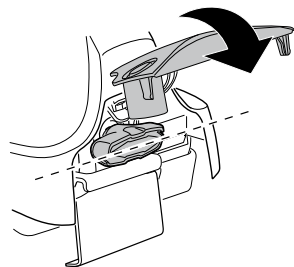

8



x1  
17 mm

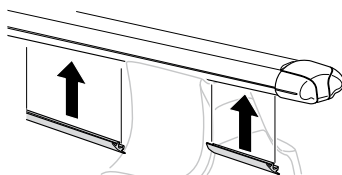

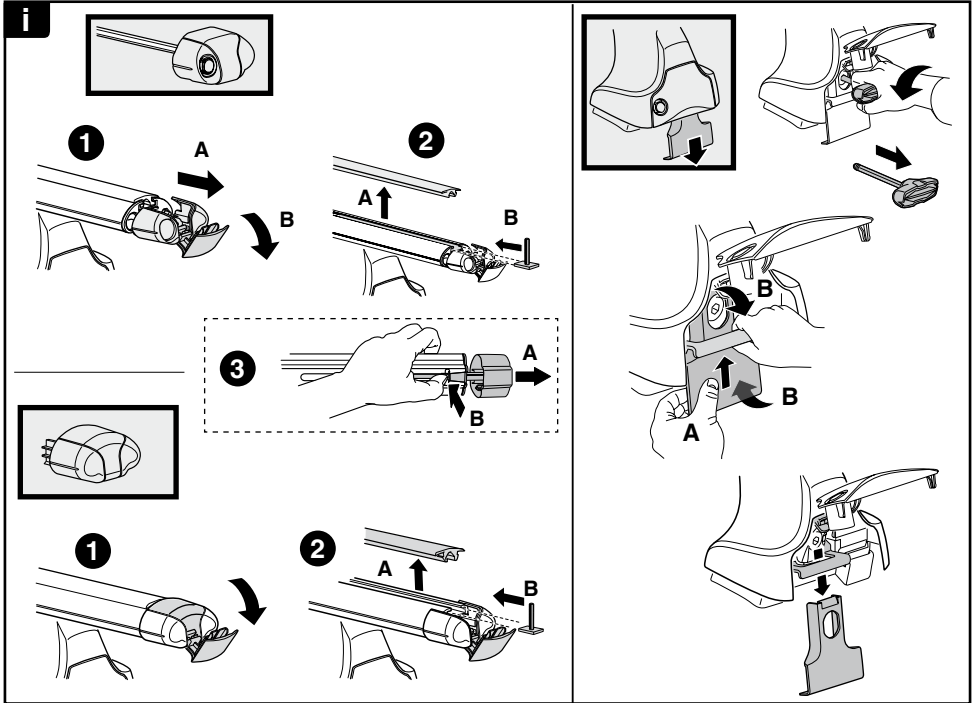
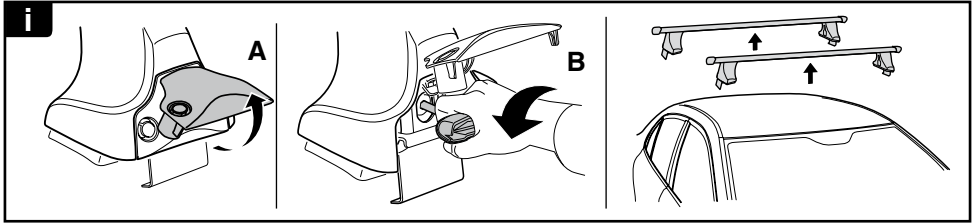

**THULE**  
SWEDEN  
**ONE  
KEY  
SYSTEM**

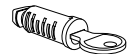
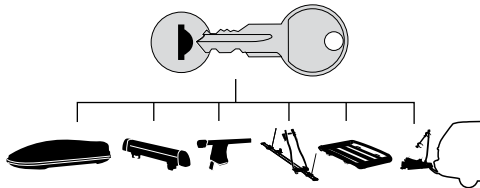

**544** (x4)

**596** (x6)

**588** (x8)

NA **510** (x10)

EUR **452** (x12)

ASIA

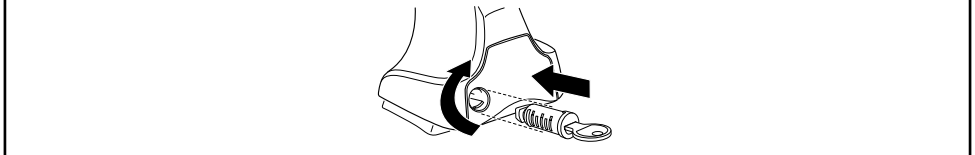

WW ▶ Thule Sweden AB, Box 69, 330 33 Hillerstorp, SWEDEN  
NA ▶ Thule Inc., 42 Silvermine Road, Seymour, Connecticut 06483, USA

info@thule.com  
customer.service@thule.com

www.thule.com

503-1519-02