

Kit 1499

OPEL Agila, 5-dr Hatchback, 08–
SUZUKI Splash, 5-dr Hatchback, 08–

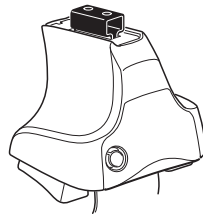

754 Rapid System
480R Rapid Traverse (North America)

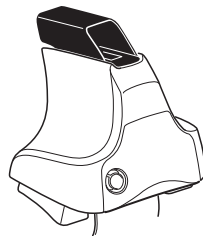
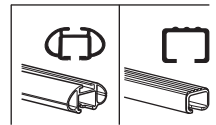

480 Traverse (North America)

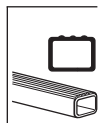

1

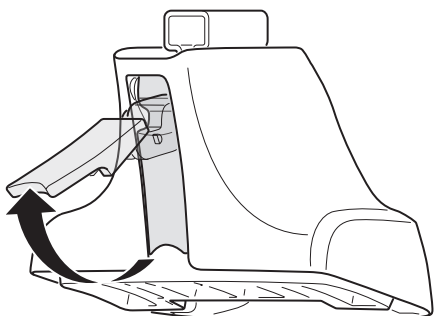

2



754 Rapid System
480R Rapid Traverse
(North America)

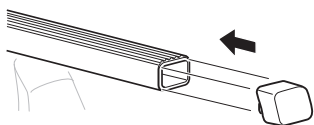
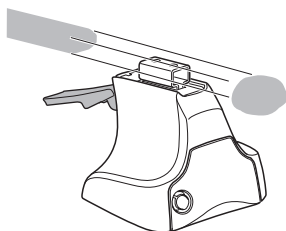

x4

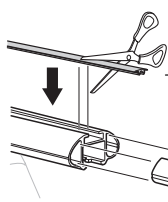
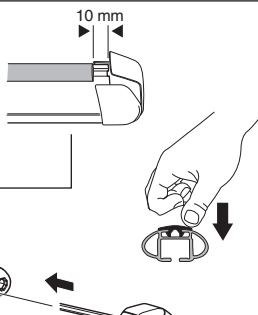

x4

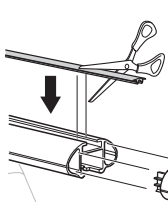
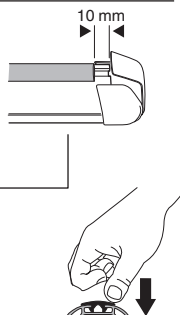

x4



480 Traverse
(North America)

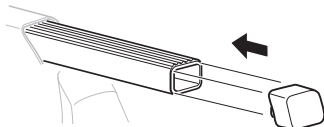
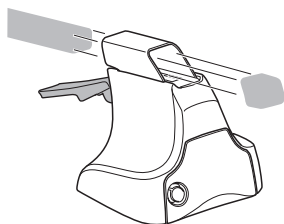

x4

3

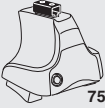

754 Rapid System

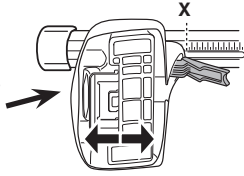

	X
OPEL Agila, 5-dr Hatchback, 08-	28,5
SUZUKI Splash, 5-dr Hatchback, 08-	28,5

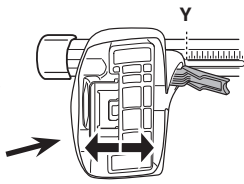

	Y
OPEL Agila, 5-dr Hatchback, 08-	27
SUZUKI Splash, 5-dr Hatchback, 08-	27

3



480R Rapid Traverse



480 Traverse



(North America)



	X inch	X mm
OPEL Agila, 5-dr Hatchback, 08-	36 7/8"	936 mm
SUZUKI Splash, 5-dr Hatchback, 08-	36 7/8"	936 mm

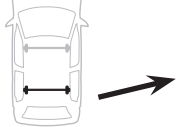

	Y inch	Y mm
OPEL Agila, 5-dr Hatchback, 08-	36 1/4"	921 mm
SUZUKI Splash, 5-dr Hatchback, 08-	36 1/4"	921 mm

4

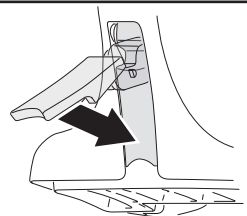

5

OPEL Agila, 5-dr Hatchback, 08–
SUZUKI Splash, 5-dr Hatchback, 08–

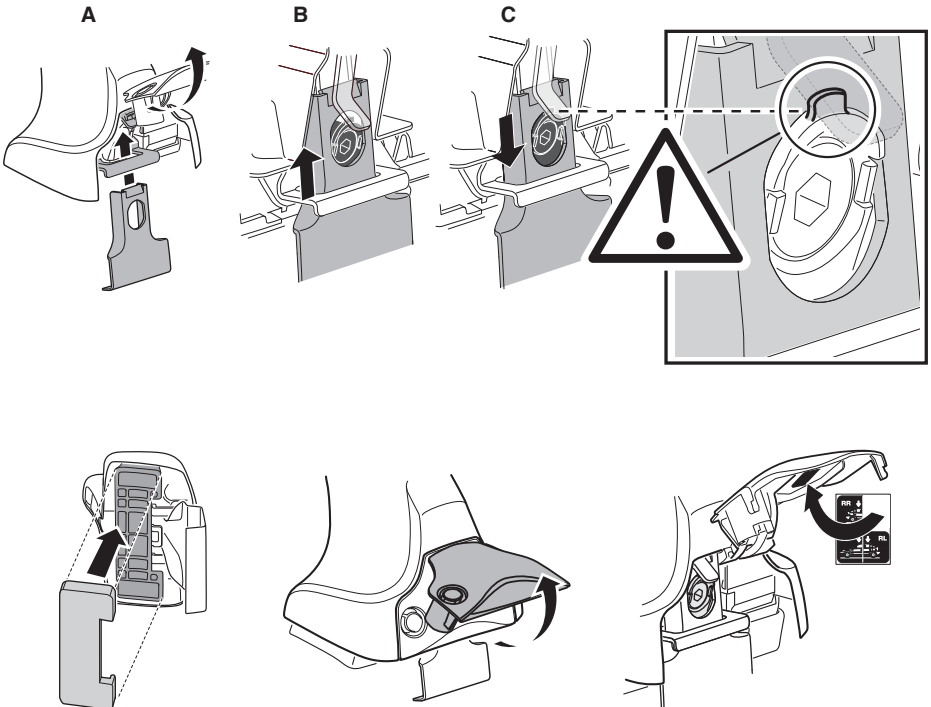
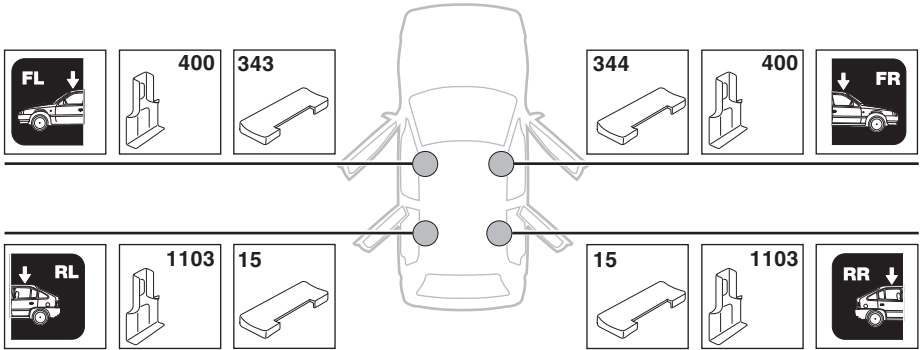

6

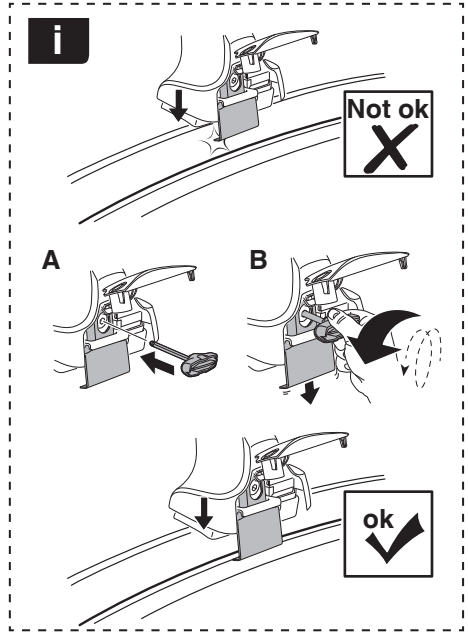
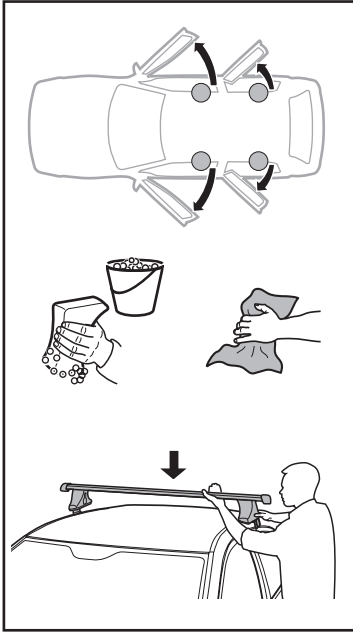

	X mm	Y mm	X inch	Y inch
OPEL Agila, 5-dr Hatchback, 08-	270 mm	700 mm	10 ⁵ / ₈ "	27 ¹ / ₂ "
SUZUKI Splash, 5-dr Hatchback, 08-	270 mm	700 mm	10 ⁵ / ₈ "	27 ¹ / ₂ "

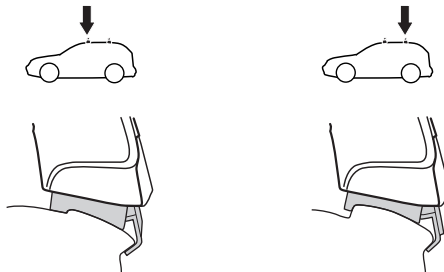
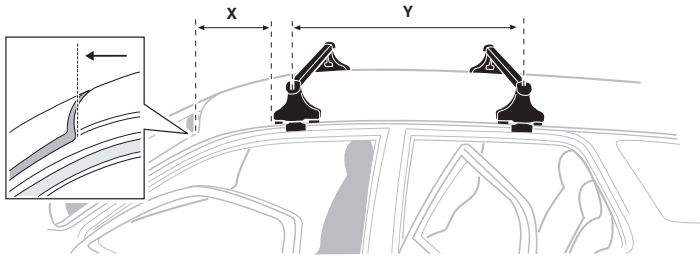

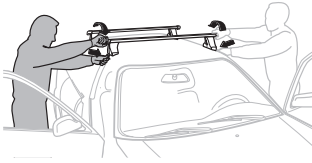
7

GB/US Tighten alternately
D Die Schrauben abwechselnd anziehen
F Serrer alternativement chaque côté
NL Afwisselend aan de linker- en de rechterkant aandraaien
I Alternare il serraggio delle viti
E Apertar alternativamente
PT Aperte alternadamente
S Dra åt växelvis
FIN Kierrä vuorotellen
EST Pinguldage vaheldumisi
LAT Pielveiciet pamišus
LIT Užsukinėkite pakaitomis
PL Śruby dokręcaj naprzemiennie
RU Затягивайте попеременно

CZ Pokręťta bagażnika dokręcaj naprzemiennie.
SK Dofahajte striedavo
SLO Privijajte izmenično.
HR Naizmjениčno zategnite
HU Egymástól függetlenül szorítandó
GR Σφιγγετε εναλλάξ
TR Dönüşümlü sıkın

中文 交替拧紧

한국어 번갈아 가며 조이십시오.

日本語 交互に締め付けてください。

ไทย ชันในแบบสลับ

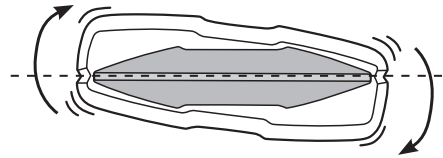
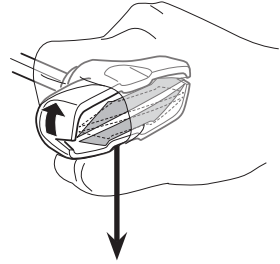
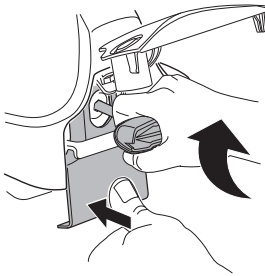
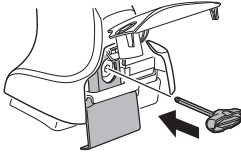

≈ 3 Nm

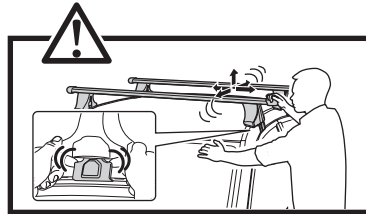
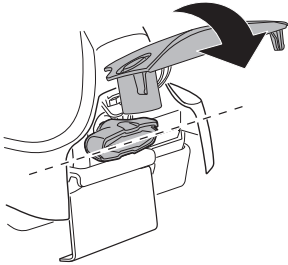
**8**

x1
17 mm

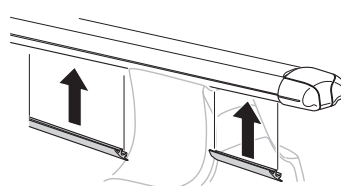
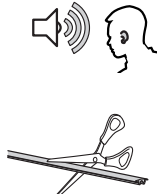

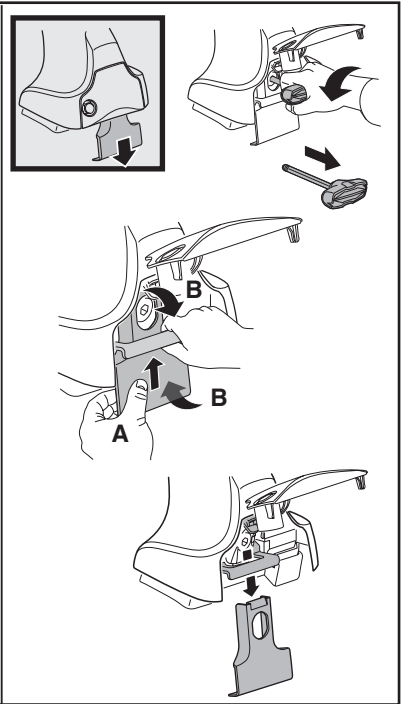
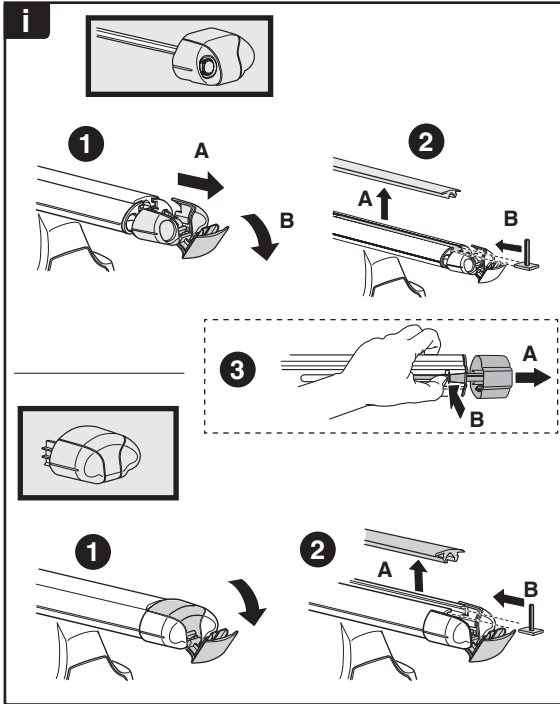
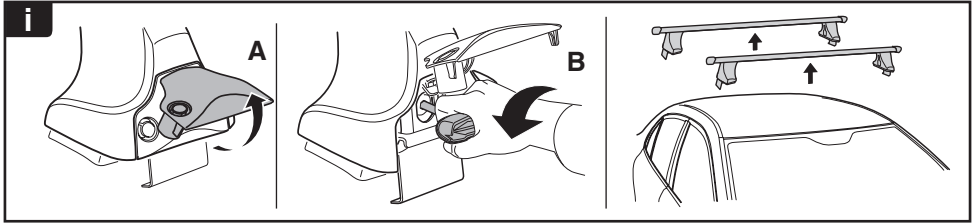

THULE
SWEDEN
**ONE
KEY
SYSTEM**



		(x4)
		(x6)
		(x8)
NA		(x10)
EUR		(x12)
ASIA		



WW ▶ Thule Sweden AB, Box 69, 330 33 Hillerstorp, SWEDEN
NA ▶ Thule Inc., 42 Silvermine Road, Seymour, Connecticut 06483, USA

info@thule.com
customer.service@thule.com

www.thule.com