

Kit 1200

FORD Escape, 5-dr SUV, 00-07

FORD Maverick, 5-dr SUV, 01-07

MAZDA Tribute, 5-dr SUV, 00-03, 04-07

480R
754

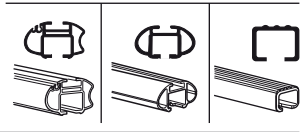
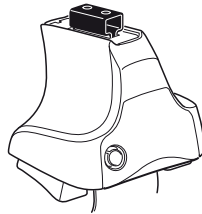

480

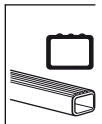
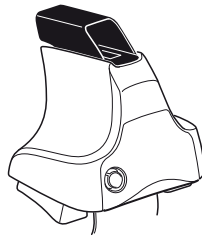

750

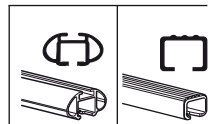
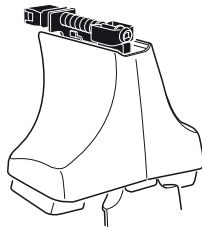

xx kg
 xx lbs + 7 kg
 15,4 lbs = **Max. 50kg**
Max. 110 lbs

80 km/h 50 Mph
 130 km/h 80 Mph
 40 km/h 25 Mph
km/h Mph

THULE
Kit XXXX
instructions

x4
 x4
480R/754

x4
 x4
480

x4
 x4
750

x2	x2	x2	x2	x2
x2	x2	x2	x2	x2
x2	x2	x4	x4	x2
x4		x4		

x1
369 x4
07 x4
 x1

Kit



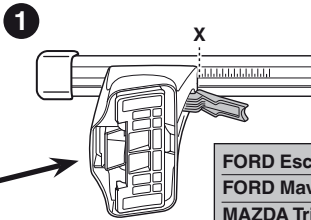

	X
FORD Escape, 5-dr SUV, 00-07	37
FORD Maverick, 5-dr SUV, 01-07	37
MAZDA Tribute, 5-dr SUV, 00-03, 04-07	37

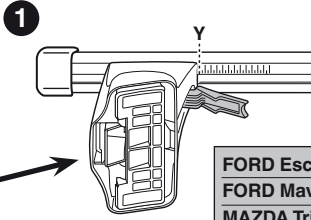

	Y
FORD Escape, 5-dr SUV, 00-07	36,5
FORD Maverick, 5-dr SUV, 01-07	36,5
MAZDA Tribute, 5-dr SUV, 00-03, 04-07	36,5

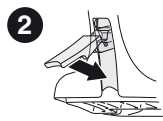
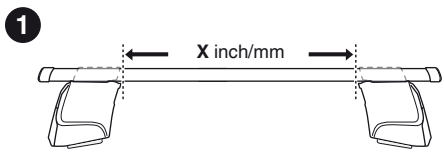
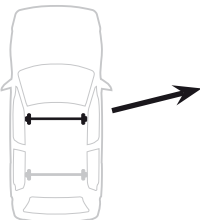
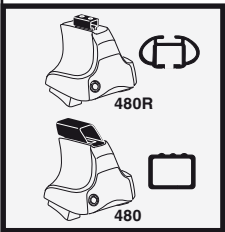

	X inch	X mm
FORD Escape, 5-dr SUV, 00-07	40 1/4"	1021 mm
FORD Maverick, 5-dr SUV, 01-07	40 1/4"	1021 mm
MAZDA Tribute, 5-dr SUV, 00-03, 04-07	40 1/4"	1021 mm

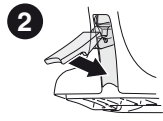
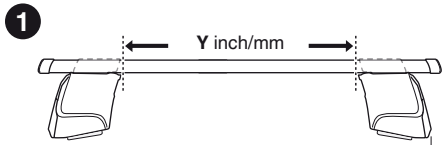
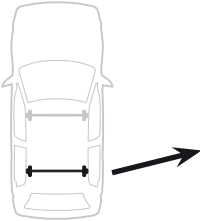

	Y inch	Y mm
FORD Escape, 5-dr SUV, 00-07	40"	1016 mm
FORD Maverick, 5-dr SUV, 01-07	40"	1016 mm
MAZDA Tribute, 5-dr SUV, 00-03, 04-07	40"	1016 mm

4

FORD Escape, 5-dr SUV, 00-07
FORD Maverick, 5-dr SUV, 01-07
MAZDA Tribute, 5-dr SUV, 00-03, 04-07

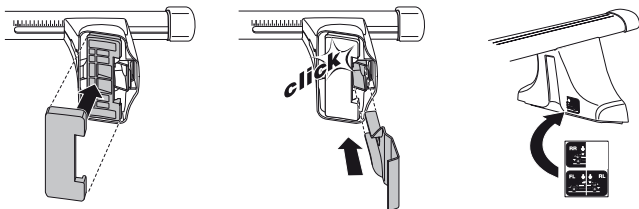
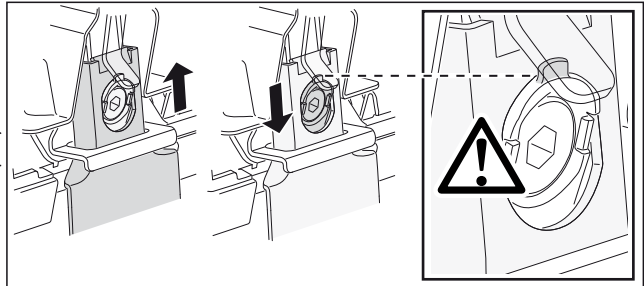
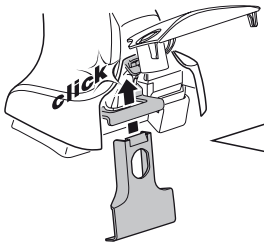
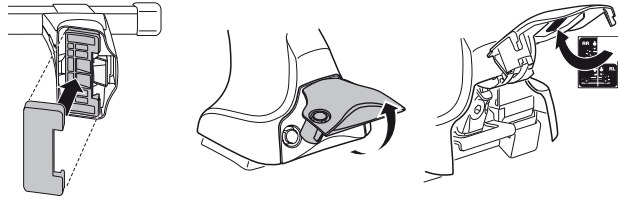
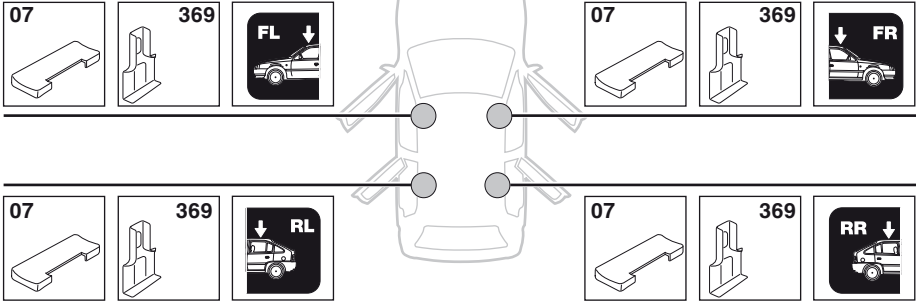

5



	X mm	Y mm	X inch	Y inch
FORD Escape , 5-dr SUV, 00-07	290 mm	700 mm	11 ³ / ₈ "	27 ¹ / ₂ "
FORD Maverick , 5-dr SUV, 01-07	290 mm	700 mm	11 ³ / ₈ "	27 ¹ / ₂ "
MAZDA Tribute , 5-dr SUV, 00-03, 04-07	290 mm	700 mm	11 ³ / ₈ "	27 ¹ / ₂ "

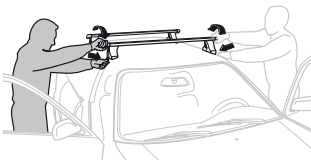
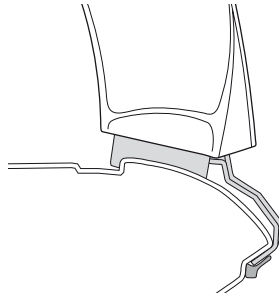
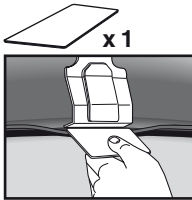
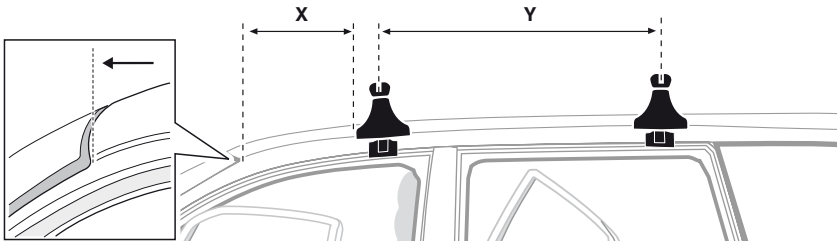

GB/US Tighten alternately
D Die Schrauben abwechselnd anziehen
F Serrer alternativement chaque côté
NL Afwisselend aan de linker- en de rechterkant aandraaien
I Alternare il serraggio delle viti
E Apretar alternativamente
PT Aperte alternadamente
S Dra åt växelvis
FIN Kierrä vuorotellen
EST Pinguldage vaheldumisi
LAT Pievelciēt pamīšus
LIT Užsukinėkite pakaitomis
PL Śruby dokręcaj naprzemiennie
RU Затягивайте попеременно

CZ Pokręťla багаžníka dokręcaj dokręcaj naprzemiennie.
SK Doťahujte striedavo
SLO Privijajte izmenično.
HR Naizmjenično zategnite
HU Egymástól függetlenül szorítandó
GR Σφιγγετε εναλλάξ
TR Dönüşümlü sıkın

中文 交替拧紧

한국어 번갈아 가며 조이십시오.

日本語 交互に締め付けてください。

ไทย ขันในแบบสลับ

6



480R/754



480

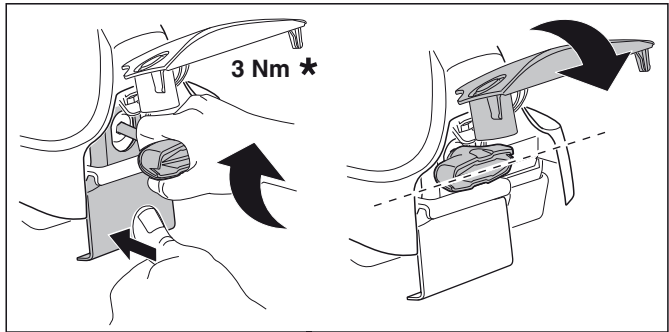
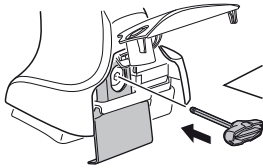

3 Nm *

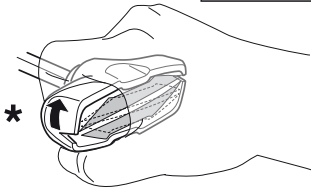

*

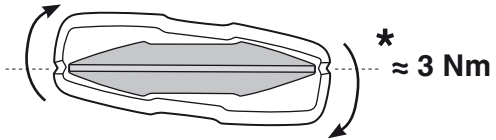

* ≈ 3 Nm



750

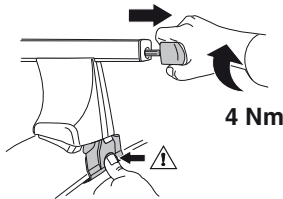

4 Nm

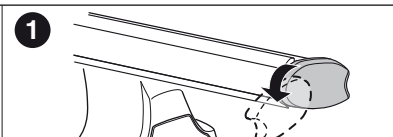
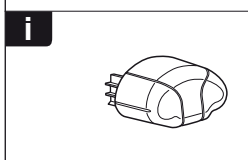
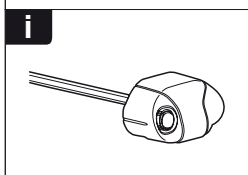
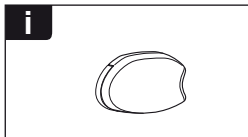
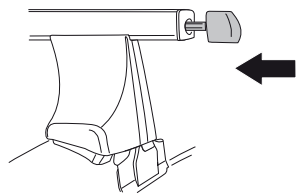

1

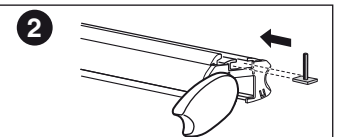

2

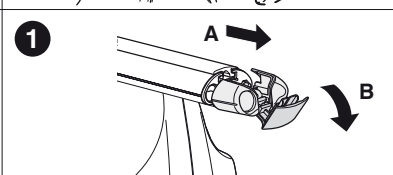

1

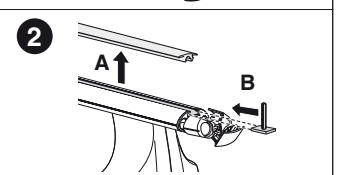

2

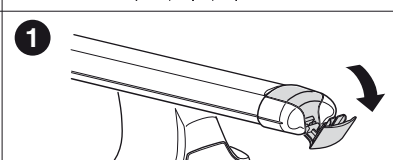

1

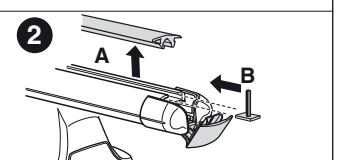

2

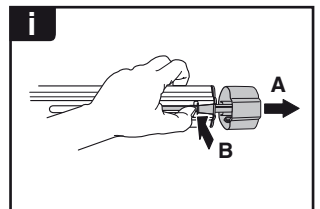
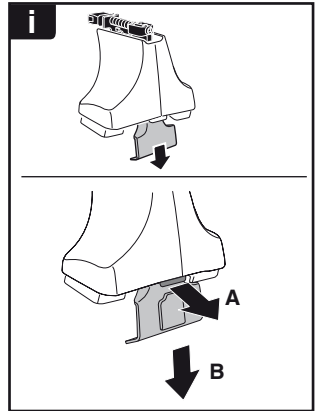

THULE
SWEDEN
**ONE
KEY
SYSTEM**



- 544 (x4)
- 596 (x6)
- 588 (x8)
- NA 510 (x10)
- EUR 452 (x12)
- ASIA



WW ▶ Thule Sweden AB, Box 69, 330 33 Hillerstorp, SWEDEN
NA ▶ Thule Inc., 42 Silvermine Road, Seymour, Connecticut 06483, USA

info@thule.com
customer.service@thule.com

www.thule.com