

# Kit 1111

VOLVO S80, 4-dr Sedan, 98-06 / \*99-06

\*North America

480R  
754

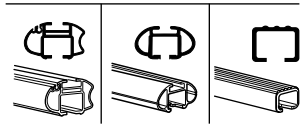
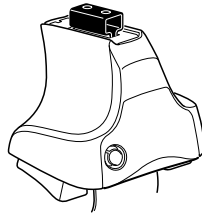

480

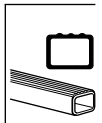
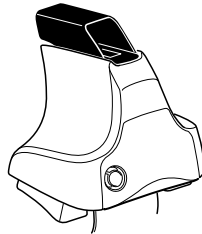

750

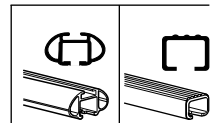
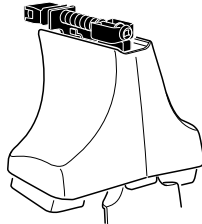

x2 x2 x2 x4	x2	x2 x2 x4 x4	x2 x2	x2

148 x 2

324 x 2

58 x 4

x 1

**Kit**



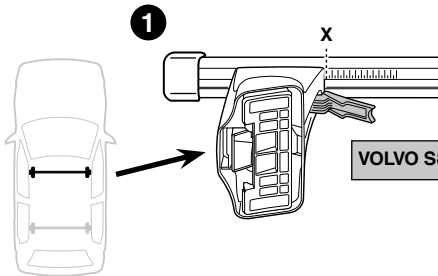
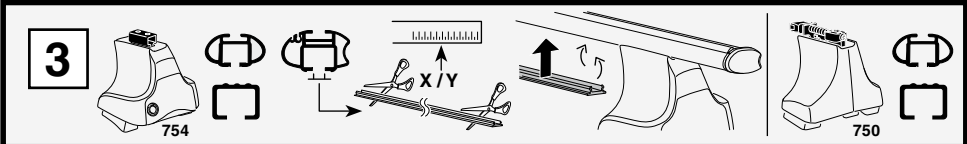

VOLVO S80, 4-dr Sedan, 98-06 / *99-06	X
	44

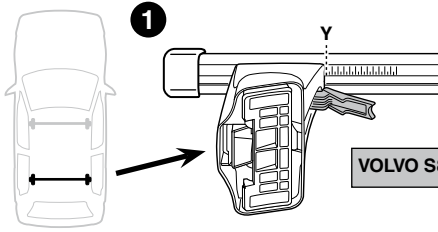
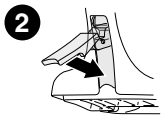

VOLVO S80, 4-dr Sedan, 98-06 / *99-06	Y
	38

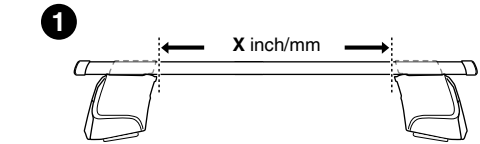
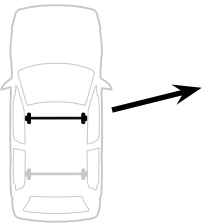
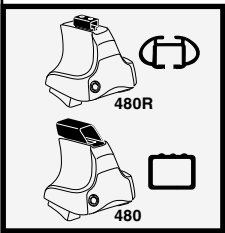
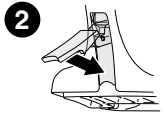

VOLVO S80, 4-dr Sedan, 98-06 / *99-06	X inch	X mm
	43"	1091 mm

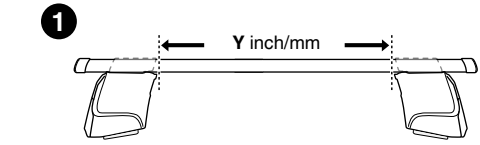
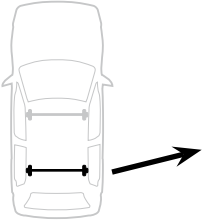
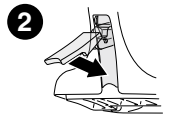

VOLVO S80, 4-dr Sedan, 98-06 / *99-06	Y inch	Y mm
	40 5/8"	1031 mm

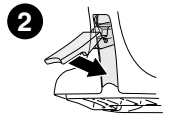

4

VOLVO S80, 4-dr Sedan, 98-06 / \*99-06

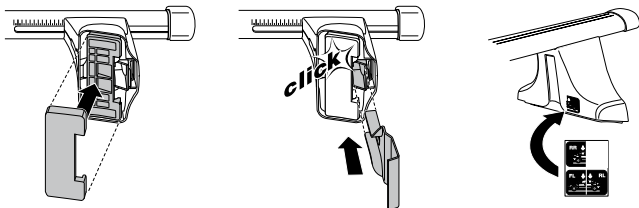
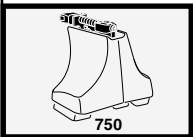
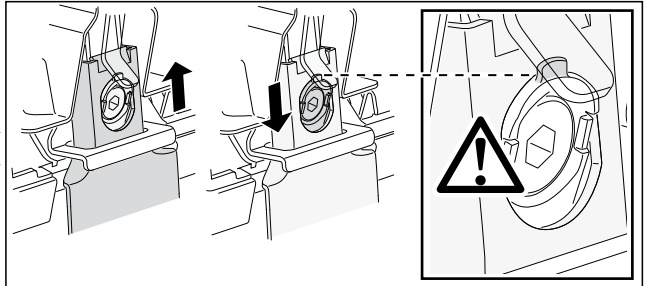
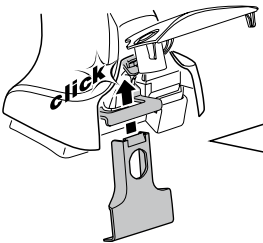
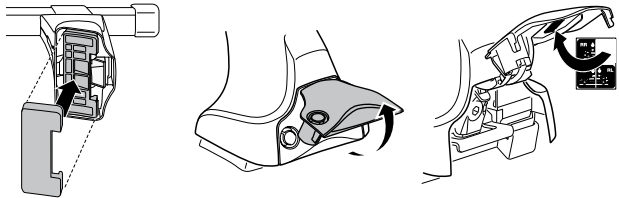
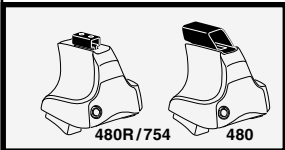
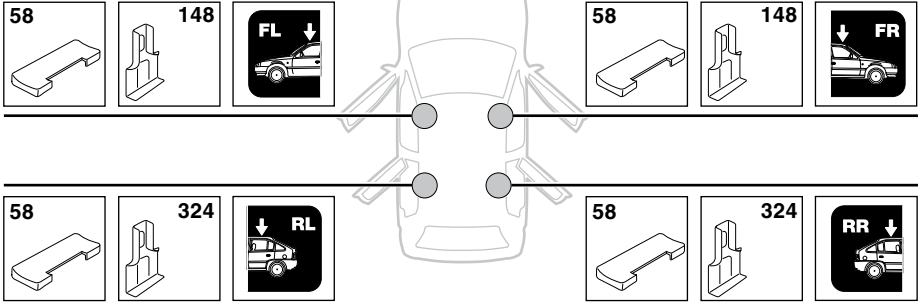

5



	X mm	Y mm	X inch	Y inch
<b>VOLVO S80, 4-dr Sedan, 98–06 / *99-06</b>	<b>200 mm</b>	<b>700 mm</b>	<b>7 7/8"</b>	<b>27 1/2"</b>

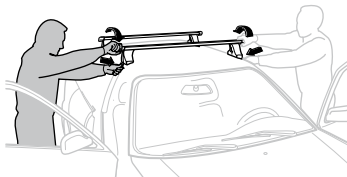
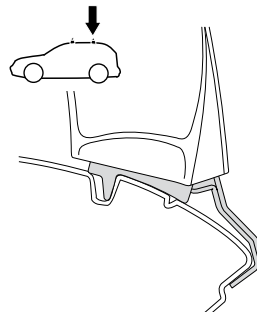
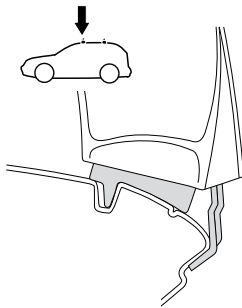
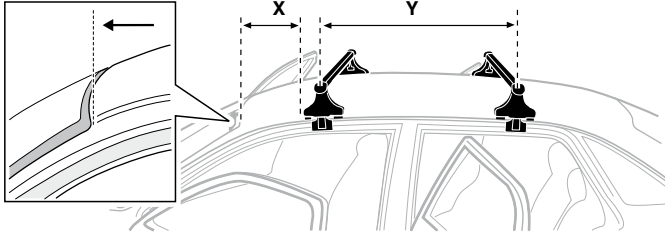

**GB/US** Tighten alternately

**D** Die Schrauben abwechselnd anziehen

**F** Serrer alternativement chaque côté

**NL** Afwisselend aan de linker- en de rechterkant aandraaien

**I** Alternare il serraggio delle viti

**E** Serrare alternativamente

**PT** Aperte alternadamente

**S** Dra åt växelvis

**FIN** Kierrä vuorotellen

**EST** Pinguldage vaheldumisi

**LAT** Pielieciet pamišus

**LIT** Užsukinėkite pakaitomis

**PL** Śruby dokręcaj naprzemiennie

**RU** Затягивайте попеременно

**CZ** Pokręťta багаžníka dokręcaj dokręcaj naprzemiennie.

**SK** Doťahujte striedavo

**SLO** Privijajte izmenično.

**HR** Naizmjenično zategnite

**HU** Egymástól függetlenül szorítandó

**GR** Σφιγγετε εναλλάξ

**TR** Dönüşümlü sıkın

**中文** 交替拧紧

**한국어** 번갈아 가며 조이십시오.

**日本語** 交互に締め付けてください。

**ไทย** ชันโนแบบสลับ

6



480R/754



480

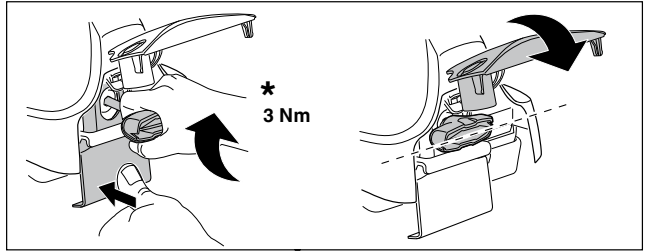
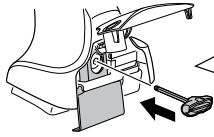

\*  
3 Nm

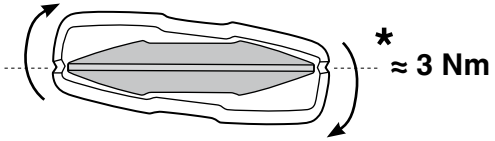

\*  
≈ 3 Nm

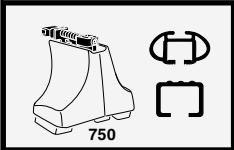
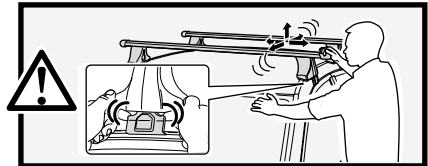

750

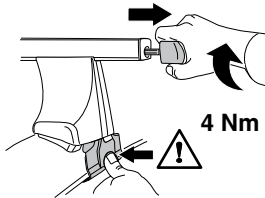

4 Nm

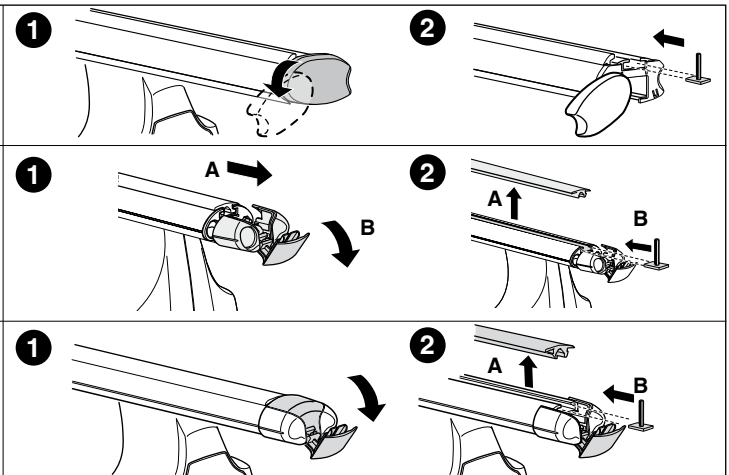
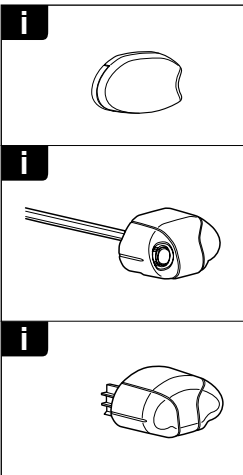
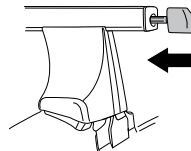

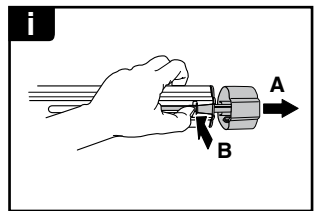
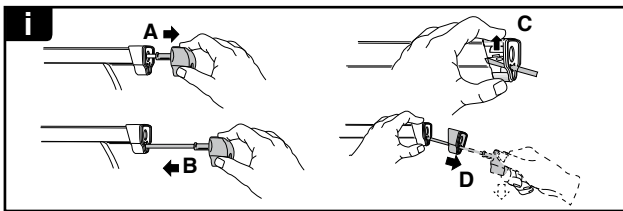
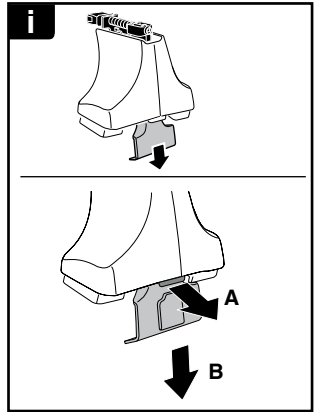
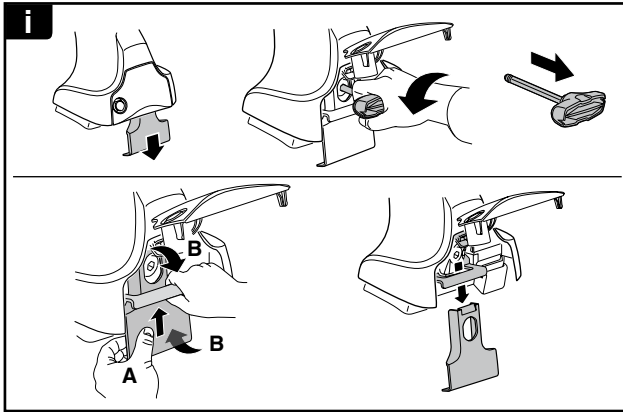

**THULE**  
SWEDEN  
**ONE  
KEY  
SYSTEM**



- 544 (x4)
- 596 (x6)
- 588 (x8)
- NA 510 (x10)
- EUR 452 (x12)
- ASIA

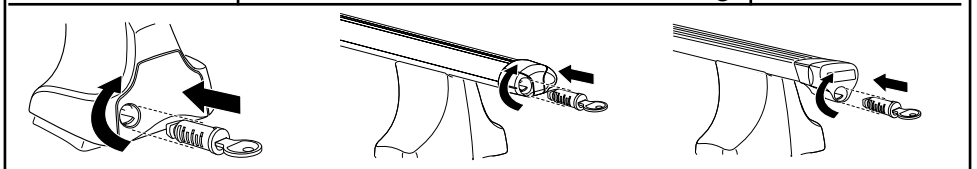

WW ▶ Thule Sweden AB, Box 69, 330 33 Hillerstorp, SWEDEN  
NA ▶ Thule Inc., 42 Silvermine Road, Seymour, Connecticut 06483, USA

info@thule.com  
customer.service@thule.com

www.thule.com