

Kit 1287

TOYOTA Landcruiser Prado, 5-dr SUV, 02–
TOYOTA Landcruiser 90, 5-dr SUV, 02-03
TOYOTA Landcruiser (120), 5-dr SUV, 04–

480R
754

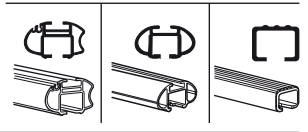
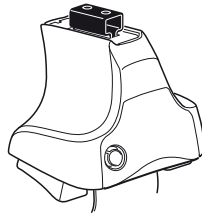

480

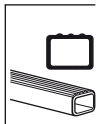
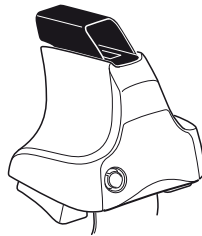

750

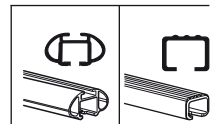
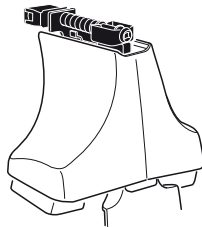

Kit



3

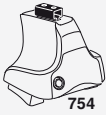

754

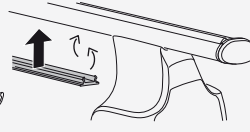
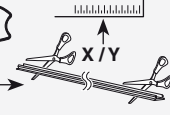

750

1

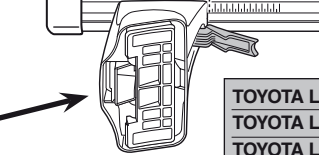
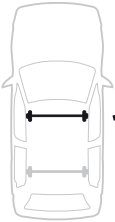

2



	X
TOYOTA Landcruiser Prado, 5-dr SUV, 02–	48
TOYOTA Landcruiser 90, 5-dr SUV, 02-03	48
TOYOTA Landcruiser (120), 5-dr SUV, 04–	48

1

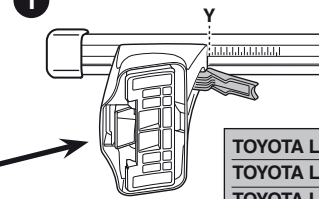

2

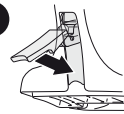

	Y
TOYOTA Landcruiser Prado, 5-dr SUV, 02–	44
TOYOTA Landcruiser 90, 5-dr SUV, 02-03	44
TOYOTA Landcruiser (120), 5-dr SUV, 04–	44



480R



480

1

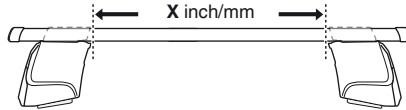

2

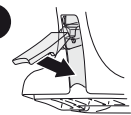

	X inch	X mm
TOYOTA Landcruiser Prado, 5-dr SUV, 02–	44 1/2"	1131 mm
TOYOTA Landcruiser 90, 5-dr SUV, 02-03	44 1/2"	1131 mm
TOYOTA Landcruiser (120), 5-dr SUV, 04–	44 1/2"	1131 mm

1

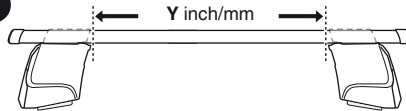

2

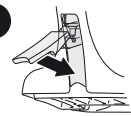

	Y inch	Y mm
TOYOTA Landcruiser Prado, 5-dr SUV, 02–	43"	1091 mm
TOYOTA Landcruiser 90, 5-dr SUV, 02-03	43"	1091 mm
TOYOTA Landcruiser (120), 5-dr SUV, 04–	43"	1091 mm

4

TOYOTA Landcruiser Prado, 5-dr SUV, 02–
 TOYOTA Landcruiser 90, 5-dr SUV, 02-03
 TOYOTA Landcruiser (120), 5-dr SUV, 04–

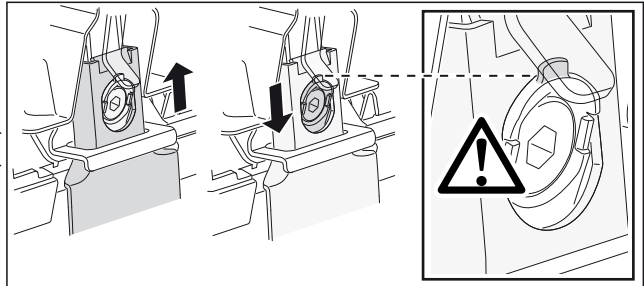
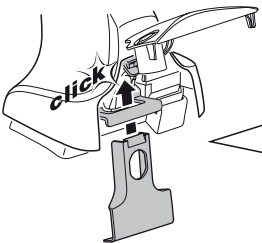
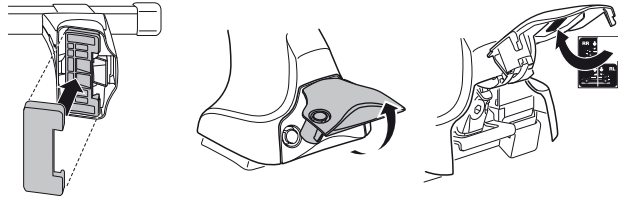
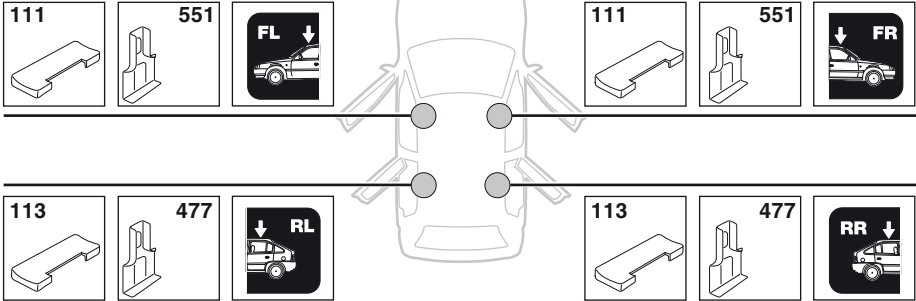

5



	X mm	Y mm	X inch	Y inch
TOYOTA Landcruiser Prado, 5-dr SUV, 02-	355 mm	710 mm	14 "	28 "
TOYOTA Landcruiser 90, 5-dr SUV, 02-03	355 mm	710 mm	14 "	28 "
TOYOTA Landcruiser (120), 5-dr SUV, 04-	355 mm	710 mm	14 "	28 "

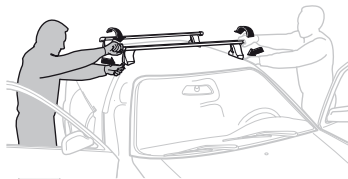
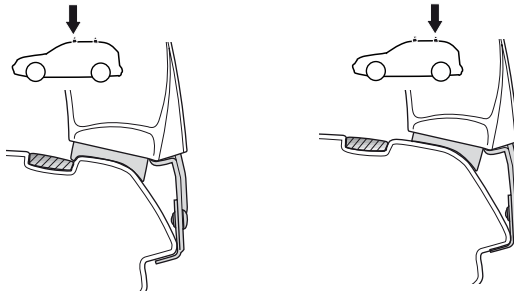
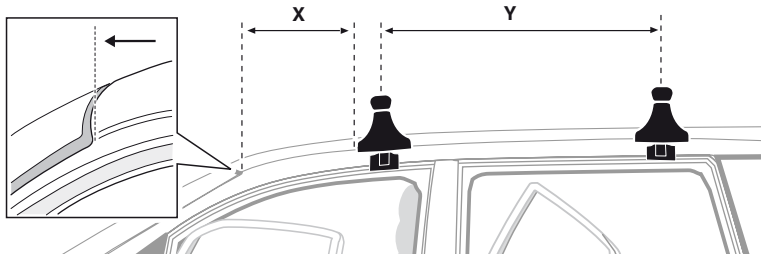

GB/US Tighten alternately

D Die Schrauben abwechselnd anziehen

F Serrer alternativement chaque côté

NL Afwisselend aan de linker- en de rechterkant aandraaien

I Alternare il serraggio delle viti

E Apretar alternativamente

PT Aperte alternadamente

S Dra åt växelvis

FIN Kierrä vuorotellen

EST Pinguldage vaheldumisi

LAT Pielvelciēt pamīšus

LIT Užsukinėkite pakaitomis

PL Śruby dokręcaj naprzemiennie

RU Затягивайте попеременно

CZ Pokręťta bagażníka dokręcaj dokręcaj naprzemiennie.

SK Doťahujte striedavo

SLO Privijajte izmenično.

HR Naizmjenično zategnite

HU Egymástól függetlenül szorítandó

GR Σφίγγετε εναλλάξ

TR Dönüşümlü sıkın

中文 交替拧紧

한국어 번갈아 가며 조이십시오.

日本語 交互に締め付けてください。

ไทย ชั้้นโน้บแบบสลับ

6



480R/754



480

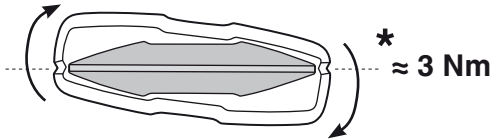
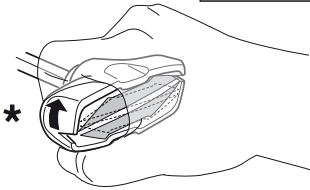
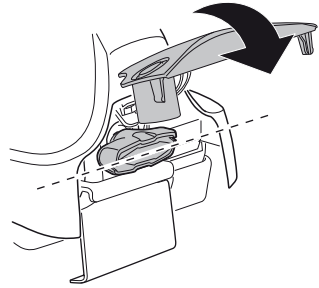
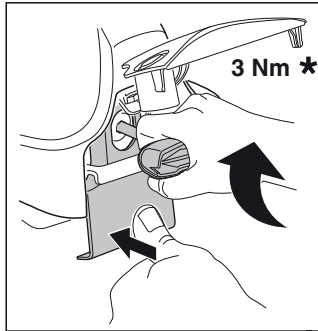

750

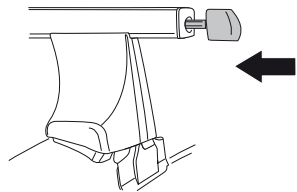
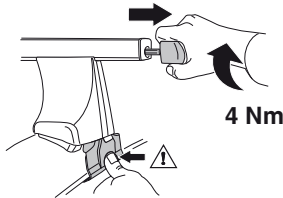

i



1



2

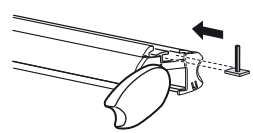

i

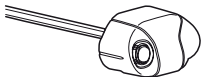

1

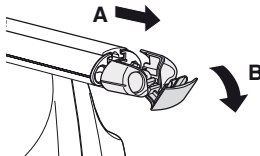

2

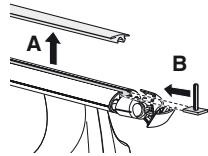

i



1

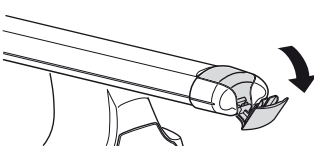



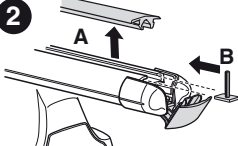

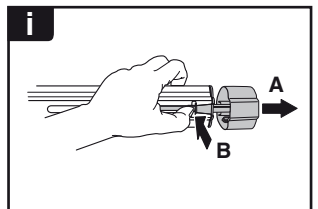
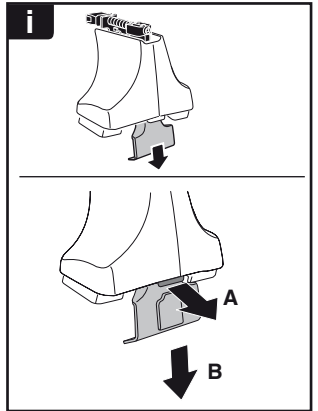
2





THULE
SWEDEN
**ONE
KEY
SYSTEM**



-  **544** (x4)
 -  **596** (x6)
 -  **588** (x8)
 -  **510** (x10)
 -  **452** (x12)
- NA
EUR
ASIA



WW ▶ Thule Sweden AB, Box 69, 330 33 Hillerstorp, SWEDEN
NA ▶ Thule Inc., 42 Silvermine Road, Seymour, Connecticut 06483, USA

info@thule.com
customer.service@thule.com

 www.thule.com