

# Kit 1198

KIA Rio (Mk I), 4-dr Sedan, 00-05 / \*01-05

KIA Rio (Mk I), 5-dr Hatchback, 00-05

KIA Rio Cinco, 5-dr Wagon, 02-05, 06-10

\*North America

480R  
754

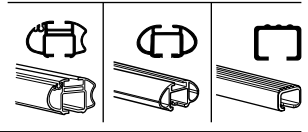
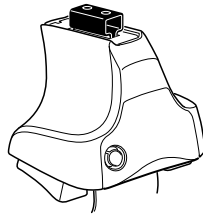

480

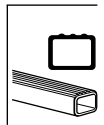
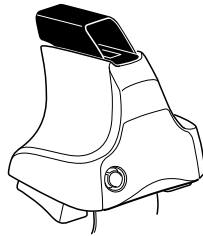

750

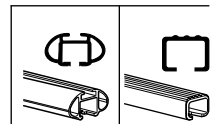
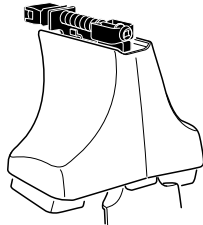

**Kit**



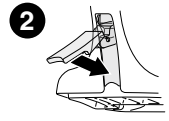
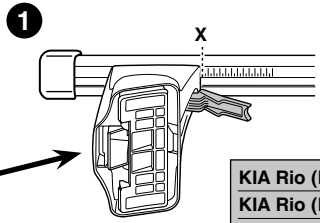
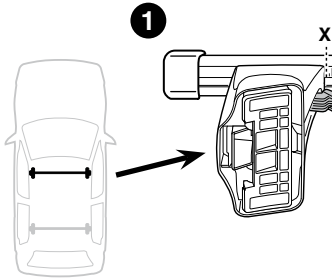

	X
<b>KIA Rio (Mk I), 4-dr Sedan, 00-05 / *01-05</b>	<b>29,5</b>
<b>KIA Rio (Mk I), 5-dr Hatchback, 00-05</b>	<b>29</b>
<b>KIA Rio Cinco, 5-dr Wagon, 02-05, 06-10</b>	<b>29</b>

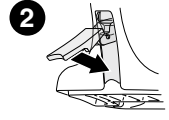
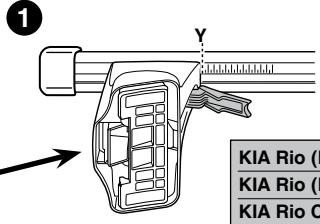

	Y
<b>KIA Rio (Mk I), 4-dr Sedan, 00-05 / *01-05</b>	<b>26</b>
<b>KIA Rio (Mk I), 5-dr Hatchback, 00-05</b>	<b>26</b>
<b>KIA Rio Cinco, 5-dr Wagon, 02-05, 06-10</b>	<b>26</b>

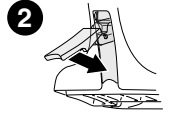
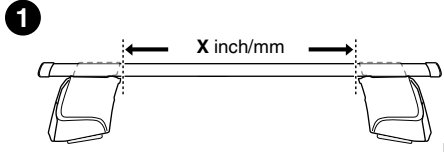
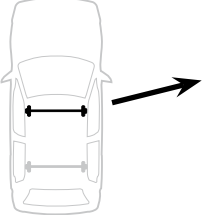
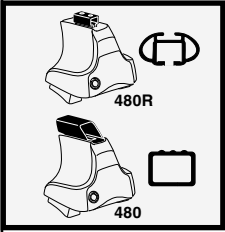

	X inch	X mm
<b>KIA Rio (Mk I), 4-dr Sedan, 00-05 / *01-05</b>	<b>37 1/4"</b>	<b>946 mm</b>
<b>KIA Rio (Mk I), 5-dr Hatchback, 00-05</b>	<b>37"</b>	<b>941 mm</b>
<b>KIA Rio Cinco, 5-dr Wagon, 02-05, 06-10</b>	<b>37"</b>	<b>941 mm</b>

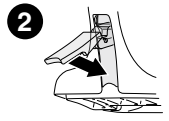
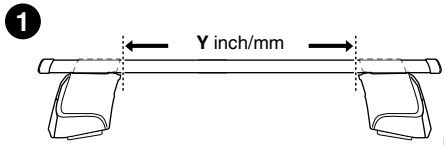
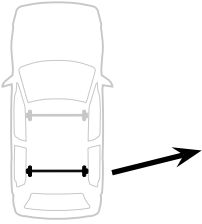

	Y inch	Y mm
<b>KIA Rio (Mk I), 4-dr Sedan, 00-05 / *01-05</b>	<b>35 7/8"</b>	<b>911 mm</b>
<b>KIA Rio (Mk I), 5-dr Hatchback, 00-05</b>	<b>35 7/8"</b>	<b>911 mm</b>
<b>KIA Rio Cinco, 5-dr Wagon, 02-05, 06-10</b>	<b>35 7/8"</b>	<b>911 mm</b>

# 4

KIA Rio (Mk I), 4-dr Sedan, 00-05 / \*01-05  
 KIA Rio (Mk I), 5-dr Hatchback, 00-05  
 KIA Rio Cinco, 5-dr Wagon, 02-05, 06-10

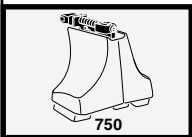
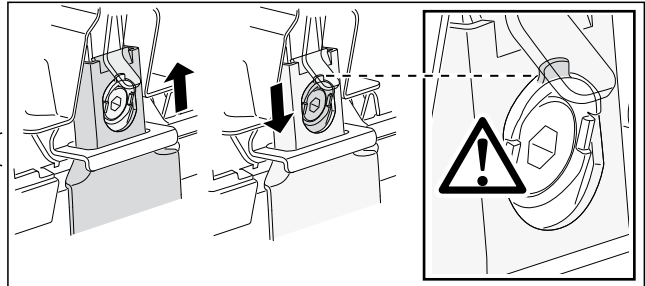
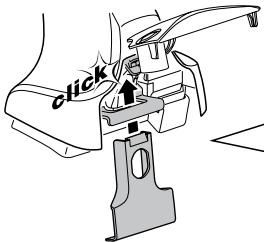
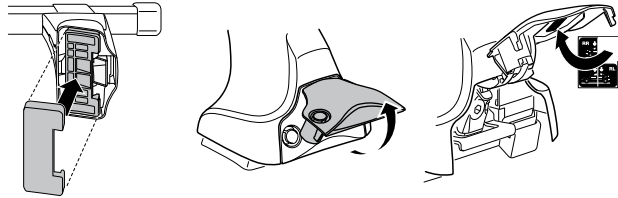
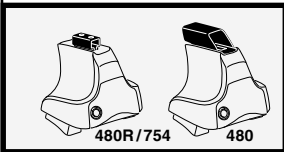
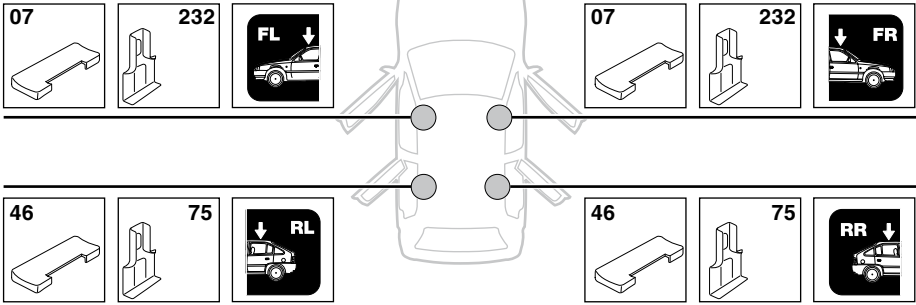

5



	X mm	Y mm	X inch	Y inch
KIA Rio (Mk I), 4-dr Sedan, 00-05 / *01-05	200 mm	615 mm	7 7/8"	24 1/4"
KIA Rio (Mk I), 5-dr Hatchback, 00-05	295 mm	700 mm	11 5/8"	27 1/2"
KIA Rio Cinco, 5-dr Wagon, 02-05, 06-10	295 mm	700 mm	11 5/8"	27 1/2"

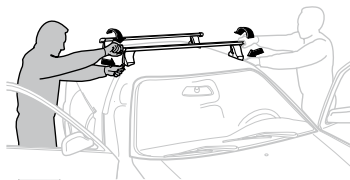
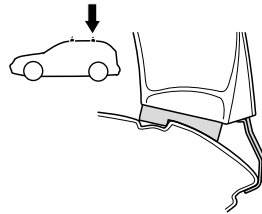
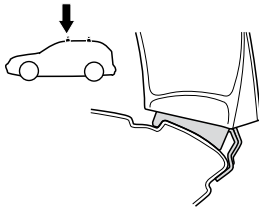
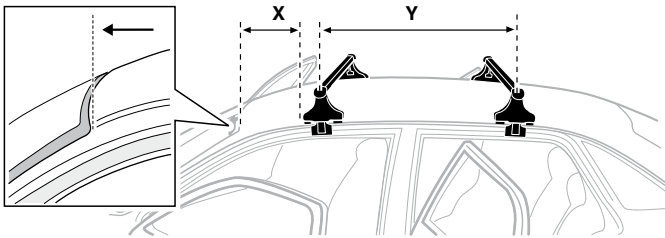

**GB/US** Tighten alternately

**D** Die Schrauben abwechselnd anziehen

**F** Serrer alternativement chaque côté

**NL** Afwisselend aan de linker- en de rechterkant aandraaien

**I** Alternare il serraggio delle viti

**E** Serrare alternativamente

**PT** Aperte alternadamente

**S** Dra åt växelvis

**FIN** Kierrä vuorotellen

**EST** Pinguldage vaheldumisi

**LAT** Pielvelciēt pamīšus

**LIT** Užsukinėkite pakaitomis

**PL** Śruby dokręcaj naprzemiennie

**RU** Затягивайте попеременно

**CZ** Pokręťta bagažníka dokręcaj dokręcaj naprzemiennie.

**SK** Doťahujte striedavo

**SLO** Privijajte izmenično.

**HR** Naizmjenično zategnite

**HU** Egymástól függetlenül szorítandó

**GR** Σφίγγετε εναλλάξ

**TR** Dönüşümlü sıkın

**中文** 交替拧紧

**한국어** 번갈아 가며 조이십시오.

**日本語** 交互に締め付けてください。

**ไทย** ชั้้นโน้แบบสลับ

6



480R/754



480



\*  
3 Nm



\*



\*  
≈ 3 Nm

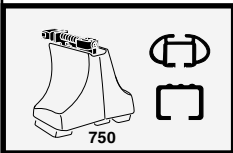
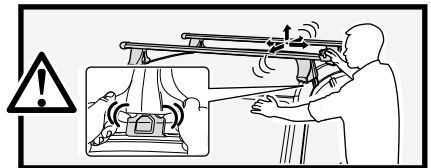

750

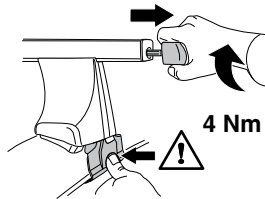

4 Nm

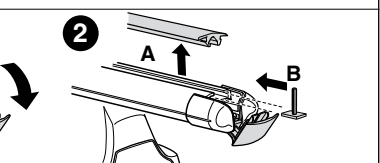
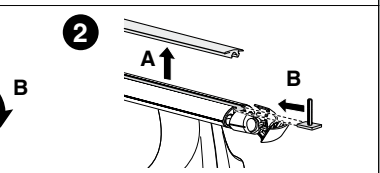
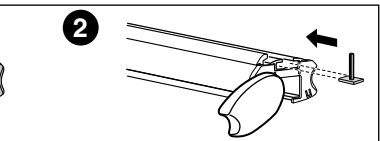
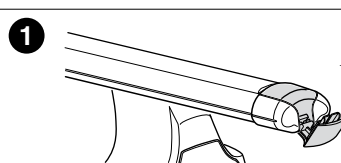
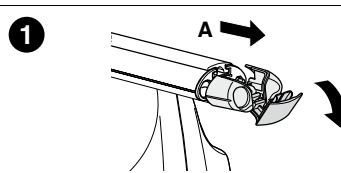
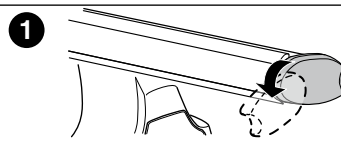
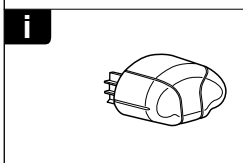
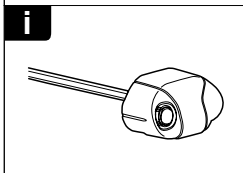
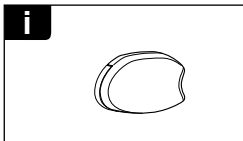
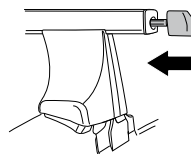



**THULE**  
SWEDEN  
**ONE  
KEY  
SYSTEM**



		(x4)
		(x6)
		(x8)
NA		(x10)
EUR		(x12)
ASIA		(x12)



WW ▶ Thule Sweden AB, Box 69, 330 33 Hillerstorp, SWEDEN  
NA ▶ Thule Inc., 42 Silvermine Road, Seymour, Connecticut 06483, USA

info@thule.com  
customer.service@thule.com

www.thule.com

503-1198-02