

Kit 1518

FORD Flex, 5-dr, *09–

*North America

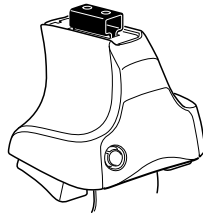

754 Rapid System
480R Rapid Traverse (North America)

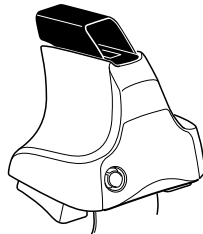

480 Traverse (North America)

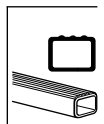

1



2



754 Rapid System
480R Rapid Traverse
(North America)

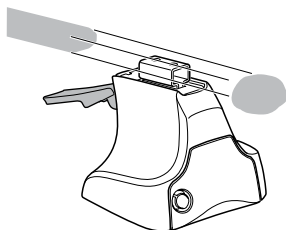

x4

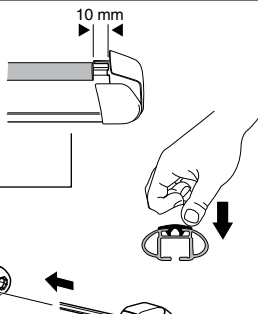

x4

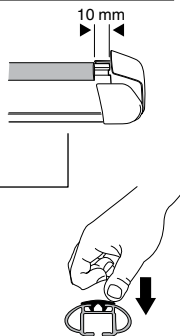
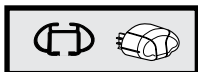

x4



480 Traverse
(North America)



x4

3**754** Rapid System

	X
FORD Flex, 5-dr, *09-	53

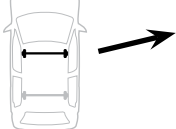

	Y
FORD Flex, 5-dr, *09-	53

3**480R** Rapid Traverse**480** Traverse**(North America)**

	X inch	X mm
FORD Flex, 5-dr, *09-	46 1/2"	1180 mm

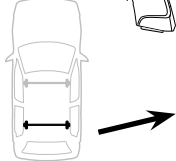

	Y inch	Y mm
FORD Flex, 5-dr, *09-	46 1/2"	1180 mm

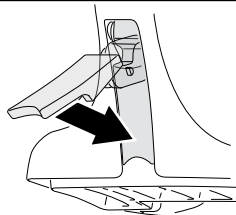
4

5

FORD Flex, 5-dr, *09-

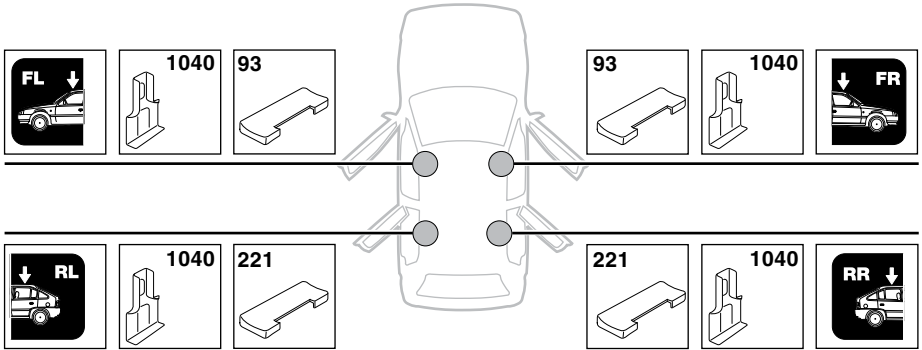

6

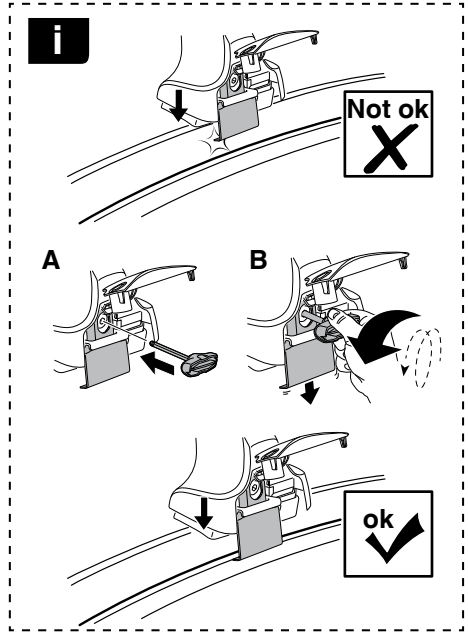

FORD Flex, 5-dr, *09-

X mm Y mm X inch Y inch

530 mm

760 mm

20 ⁷/₈ "

30 "

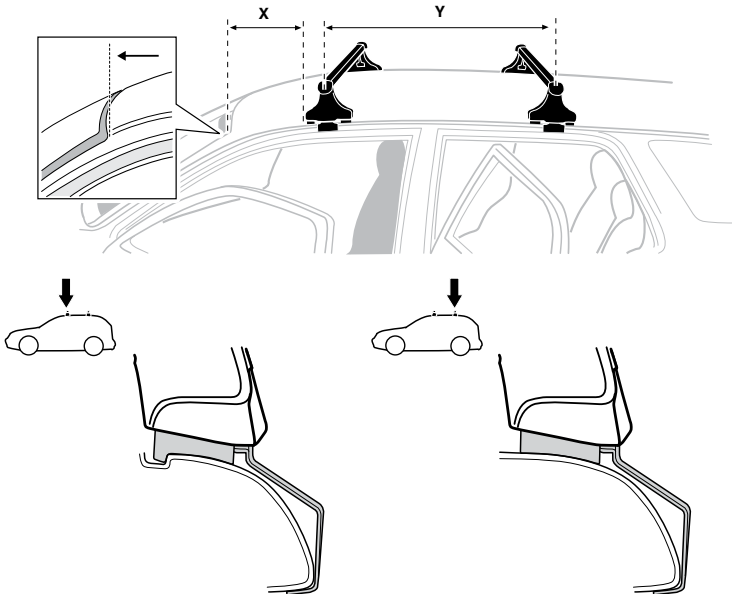

7



GB/US Tighten alternately
D Die Schrauben abwechselnd anziehen
F Serrer alternativement chaque côté
NL Afwisselend aan de linker- en de rechterkant aandraaien
I Alternare il serraggio delle viti
E Apertar alternativamente
PT Aperte alternadamente
S Dra åt växelvis
FIN Kierrä vuorotellen
EST Pinguldage vaheldumisi
LAT Pieļieciet pamišus
LIT Užsukinėkite pakaitomis
PL Śruby dokręcaj naprzemiennie
RU Затягивайте попеременно

CZ Pokręťta bagażnika dokręcaj dokręcaj naprzemiennie.
SK Dofahajte striedavo
SLO Privijajte izmenično.
HR Naizmjerno zategnite
HU Egymástól függetlenül szorítandó
GR Σφιγίγτες εναλλάξ
TR Dönüşümlü sıkın

中文 交替拧紧

한국어 번갈아 가며 조이십시오.

日本語 交互に締め付けてください。

ไทย ชันในแบบสลับ

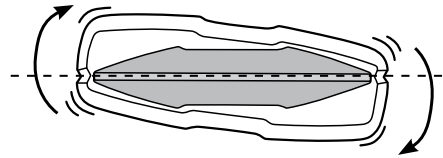
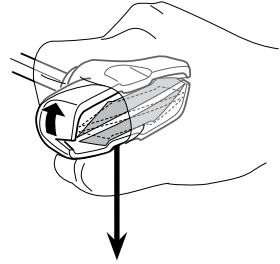
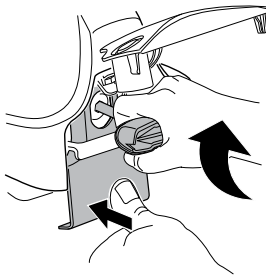
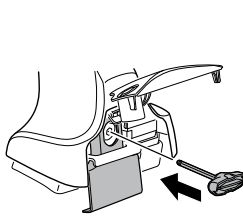

≈ 3 Nm

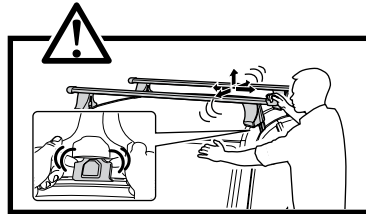
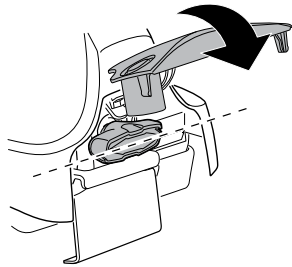

8



x1
17 mm

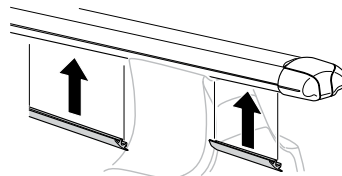
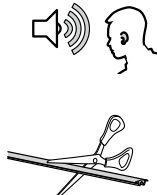

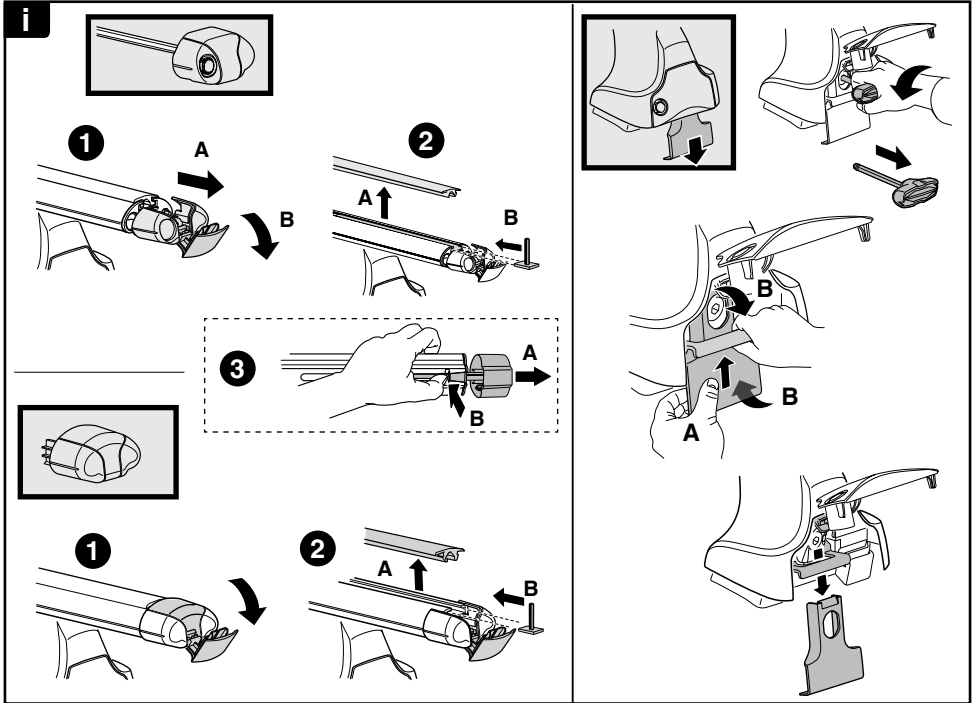

THULE
SWEDEN
**ONE
KEY
SYSTEM**

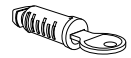
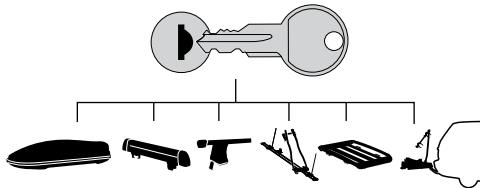

- 544** (x4)
- 596** (x6)
- 588** (x8)
- NA **510** (x10)
- EUR **452** (x12)
- ASIA

