

Kit 1533

FORD Taurus, 4-dr Sedan, 08-09

MERCURY Sable, 4-dr Sedan, 08-09

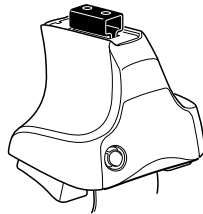

754 Rapid System
480R Rapid Traverse (North America)

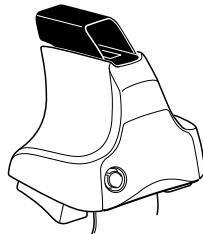
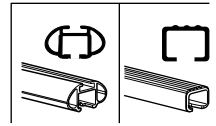

480 Traverse (North America)

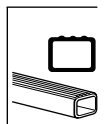

- 754 Rapid System: x1 (box), x4 (cubes), x4 (754 Rapid Traverse (North America) units), x4 (screws)
- 480R Rapid Traverse (North America): x1 (ruler), x4 (480R Rapid Traverse (North America) units), x4 (screws), x4 (cubes)
- 480 Traverse (North America): x1 (ruler), x4 (480 Traverse (North America) units), x4 (screws), x4 (cubes)

- 23 mm components: x2 (bracket), x2 (rod), x2 (rod), x4 (nut), x4 (washer)
- 17 mm components: x1 (rod), x2 (rod), x2 (rod), x4 (nut), x4 (washer)
- (North America) components: x2 (rod), x2 (rod), x2 (rod), x2 (rod), x2 (rod)

- 100 x4 (bracket)
- 93 x4 (bracket)
- Diagram with labels: RR, FR, FL, RL, x1

1

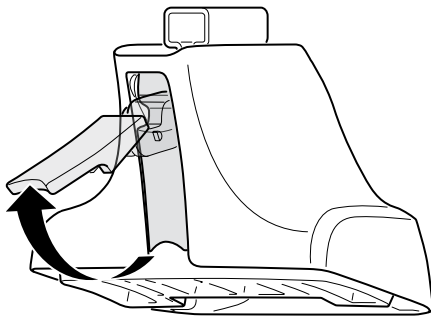

2



754 Rapid System
480R Rapid Traverse
(North America)

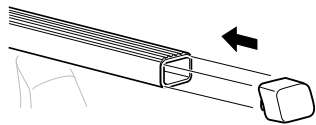
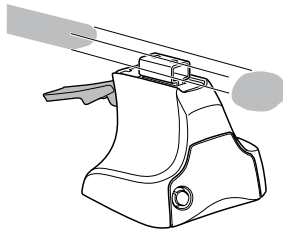

x4

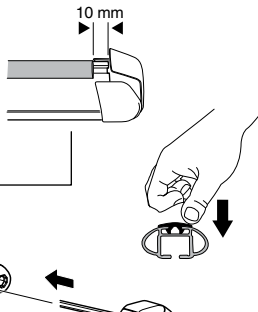
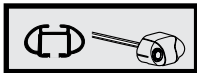

x4

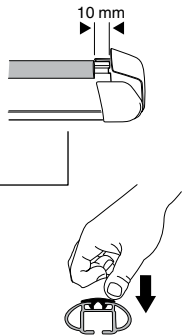
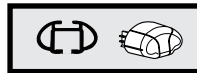

x4



480 Traverse
(North America)

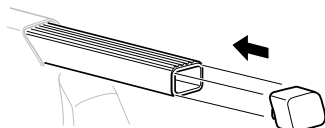
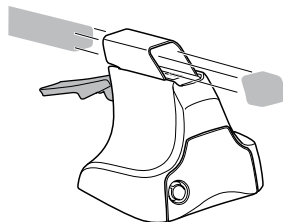

x4

3

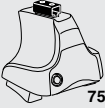

754 Rapid System

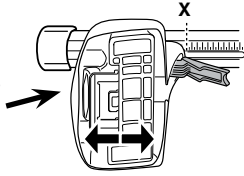

	X
FORD Taurus , 4-dr Sedan, 08-09	48
MERCURY Sable , 4-dr Sedan, 08-09	48

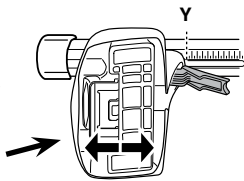

	Y
FORD Taurus , 4-dr Sedan, 08-09	44
MERCURY Sable , 4-dr Sedan, 08-09	44

3



480R Rapid Traverse



480 Traverse

(North America)

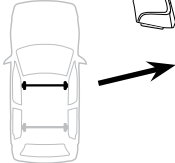

	X inch	X mm
FORD Taurus , 4-dr Sedan, 08-09	44 1/2"	1131 mm
MERCURY Sable , 4-dr Sedan, 08-09	44 1/2"	1131 mm

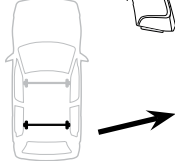

	Y inch	Y mm
FORD Taurus , 4-dr Sedan, 08-09	43"	1091 mm
MERCURY Sable , 4-dr Sedan, 08-09	43"	1091 mm

4

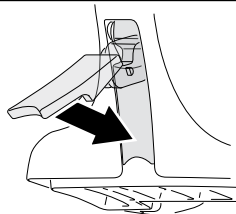

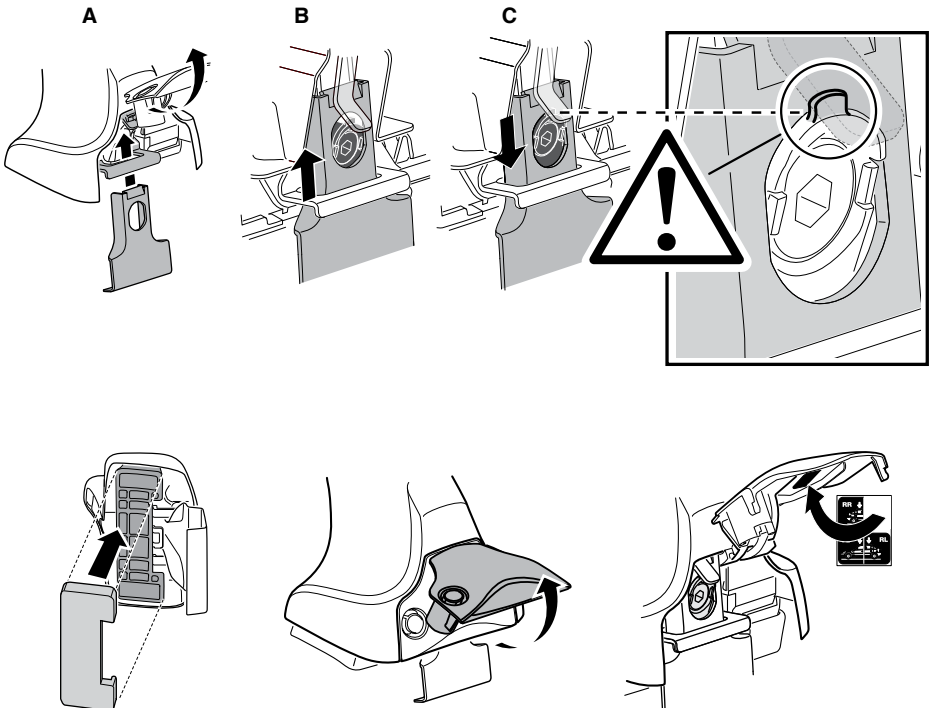
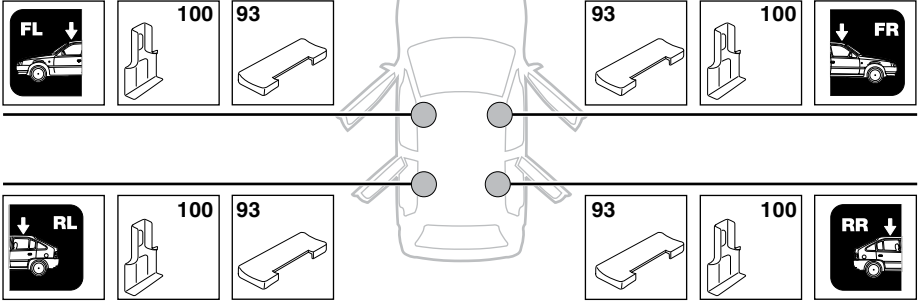
5**FORD Taurus, 4-dr Sedan, 08-09**
MERCURY Sable, 4-dr Sedan, 08-09

6

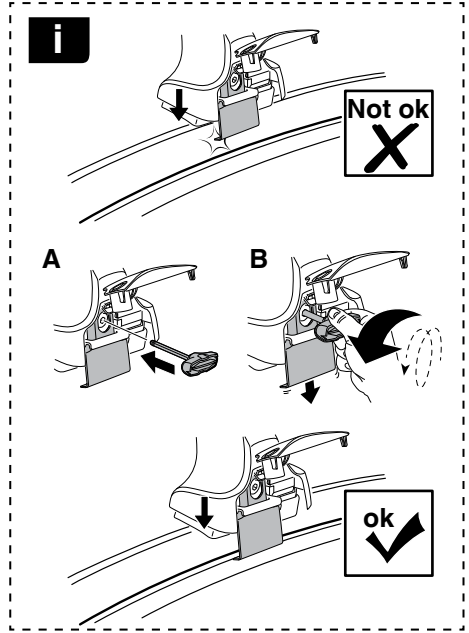
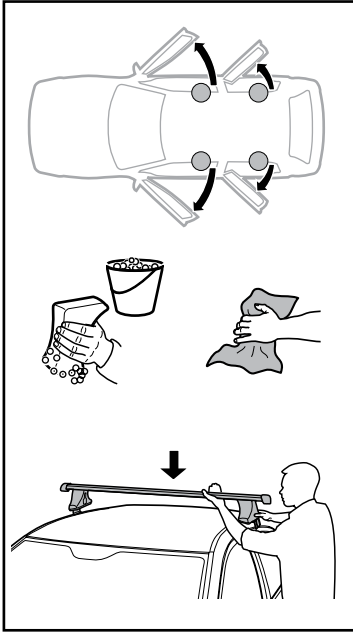

	X mm	Y mm	X inch	Y inch
FORD Taurus, 4-dr Sedan, 08-09	250 mm	685 mm	9 3/4"	27"
MERCURY Sable, 4-dr Sedan, 08-09	250 mm	685 mm	9 3/4"	27"

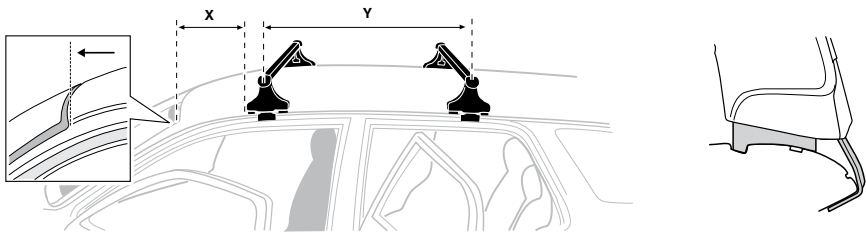

7

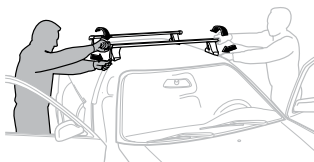

GB/US	Tighten alternately
D	Die Schrauben abwechselnd anziehen
F	Serrer alternativement chaque côté
NL	Afwisselend aan de linker- en de rechterkant aandraaien
I	Alternare il serraggio delle viti
E	Apertar alternativamente
PT	Aperte alternadamente
S	Dra åt växelvis
FIN	Kierrä vuorotellen
EST	Pinguldage vaheldumisi
LAT	Pielveiciet pamišus
LIT	Užsukinėkite pakaitomis
PL	Śruby dokręcaj naprzemiennie
RU	Загряивайте попеременно

CZ	Pokręřta bagažníka dokręřcaj dokręřcaj naprzemiennie.
SK	Dofahajte striedavo
SLO	Privijajte izmenično.
HR	Naizmjenično zategnite
HU	Egymástól függetlenül szorítandó
GR	Σφιγίγτες εναλλάξ
TR	Dönüşümlü sıkın

中文 交替拧紧

한국어 번갈아 가며 조이십시오.

日本語 交互に締め付けてください。

ไทย ชันในแบบสลับ

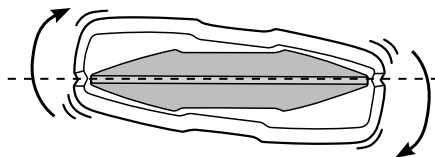
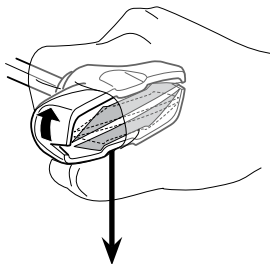
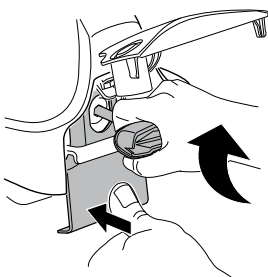
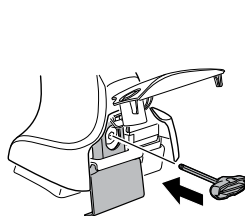

≈ 3 Nm

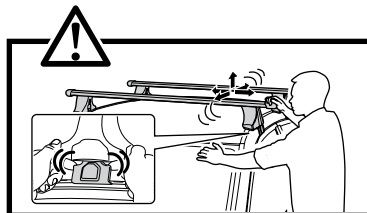
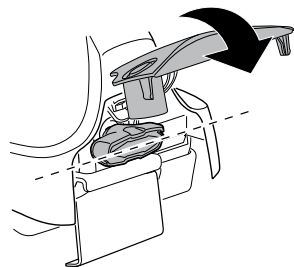

8

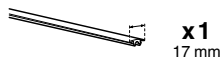

x1
17 mm

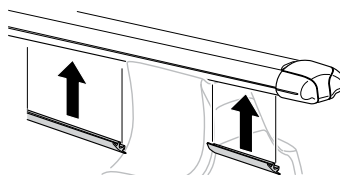

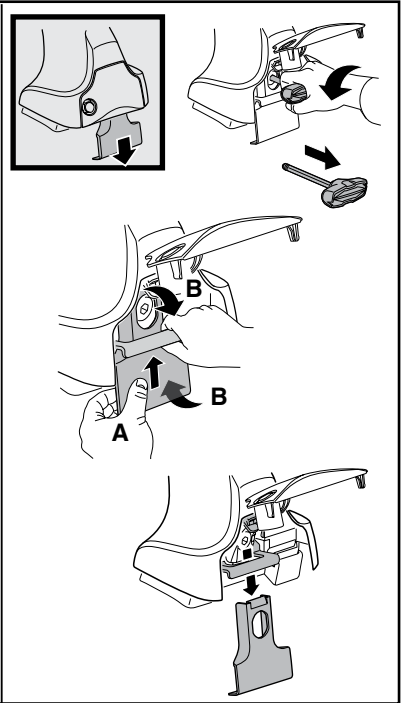
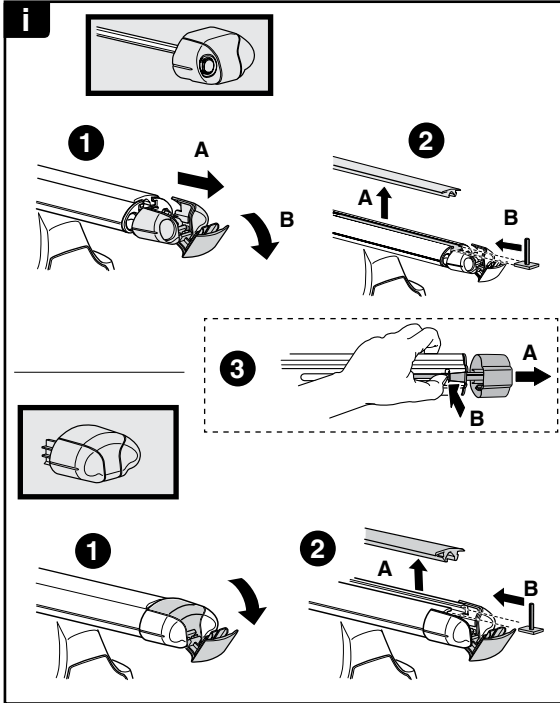
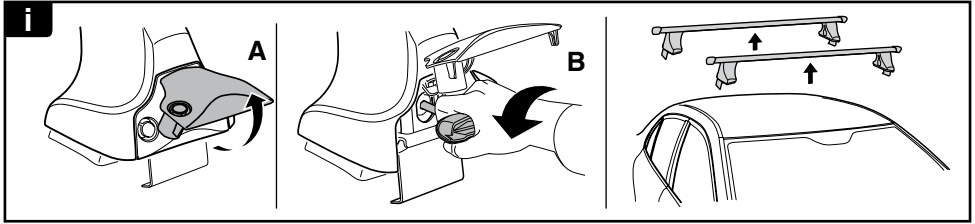

THULE
SWEDEN
**ONE
KEY
SYSTEM**

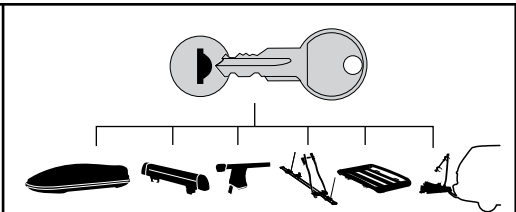

- 544 (x4)
 - 596 (x6)
 - 588 (x8)
 - 510 (x10)
 - 452 (x12)
- NA
EUR
ASIA

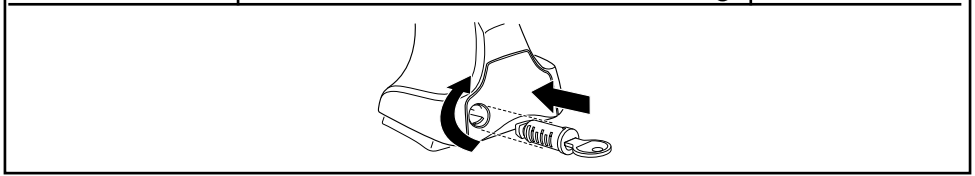

WW ▶ Thule Sweden AB, Box 69, 330 33 Hillerstorp, SWEDEN
NA ▶ Thule Inc., 42 Silvermine Road, Seymour, Connecticut 06483, USA

info@thule.com
customer.service@thule.com

www.thule.com